

Product datasheet

Specifications



Basic HMI Gateway Box STM6 for Faceless HMI application

HMISTM6BOX

EAN Code: 3606481856432

Main

| | |
|---------------------------|---|
| Range of product | Harmony STM6 |
| Product or component type | Modular HMI box |
| Operating system | Linux |
| Processor name | ARM Cortex-A8 |
| Processor frequency | 800 MHz |
| Data storage equipment | 1 GB Flash disk NAND |
| Memory description | 512 KB backup memory 512 MB internal 1 GB flash |

Complementary

| | |
|----------------------------|---|
| [Us] rated supply voltage | 24 V DC power supply |
| Local signalling | LED multi-colour for status |
| Port Ethernet | 10BASE-T/100BASE-T |
| Integrated connection type | 2 Ethernet TCP/IP - RJ45 COM1 serial link - SUB-D 9 - RS232C/RS422/RS485 (rate: 2400...115200 bps) USB 2.0 port - micro B USB display port - RJ45 1 USB 2.0 port - USB type A |
| Type of cooling | Natural convection |
| Realtime clock | Built-in |
| Height | 101 mm |
| Width | 150.5 mm |
| Depth | 63.3 mm |
| Net weight | 0.456 kg |

Environment

| | |
|-----------|--|
| Standards | CSA C22.2 No 142 ANSI/ISA 12-12-01 UL 508 CSA C22.2 No 213 IEC 61132-2 |
|-----------|--|

Disclaimer: This documentation is not intended as a substitute for and is not to be used for determining suitability or reliability of these products for specific user applications

| | |
|--|---|
| Product certifications | CE UKCA cULus RCM KC cULus Class 1 Division 2 DNV ABS RINA BV |
| Pollution degree | 2 conforming to IEC 61131-2 ed.3 |
| Ambient air temperature for operation | 0...60 °C |
| Ambient air temperature for storage | -20...60 °C |
| Relative humidity | 10...90 % non-condensing |
| Operating altitude | 2000 |
| Shock resistance | 147 m/s ² conforming to IEC 61131-2 |
| Vibration resistance | 3.5 mm constant amplitude (f = 5...9 Hz) conforming to IEC 61131-2 9.8 m/s ² (f = 9...150 Hz) conforming to IEC 61131-2 |
| Electromagnetic compatibility | Electrostatic discharge immunity test conforming to IEC 61000-4-2 level 3 |

Packing Units

| | |
|-------------------------------------|----------|
| Unit Type of Package 1 | PCE |
| Number of Units in Package 1 | 1 |
| Package 1 Height | 9.0 cm |
| Package 1 Width | 17.6 cm |
| Package 1 Length | 26.5 cm |
| Package 1 Weight | 675.0 g |
| Unit Type of Package 2 | S03 |
| Number of Units in Package 2 | 6 |
| Package 2 Height | 30 cm |
| Package 2 Width | 30 cm |
| Package 2 Length | 40 cm |
| Package 2 Weight | 4.895 kg |

Logistical informations

| | |
|--------------------------|----|
| Country of origin | ID |
|--------------------------|----|

Contractual warranty

| | |
|-----------------|-----------|
| Warranty | 18 months |
|-----------------|-----------|

Environmental Data

Schneider Electric aims to achieve Net Zero status by 2050 through supply chain partnerships, lower impact materials, and circularity via our ongoing “Use Better, Use Longer, Use Again” campaign to extend product lifetimes and recyclability.

[Environmental Data explained >](#)

[How we assess product sustainability >](#)

Environmental footprint

Total lifecycle Carbon footprint 279

Environmental Disclosure [Product Environmental Profile](#)

Use Better

Materials and Substances

F-gas free Only air and vacuum used for insulation / breaking, no F-gas including SF6

Packaging made with recycled cardboard Yes

Packaging without single use plastic No

[EU RoHS Directive](#) Pro-active compliance (Product out of EU RoHS legal scope)

SCIP Number 715da6e9-302b-4bd3-a8b4-7f8cdd474a0e

REACH Regulation [REACH Declaration](#)

Halogen-free status Product contains halogen above thresholds

PVC free No

Silicone-free No

Use Again

Repack and remanufacture

End of life manual availability [End of Life Information](#)

Removable battery User replaceable

Take-back No

WEEE Label  The product must be disposed on European Union markets following specific waste collection and never end up in rubbish bins

Dimensions Drawings

Dimensions

External dimensions

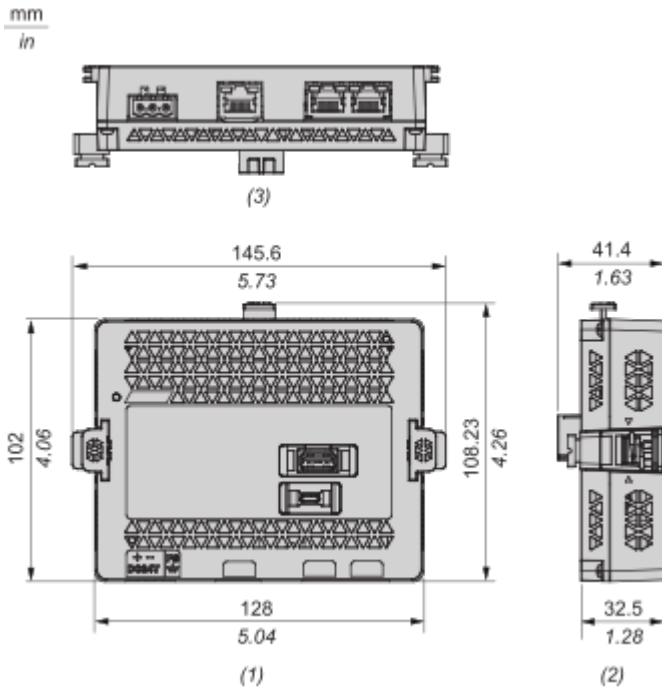

- (1) : Front
- (2) : Right
- (3) : Bottom

Dimension with installation adapter

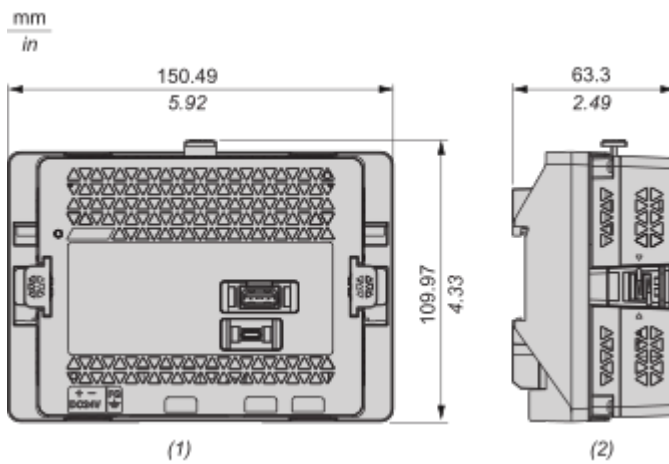

- (1) : Front
- (2) : Right

Dimension with separation cable

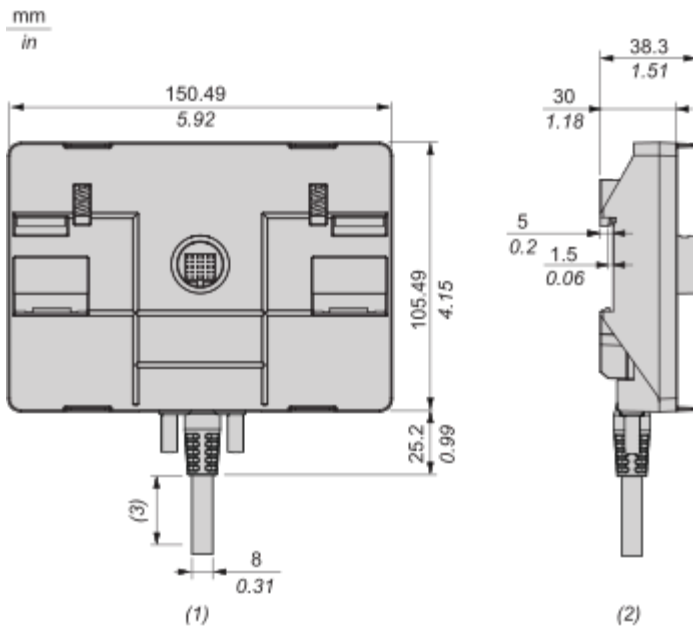

(1) : Front

(2) : Right

(3) : To assemble this product, 20 mm (0.78 in) or more space required to bend the rubber portion at the end of the cable.

Technical Illustration

Dimensions

mm
in

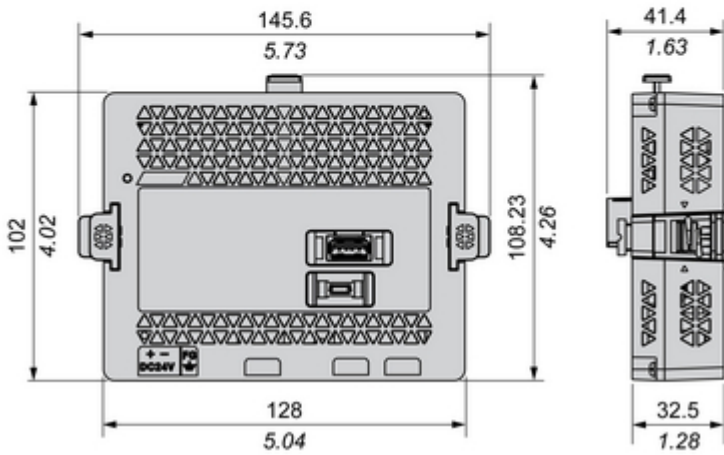
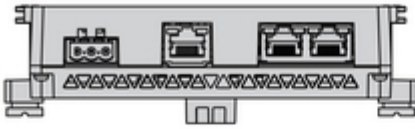

Offer Marketing Illustration

Product benefits / Features

Technical Benefits

Harmony ST6 Basic Modular HMI (BOX)

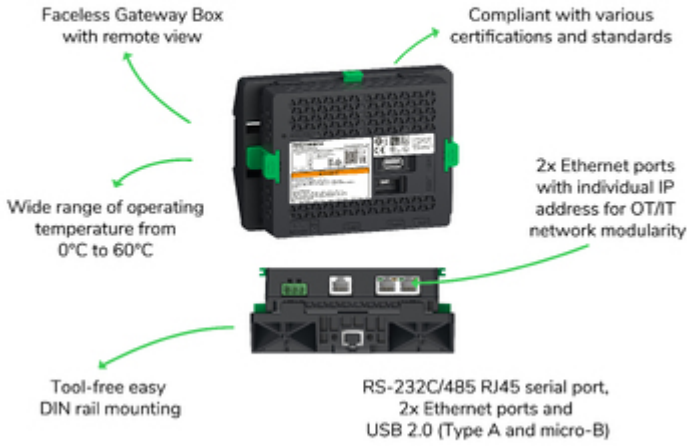

Offer Marketing Illustration

Product benefits / Features

Features

Harmony ST6 Basic Modular HMI (BOX)



Efficient data collection



Enable on-demand HMI with tablet or smartphone



Affordable access points for remote maintenance



Cybersecurity enhancement with secure boot and encrypted transfer



User-friendly protocols allowing you to easily connect your OT devices to IT with OPC-UA



Create highly responsive screens with ease by configuration software "EcoStruxure™ Operator Terminal Expert"



Image of product / Alternate images

Alternative

