

Product datasheet

Specifications

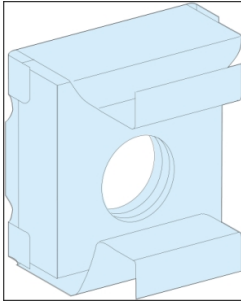

20 HEXA.SPACER M6 CAPTIVE NUTS

LVS03194

EAN Code: 3606481869357

Main

Range	PrismaSeT
Range of product	PrismaSeT P PrismaSeT G
Product or component type	Captive nuts
Accessory / separate part category	Installation accessory
Range compatibility	PrismaSeT PrismaSeT P cubicle PrismaSeT PrismaSeT G mounting plate

Complementary

Mounting mode	By clips
Mounting support	Slotted mounting plate Functional uprights
installation description	Floor-standing enclosure - width 600 mm Wall-mounted enclosure - width 600 mm Floor-standing duct - width 300 mm Wall-mounted duct - width 300 mm Cubicle Cubicle duct
ISO thread	M6
Quantity per set	Set of 20
Colour	Natural
Net weight	0.08 kg

Packing Units

Unit Type of Package 1	PCE
Number of Units in Package 1	1
Package 1 Height	2.000 cm
Package 1 Width	4.000 cm
Package 1 Length	6.000 cm
Package 1 Weight	77.000 g
Unit Type of Package 2	S02
Number of Units in Package 2	50
Package 2 Height	15.000 cm
Package 2 Width	30.000 cm
Package 2 Length	40.000 cm

Package 2 Weight 4.071 kg

Logistical informations

Country of origin FR

Contractual warranty

Warranty 18 months

Environmental Data

Schneider Electric aims to achieve Net Zero status by 2050 through supply chain partnerships, lower impact materials, and circularity via our ongoing “Use Better, Use Longer, Use Again” campaign to extend product lifetimes and recyclability.

[Environmental Data explained >](#)

[How we assess product sustainability >](#)

Environmental footprint

[Environmental Disclosure](#)

[Product Environmental Profile](#)

Use Better

Materials and Substances

Packaging made with recycled cardboard

Yes

Packaging without single use plastic

No

[EU RoHS Directive](#)

Compliant

REACH Regulation

[REACH Declaration](#)

Halogen-free status

Halogen free plastic parts product

PVC free

Yes

Silicone-free

Yes

Use Again

Repack and remanufacture

End of life manual availability

No need of specific recycling operations

Take-back

No