

Product datasheet

Specifications



Harmony XB5, Illuminated emergency stop, plastic, red mushroom Ø40, Ø22, trigger latching turn to release, 24 V DC, 1 NO + 2 NC,

Local distributor code:

409063499

XB5AS86449B4

! Discontinued

! Discontinued on: 20 Nov 2023

EAN Code: 3606481205452

Main

| | |
|-------------------------------|---|
| Range of product | Harmony XB5 |
| Product or component type | Illuminated emergency stop push-button |
| Device short name | XB5 |
| Bezel material | Plastic |
| Fixing collar material | Plastic |
| Head type | Standard |
| Mounting diameter | 22 mm |
| Sale per indivisible quantity | 1 |
| Local signalling | 1 red LED 24 V DC, current consumption: 7.5 mA |
| Light source | LED |
| [Us] rated supply voltage | 21.6...26.4 V |
| Light source colour | Red |
| Service life in hours | 30000 h at 25 °C |
| Shape of signaling unit head | Round |
| Type of operator | trigger action and mechanical latching with mechanical state indicator |
| Reset | Turn to release |
| Operator profile | Red mushroom Ø 40 mm, unmarked |
| Contact operation | Slow-break |
| Connections - terminals | Screw clamp terminals, <= 1.25 mm ² with cable end conforming to IEC 60947-1 Screw clamp terminals, <= 1.25 mm ² without cable end conforming to IEC 60947-1 |
| Device presentation | Complete product |

Complementary

| | |
|---------------------------|------------------|
| [Us] rated supply voltage | 24 V DC at 50 Hz |
| Supply voltage limits | 21.6...26.4 V DC |
| Height | 42 mm |
| Width | 42 mm |
| Depth | 79.5 mm |

| | |
|--|---|
| Terminals description ISO n°1 | (21-22)NC (11-12)NC (13-14)NO |
| Net weight | 0.094 kg |
| Contacts usage | Monitoring contact |
| Positive opening | With conforming to IEC 60947-5-1 appendix K |
| Mechanical durability | 100000 cycles |
| Tightening torque | 0.8...1.5 N.m conforming to IEC 60947-1 |
| Shape of screw head | Slotted compatible with flat Ø 5.5 mm screwdriver Cross compatible with JIS No 2 screwdriver Cross compatible with Philips No 2 screwdriver |
| Contacts material | Silver alloy - gold plated (Ag/Cu) |
| Short-circuit protection | 10 A cartridge fuse type gG conforming to IEC 60947-5 |
| [Ith] conventional free air thermal current | 5 A conforming to IEC 60947-5-1 |
| [Uij] rated insulation voltage | 250 V (pollution degree 2) conforming to IEC 61140 |
| [Uimp] rated impulse withstand voltage | 2.5 kV conforming to IEC 60947-1 |
| [Ie] rated operational current | 1.5 A at 240 V, AC-15, B300 conforming to IEC 60947-5-1 3 A at 120 V, AC-15, B300 conforming to IEC 60947-5-1 0.1 A at 250 V, DC-13, R300 conforming to IEC 60947-5-1 0.22 A at 125 V, DC-13, R300 conforming to IEC 60947-5-1 |
| Electrical durability | 100000 cycles, AC-15, 1.5 A at 240 V, operating rate <1800 cyc/h, load factor: 0.4 conforming to IEC 60947-5-1 appendix C 100000 cycles, AC-15, 3 A at 120 V, operating rate <1800 cyc/h, load factor: 0.4 conforming to IEC 60947-5-1 appendix C 100000 cycles, DC-13, 0.1 A at 250 V, operating rate <1800 cyc/h, load factor: 0.4 conforming to IEC 60947-5-1 appendix C 100000 cycles, DC-13, 0.22 A at 125 V, operating rate <1800 cyc/h, load factor: 0.4 conforming to IEC 60947-5-1 appendix C |

Environment

| | |
|--|--|
| Ambient air temperature for storage | -40...80 °C |
| Ambient air temperature for operation | -20...50 °C |
| Overvoltage category | Class II conforming to IEC 61140 |
| IP degree of protection | IP65 (front face) conforming to IEC 60529 IP2X (back face) |
| Standards | IEC 60947-1 IEC 60947-5-1 CSA C22.2 No 14 IEC 60947-5-5 IEC 60204-1 ISO 13850 JIS C8201-5-1 UL 508 JIS C8201-1 |
| Product certifications | UL listed CSA |
| Vibration resistance | 50 m/s ² (f= 10...500 Hz) conforming to IEC 60068-2-6 |
| Shock resistance | 150 m/s ² (duration = 11 ms) for half sine wave acceleration conforming to IEC 60068-2-27 |

Packing Units

| | |
|-------------------------------------|-----|
| Unit Type of Package 1 | PCE |
| Number of Units in Package 1 | 1 |

| | |
|-------------------------------------|----------|
| Package 1 Height | 4.699 cm |
| Package 1 Width | 8.306 cm |
| Package 1 Length | 8.999 cm |
| Package 1 Weight | 150.0 g |
| Unit Type of Package 2 | S01 |
| Number of Units in Package 2 | 12 |
| Package 2 Height | 15.0 cm |
| Package 2 Width | 15.0 cm |
| Package 2 Length | 40.0 cm |
| Package 2 Weight | 1.784 kg |

Contractual warranty

| | |
|-----------------|-----------|
| Warranty | 18 months |
|-----------------|-----------|

Environmental Data

Schneider Electric aims to achieve Net Zero status by 2050 through supply chain partnerships, lower impact materials, and circularity via our ongoing “Use Better, Use Longer, Use Again” campaign to extend product lifetimes and recyclability.

[Environmental Data explained >](#)

[How we assess product sustainability >](#)

Environmental footprint

[Environmental Disclosure](#)

[Product Environmental Profile](#)

Use Better

Materials and Substances

Packaging made with recycled cardboard

Yes

Packaging without single use plastic

No

[EU RoHS Directive](#)

Pro-active compliance (Product out of EU RoHS legal scope)

Use Longer

Lifetime extension

Product repair index

A

Use Again

Repack and remanufacture

End of life manual availability

[End of Life Information](#)

Dimensions Drawings

Dimensions

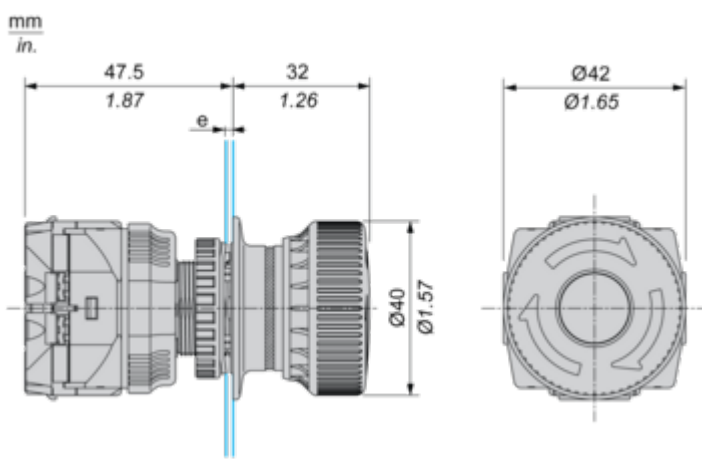

(e) Clamping thickness: 1 mm to 6 mm / 0.03 in to 0.24 in

Mounting and Clearance

Panel Cut-out for Emergency Stop Push Button (Finished Holes, Ready for Installation)

Connection by Screw Clamp Terminals

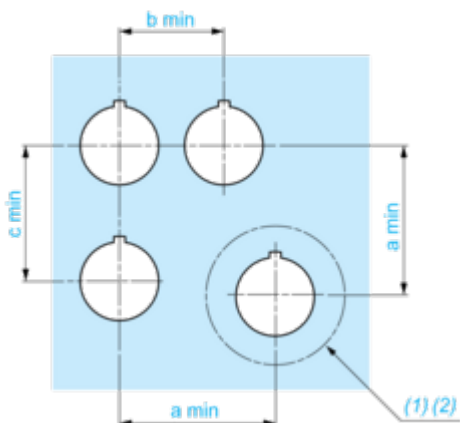

- (1) Diameter on finished panel or support
- (2) Ø42 mm recommended / Ø1.65 in. recommended (Head diameter)

| Connections | a in mm | a in in. | b in mm | b in in. | c in mm | c in in. |
|--------------------|---------|----------|---------|----------|---------|----------|
| By screw terminals | 45 | 1.77 | 30 | 1.18 | 40 | 1.57 |

Connection by Screw Clamp Terminals

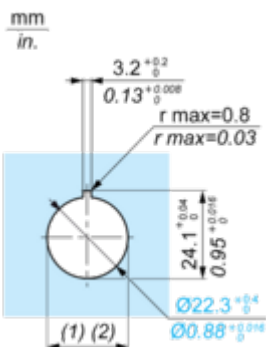

- (1) Diameter on finished panel or support
- (2) Ø22.5 mm recommended (Ø22.3 0+0.4) / Ø0.89 in. recommended (Ø0.88 in. 0+0.016)

Offer Marketing Illustration

Product benefits / Features

Features

Harmony XB5 e-stop function



 Wide modular range to suit machines and operator safety.

 Ergonomic design for emergency actuation in several environments

 Designed to fit in a standard 22mm cut-out or Harmony XALK control station ensuring compatibility with pre-existing machinery

 Illuminated types to improve operator efficiency by reducing production downtime.

 Large set of accessories: circular legends, illuminated legend rings, protective bellows for harsh environments and protective guards.

Offer Marketing Illustration

Product benefits / Features

Technical Benefits

Harmony XB5 e-stop function

Fit to several customer functions needs: turn to release, push to release, key release

Guarantee of proper installation thanks to NC contact with monitoring function.



Designed as per international standards for high performance.

Fit for all machine sizes and environments:

- Small machines > 30 mm
- Standard machines > 40 mm
- Use of gloves > 60 mm

Image of product / Alternate images

Alternative

