

Product datasheet

Specifications



Illuminated beacon without buzzer, orange, Ø100, integral LED, 48 V DC

Local distributor code:
403036600

XVR3E05

EAN Code: 3606480611940

Main

Range of product	Harmony XVR
Product or component type	Beacon
Device short name	XVR3
Beacon or indicator bank unit type	LED unit
Mounting diameter	100 mm
Light source	LED, orange
Device application	Forklift Automated guided vehicle (AGV) Bulldozer

Complementary

Signalling type	Flashing Blinking Rotating
Assembly style	Ready assembled
Material	PC (polycarbonate): lenses PBT (polybutylene terephthalate) + PC (polycarbonate): body EPDM (ethylene propylene diene monomer): base
[Us] rated supply voltage	48 V DC
[Ue] rated operational voltage	35...60 V DC
Inrush current	1 A
Power consumption in W	3 W
Marking	CE
Installation direction	Upright indoor Sideways indoor Inverted indoor Upright outdoor
Electrical insulation class	Class II
Current consumption	1000 mA
Length	100 mm
Width	100 mm
Height	139 mm
Net weight	0.484 kg

Environment

Product certifications	CCC
------------------------	-----

Ambient air temperature for operation	-20...50 °C
Ambient air temperature for storage	-35...70 °C
Relative humidity	35...85 % without condensation
Vibration resistance	4.6 gn (sideways) 4.6 gn (inverted) 7.1 gn (upright)
IP degree of protection	IP65 (upright) IP23 (sideways) IP23 (inverted)

Packing Units

Unit Type of Package 1	PCE
Number of Units in Package 1	1
Package 1 Height	18.200 cm
Package 1 Width	13.500 cm
Package 1 Length	13.600 cm
Package 1 Weight	642.000 g
Unit Type of Package 2	S04
Number of Units in Package 2	8
Package 2 Height	30.000 cm
Package 2 Width	40.000 cm
Package 2 Length	60.000 cm
Package 2 Weight	6.150 kg

Logistical informations

Country of origin	CN
--------------------------	----

Contractual warranty

Warranty	18 months
-----------------	-----------

Environmental Data

Schneider Electric aims to achieve Net Zero status by 2050 through supply chain partnerships, lower impact materials, and circularity via our ongoing “Use Better, Use Longer, Use Again” campaign to extend product lifetimes and recyclability.

[Environmental Data explained >](#)

[How we assess product sustainability >](#)

Environmental footprint

Total lifecycle Carbon footprint 53

Environmental Disclosure [Product Environmental Profile](#)

Use Better

Materials and Substances

Packaging made with recycled cardboard Yes

Packaging without single use plastic Yes

[EU RoHS Directive](#) Pro-active compliance (Product out of EU RoHS legal scope)

REACH Regulation [REACH Declaration](#)

Use Again

Repack and remanufacture

End of life manual availability [End of Life Information](#)

Take-back No

Dimensions Drawings

Dimensions

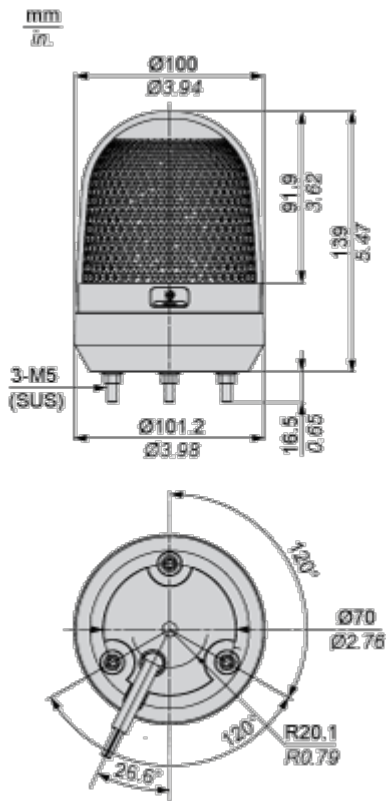

Mounting and Clearance

Panel Cut-out

Straight wiring

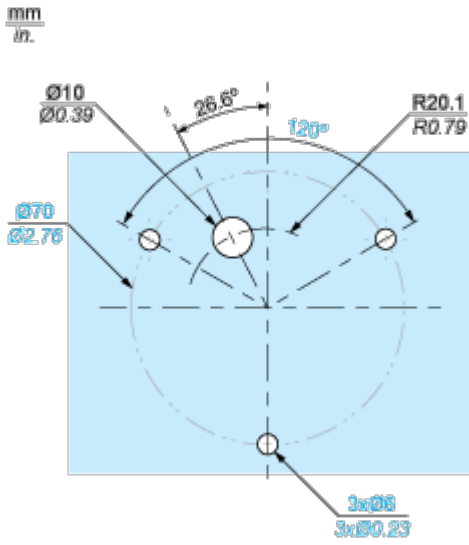

Side wiring

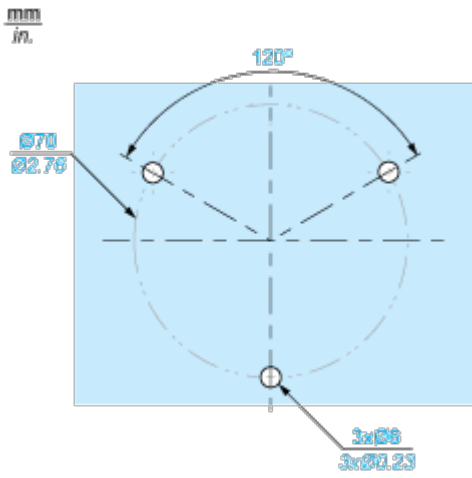

Connections and Schema

Wiring Diagram

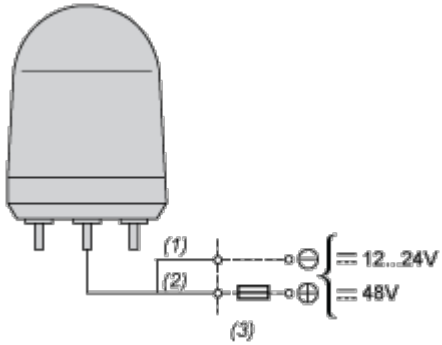

- (1) Black
- (2) White
- (3) Fuse(Rated Current>2A)

Technical Illustration

Wiring diagram

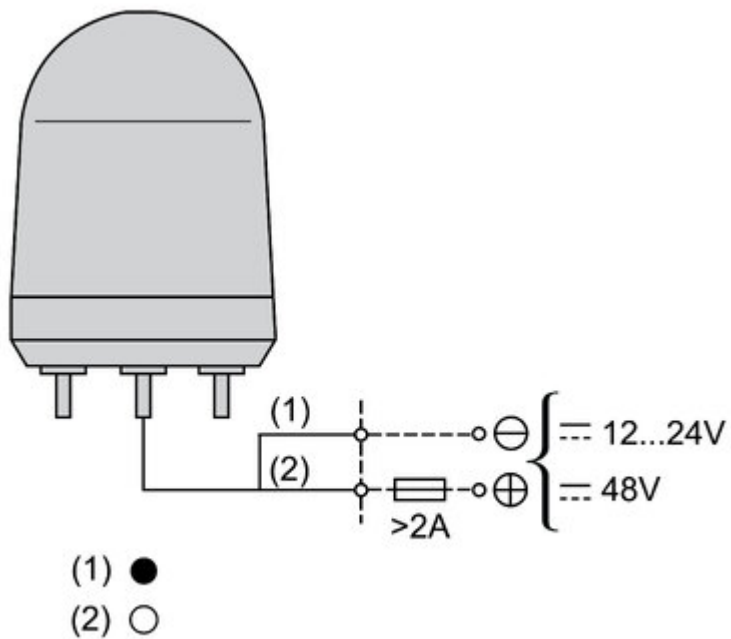

Offer Marketing Illustration

Product benefits / Features

Technical Benefits

Harmony XVR3

Conforms with international IEC standards as well as CE, UL and CCC marking

Protection ratings up to IP65 and vibration resistance to increase reliability

Can be mounted in diverse positions: upright, sideways, and inverted

Motor-less super-bright LED with 360° visibility

Operating temperature from -10 °C to 50 °C



Offer Marketing Illustration

Product benefits / Features

The infographic features a central image of a blue, dome-shaped industrial light fixture with a perforated top and a black base. The base has the Schneider Electric logo. Surrounding the central image are five circular icons, each with a corresponding text block describing a feature. The background is a solid green color.

Features Harmony XVR3

- 4 colors with 10 light patterns to select with one switch**
- Simplified installation (pre-cabled and pre-assembled products) and easy maintenance**
- High visibility of machine status**
- Buzzer volume adjustment through a built-in switch**
- Available in various diameters to suit different industrial applications**

Image of product / Alternate images

Alternative

