

Product datasheet

Specifications



Base unit + cover for modular tower lights, plastic, black, Ø70, bottom entry, side cable entry

Local distributor code:

380607398

XVBC21

⚠ To be discontinued on: 31 Dec 2025

⚠ To be discontinued

Important message: XVB is being substituted by XVB7 as complete range; XVB and XVB7 modules are not interoperable with one another.

EAN Code: 3389110845020

Main

Range of product	Harmony XVB Universal
Product or component type	Base unit with cover
Component name	XVBC
Material	Glass reinforced polyamide: base unit Polycarbonate: cover unit

Complementary

fixing mode	Direct or tube fixing
Mounting diameter	70 mm
Product destination	Banks without flash discharge tube unit
Electrical connection	1 connector for standard input
cable entry	Bottom or side entry
Assembly style	Customer assembly, up to 5 units
Terminals description ISO n°1	(GND)GROUND (COM-1)PW (COM-4)PW (COM-3)PW (COM-5)PW (COM-2)PW
Net weight	0.19 kg

Environment

Product certifications	CCC EAC CSA C22-2 No 14 UL 508
Standards	IEC 60947-5-1
Protective treatment	TC
Ambient air temperature for storage	-40...70 °C
NEMA degree of protection	Type 4X conforming to UL (indoor)

Packing Units

Unit Type of Package 1	PCE
------------------------	-----

Number of Units in Package 1	1
Package 1 Height	8.500 cm
Package 1 Width	10.000 cm
Package 1 Length	9.500 cm
Package 1 Weight	206.000 g
Unit Type of Package 2	S03
Number of Units in Package 2	36
Package 2 Height	30.000 cm
Package 2 Width	30.000 cm
Package 2 Length	40.000 cm
Package 2 Weight	8.173 kg
Unit Type of Package 3	P06
Number of Units in Package 3	288
Package 3 Height	75.000 cm
Package 3 Width	60.000 cm
Package 3 Length	80.000 cm
Package 3 Weight	71.516 kg

Logistical informations

Country of origin	ID
-------------------	----

Contractual warranty

Warranty	18 months
----------	-----------



Environmental Data

Schneider Electric aims to achieve Net Zero status by 2050 through supply chain partnerships, lower impact materials, and circularity via our ongoing “Use Better, Use Longer, Use Again” campaign to extend product lifetimes and recyclability.

[Environmental Data explained >](#)

[How we assess product sustainability >](#)

Environmental footprint

Total lifecycle Carbon footprint 3

Environmental Disclosure [Product Environmental Profile](#)

Use Better

Materials and Substances

Packaging made with recycled cardboard Yes

Packaging without single use plastic Yes

[EU RoHS Directive](#) Pro-active compliance (Product out of EU RoHS legal scope)

SCIP Number 91020e1b-4a08-4f42-b464-aa95672e6762

REACH Regulation [REACH Declaration](#)

Use Again

Repack and remanufacture

Recyclability potential, in % 9

End of life manual availability No need of specific recycling operations

Take-back No

Dimensions Drawings

Indicator Bank without “Flash” Discharge Tube Unit

Dimensions

Below drawing shows the minimum configuration of the product. Select the number of stages according to the product characteristics in order to get **b** dimension.

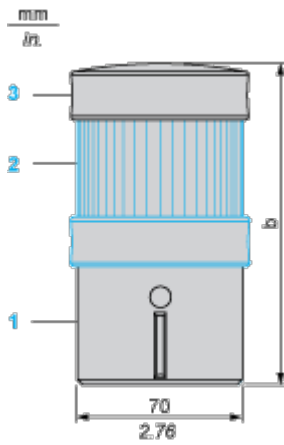

- (1) Base unit
- (2) Illuminated or audible signalling unit XVBC***, to be ordered separately
- (3) Cover (supplied with base unit)

Number of illuminated or audible signalling units (no “flash”)	b in mm	b in in.
1	138	5.43
2	201	7.91
3	264	10.39
4	327	12.87
5	390	15.35

Mounting and Clearance

Base Unit for Indicator Banks

Panel Cut-out for Direct Fixing

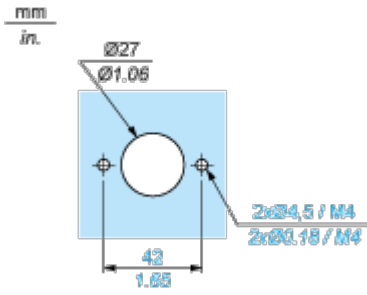

Connections and Schema

Illuminated Beacon

Wiring Diagram

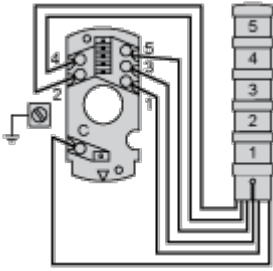

Technical Illustration

Dimensions

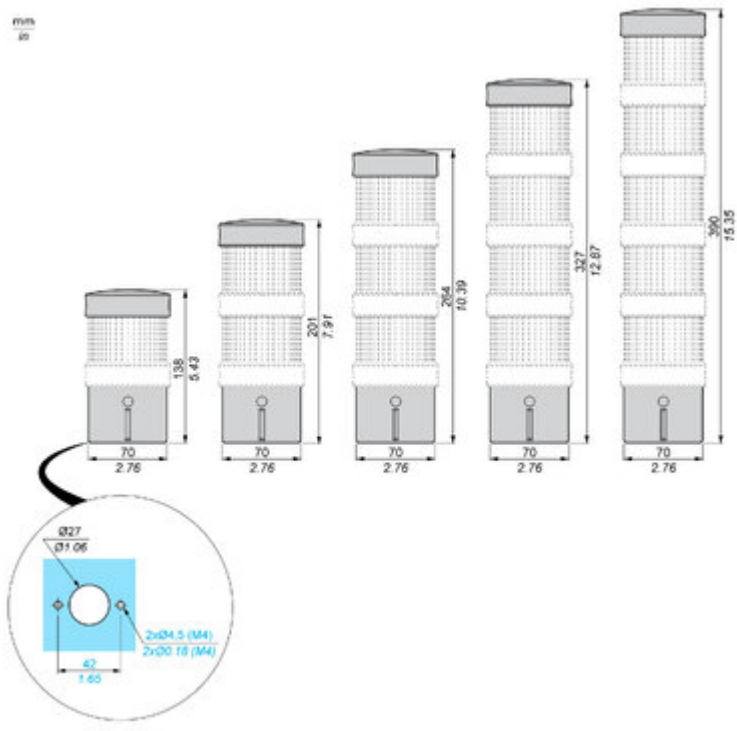

Technical Illustration

Wiring diagram

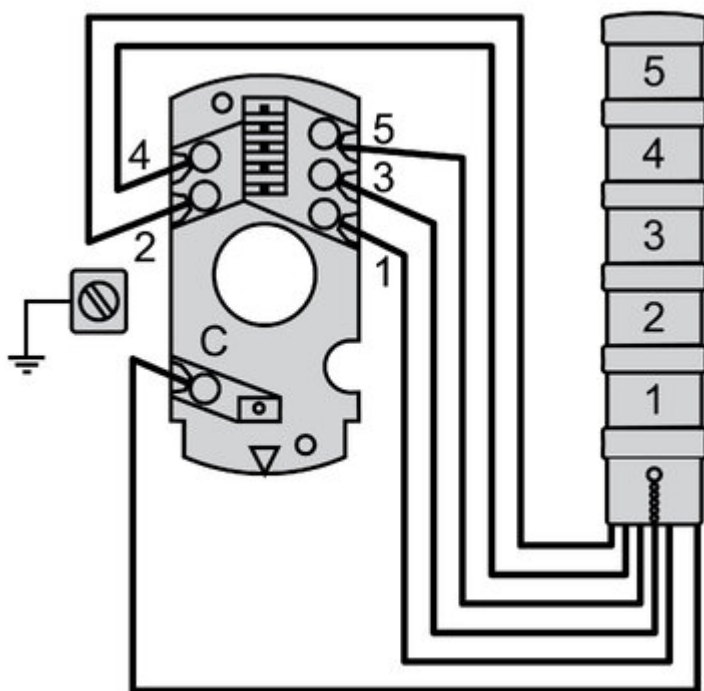

Offer Marketing Illustration

Product benefits / Features

Technical Benefits

Harmony XVB

Robust product performance with high IP protection and IK05 shock resistance



Conformity with International standards



Greater loudness up to 90dB with continuous and intermittent tones



Beacon lens on top with high intensity 5J, 10J Xenon flash, increase visibility from top and surrounding



Offer Marketing Illustration

Product benefits / Features



The infographic features a central image of two light fixtures: a tall, multi-colored lens unit and a shorter, single-colored unit. Surrounding this central image are five circular icons, each with a corresponding text block describing a feature. The background is a solid green color.

Features Harmony XVB

- Light Source:** 3 types of light source: 10-Watt incandescent bulb, built-in high-efficiency LEDs, 5 and 10-joule discharge tube
- Longevity:** 100,000 hours of maintenance-free lighting thanks to "LED Protected" technology
- Protection:** High degree of protection (IP66) and Shock resistance (IK05)
- Flexibility:** Fully flexible and interchangeable construction of up to 5 lens units (six colors of light lens unit)
- Connector:** Connector with removable base, axial, or side cable entry, immediate assembly, and fixing using a locking ring

Image of product / Alternate images

Alternative





Image of product in real life situation

