

Photoelectric switches - DIM

Mini-Clip LR1



white , Part No. 92320

Product Information

- MiniClip LR1 light sensor with mixed light measurement for constant light control, to be clipped on to the T5 and T8 fluorescent lamps
- 1 – 10 V interface for controlling analog, dimmable ballasts
- Continuous dimming is used to implement constant light control for room lights that adapt to the amount of daylight.
- The light value to be kept constant in the room may be set by turning the knurled sensor cap.
- **Application examples:** offices, conference rooms, corridors, training facilities

Technical Data

Dimensions:	Ø 31 x 68 mm
Detection area:	vertical 140° (Ceiling mounting)
Degree / class of protection:	IP20 / Class II
Ambient temperature:	0 °C to +50 °C
Housing:	polycarbonate, UV-resistant
Channel 1 (lighting control)	
DIM output:	1-10 V DC, up to 50 ballasts
Switch-on threshold:	400 – 1500 Lux

Description

Description	Colour	Part number	EAN number
MiniClip LR1	white	92320	4007529923205



Wiring diagramms

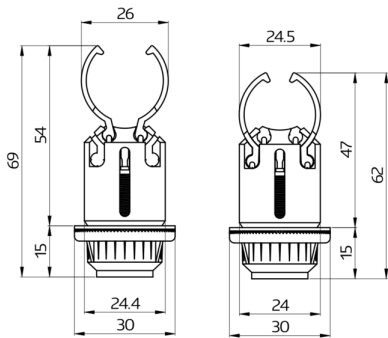

Dimensions 92320