

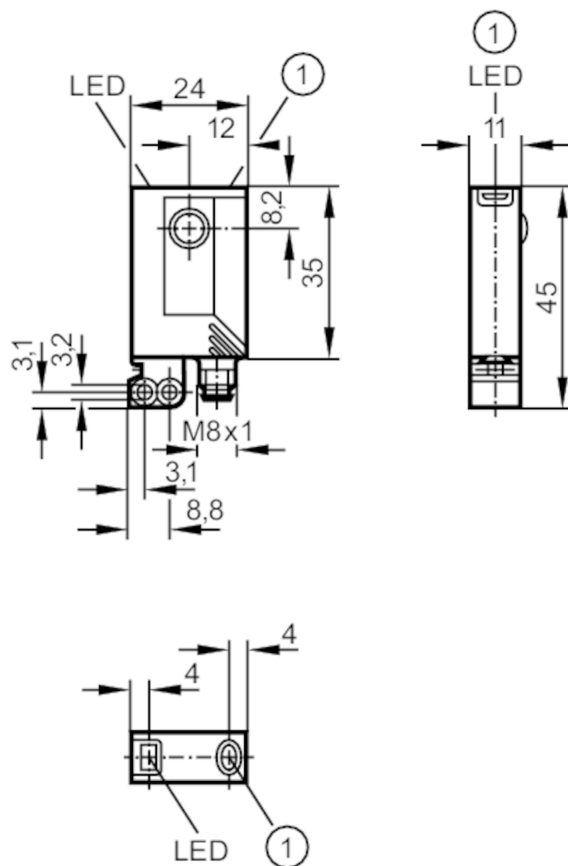

Through-beam laser sensor transmitter

OJSLOOKG/FO/AS



1 pushbutton



Product characteristics

| | |
|------------------------|-------------|
| Type of light | red light |
| Laser protection class | 1 |
| Housing | rectangular |

Application

| | |
|--------------------|---------------------|
| Function principle | Through-beam sensor |
|--------------------|---------------------|

Electrical data

| | | |
|-----------------------------|------|------------|
| Operating voltage | [V] | 10...30 DC |
| Current consumption | [mA] | < 12 |
| Protection class | | III |
| Reverse polarity protection | | yes |
| Type of light | | red light |
| Wave length | [Nm] | 650 |
| Typ. lifetime | [h] | 50000 |

Outputs

| | |
|---------------------|-----|
| Overload protection | yes |
|---------------------|-----|

OJ5019



Through-beam laser sensor transmitter

OJSLOOKG/FO/AS

| Detection zone | | |
|--------------------------------|---|---|
| Transmitter / receiver | transmitter | |
| Range [m] | < 1 | |
| Range adjustable | no | |
| Max. light spot diameter [mm] | 4 | |
| Light spot dimensions refer to | at maximum range | |
| Operating conditions | | |
| Ambient temperature [°C] | -10...60 | |
| Protection | IP 67 | |
| Tests / approvals | | |
| EMC | EN 60947-5-2 | |
| Laser protection class | 1 | |
| Notes on laser protection | Caution: laser class: | laser light 1 |
| | | EN / IEC60825-1:2007 |
| | | EN / IEC60825-1:2014 |
| | | Complies with 21 CFR 1040 except for deviations pursuant to Laser Notice No. 50, dated June 2007. |
| MTTF [years] | 918 | |
| Mechanical data | | |
| Weight [g] | 42.8 | |
| Housing | rectangular | |
| Dimensions [mm] | 35 x 24 x 11 | |
| Materials | housing: ABS; fixture: diecast zinc; LED window: SEPS; pushbutton: SEPS | |
| Lens material | glass | |
| Lens alignment | front lens | |
| Displays / operating elements | | |
| Display | operation 1 x LED, green | |
| Accessories | | |
| Items supplied | Basic clip: 1, E20964 | |
| | screws: 2 x M3 x 16 | |
| | spring washers: 2 | |
| | Nuts: 2 | |
| Remarks | | |
| Remarks | operating voltage "supply class 2" according to cULus | |
| Pack quantity | 1 pcs. | |
| Electrical connection | | |
| Connector: 1 x M8 | | |

OJ5019



Through-beam laser sensor transmitter

OJSLOOKG/FO/AS



Connection

