

Accessories Fitting Guide

Clip-Over Accessories - for ½-round 20x10mm, 30x15mm, 50x25mm profiles & 22x22mm ¼-round only

Design forgives rough or oblique cuts, and imprecise measuring.

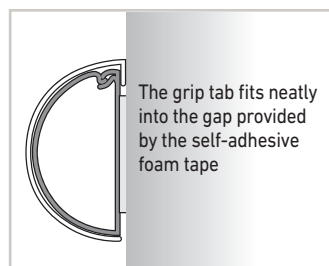
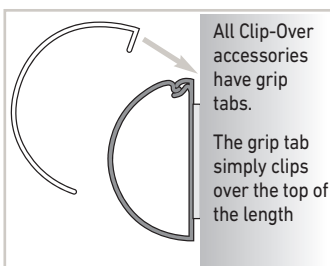

Smooth-Fit Accessories - for ½-round 16x8mm, 40x20mm, 60x30mm, & 30x30mm ¼-round profiles Also available for 30x15mm, 50x25mm ½-round, & 22x22mm ¼-round profiles

Internal shoulders fit securely under lengths.

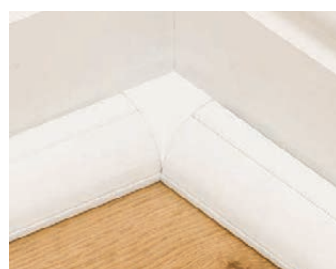



1/2-Round 16 x 8mm Micro Trunking

		White	Magnolia	Aluminium Effect	Black	Oak Effect
Lengths	3.0m Length	R3D1608W	-	-	-	-
	2.0m Length	R2D1608W	R2D1608M	R2D1608A	R2D1608B	R2D1608O
Accessories	Smooth-Fit Internal Bend	IB1608W	IB1608M	IB1608A	IB1608B	IB1608O
	Smooth-Fit External Bend	EB1608W	EB1608M	EB1608A	EB1608B	EB1608O
	Smooth-Fit Flat Bend	FB1608W	FB1608M	FB1608A	FB1608B	FB1608O
	Smooth-Fit Equal Tee	NET1608W	NET1608M	NET1608A	NET1608B	NET1608O
	Smooth-Fit Coupler	NCP1608W	NCP1608M	NCP1608A	NCP1608B	NCP1608O
	Smooth-Fit End Cap	EC1608W	EC1608M	EC1608A	EC1608B	EC1608O



1/2-Round 20 x 10mm Micro+ Trunking

		White
Lengths	3.0m Length	R3D2010W
	2.0m Length	R2D2010W
Clip-Over Accessories	Clip-Over Internal Bend	FLIB2010W
	Clip-Over External Bend	FLEB2010W
	Clip-Over Flat Bend	FLFB2010W
	Clip-Over Equal Tee	FLET2010W
Smooth-Fit Accessories	Smooth-Fit Coupler	CP2010W
	Smooth-Fit End Cap	EC2010W



1/2-Round 40 x 20mm Mini+ Trunking

		White
Lengths	3.0m Length	R3D4020W
	2.0m Length	R2D4020W
Accessories	Smooth-Fit Internal Bend	IB4020W
	Smooth-Fit External Bend	EB4020W
	Smooth-Fit Flat Bend	FB4020W
	Smooth-Fit Equal Tee	ET4020W
	Smooth-Fit Coupler	CP4020W
	Smooth-Fit End Cap	EC4020W
	Smooth-Fit Box Adaptor Tee	AT4020W



1/2-Round 30 x 15mm Mini Trunking

		White	Magnolia	Aluminium Effect	Black	Oak Effect	Red
Lengths	3.0m Length	R3D3015W	R3D3015M	R3D3015A	R3D3015B	R3D3015O	R3D3015R
	2.0m Length	R2D3015W	R2D3015M	R2D3015A	R2D3015B	R2D3015O	-
	3.0m Self Adhesive Internal Divider	3AD3015L	-	-	-	-	-
Clip-Over Accessories	Clip-Over Internal Bend	FLIB3015W	FLIB3015M	FLIB3015A	FLIB3015B	FLIB3015O	FLIB3015R
	Clip-Over External Bend	FLEB3015W	FLEB3015M	FLEB3015A	FLEB3015B	FLEB3015O	FLEB3015R
	Clip-Over Flat Bend	FLFB3015W	FLFB3015M	FLFB3015A	FLFB3015B	FLFB3015O	FLFB3015R
	Clip-Over Door Top Bend	FLDB3015W	FLDB3015M	FLDB3015A	FLDB3015B	FLDB3015O	FLDB3015R
	Clip-Over Equal Tee	FLET3015W	FLET3015M	FLET3015A	FLET3015B	FLET3015O	FLET3015R
	Clip-Over Flat Adaptor	FA3015W	-	-	-	-	FA3015R
Smooth-Fit Accessories	Smooth-Fit Internal Bend	IB3015W	IB3015M	IB3015A	IB3015B	IB3015O	IB3015R
	Smooth-Fit External Bend	EB3015W	EB3015M	EB3015A	EB3015B	EB3015O	EB3015R
	Smooth-Fit Flat Bend	FB3015W	FB3015M	FB3015A	FB3015B	FB3015O	FB3015R
	Smooth-Fit Equal Tee	ET3015W	ET3015M	ET3015A	ET3015B	ET3015O	ET3015R
	Smooth-Fit Cable Outlet	CO3015W	CO3015M	CO3015A	CO3015B	CO3015O	-
	Smooth-Fit Coupler	CP3015W	CP3015M	CP3015A	CP3015B	CP3015O	CP3015R
	Smooth-Fit End Cap	EC3015W	EC3015M	EC3015A	EC3015B	EC3015O	EC3015R
	Smooth-Fit Pattress Adaptor	PA3015W	-	-	-	-	-
	Smooth-Fit Circular Adaptor	CA3015W	-	-	-	-	CA3015R
	Smooth-Fit Box Adaptor	BA3015W	BA3015M	BA3015A	BA3015B	BA3015O	BA3015R
	Smooth-Fit Box Adaptor Tee	AT3015W	AT3015M	AT3015A	AT3015B	AT3015O	-

Colours

☐ **W** White
 ☐ **M** Magnolia
 ☐ **A** Aluminium Effect
 ☐ **B** Black
 ☐ **O** Oak Effect
 ☐ **R** Red
 ☐ **P** Premium Wood (stainable 22x22 only)*
 ☐ **F1** Light Oak Effect

illustrations not to scale

Shape & size (wxh)

Trunking Lengths

3m Length
 2m Length
 3m Self Adhesive Divider
 suitable for all colours

	60x30mm	50x25mm	40x20mm	30x15mm	20x10mm	16x8mm	22x22mm	30x30mm
3m Length	<input type="checkbox"/>	<input type="checkbox"/>	<input type="checkbox"/>	<input type="checkbox"/>	<input type="checkbox"/>	<input type="checkbox"/>	<input type="checkbox"/>	<input type="checkbox"/>
2m Length	<input type="checkbox"/>	<input type="checkbox"/>	<input type="checkbox"/>	<input type="checkbox"/>	<input type="checkbox"/>	<input type="checkbox"/>	<input type="checkbox"/>	<input type="checkbox"/>
3m Self Adhesive Divider	<input type="checkbox"/>	<input type="checkbox"/>	<input type="checkbox"/>	<input type="checkbox"/>	<input type="checkbox"/>	<input type="checkbox"/>	<input type="checkbox"/>	<input type="checkbox"/>

Clip-Over Accessories

Flat Bend	<input type="checkbox"/>	<input type="checkbox"/>	<input type="checkbox"/>	<input type="checkbox"/>	<input type="checkbox"/>	<input type="checkbox"/>	use internal bend	<input type="checkbox"/>
Internal Bend	<input type="checkbox"/>	<input type="checkbox"/>	<input type="checkbox"/>	<input type="checkbox"/>	<input type="checkbox"/>	<input type="checkbox"/>	<input type="checkbox"/>	<input type="checkbox"/>
External Bend	<input type="checkbox"/>	<input type="checkbox"/>	<input type="checkbox"/>	<input type="checkbox"/>	<input type="checkbox"/>	<input type="checkbox"/>	<input type="checkbox"/>	<input type="checkbox"/>
Equal Tee	<input type="checkbox"/>	<input type="checkbox"/>	<input type="checkbox"/>	<input type="checkbox"/>	<input type="checkbox"/>	<input type="checkbox"/>	<input type="checkbox"/>	<input type="checkbox"/>
Door Top Bend	use flat bend	<input type="checkbox"/>	<input type="checkbox"/>	use flat bend	<input type="checkbox"/>	<input type="checkbox"/>	<input type="checkbox"/>	<input type="checkbox"/>
Box Adaptor Tee (50x25 only)	<input type="checkbox"/>	<input type="checkbox"/>	<input type="checkbox"/>	<input type="checkbox"/>	<input type="checkbox"/>	<input type="checkbox"/>	<input type="checkbox"/>	<input type="checkbox"/>
Inlet/Outlet Coupler (22x22 only)	<input type="checkbox"/>	<input type="checkbox"/>	<input type="checkbox"/>	<input type="checkbox"/>	<input type="checkbox"/>	<input type="checkbox"/>	<input type="checkbox"/>	<input type="checkbox"/>
Flat Adaptor	<input type="checkbox"/>	<input type="checkbox"/>	<input type="checkbox"/>	<input type="checkbox"/>	<input type="checkbox"/>	<input type="checkbox"/>	<input type="checkbox"/>	<input type="checkbox"/>

Smooth Fit Accessories

Flat Bend	<input type="checkbox"/>	<input type="checkbox"/>	<input type="checkbox"/>	<input type="checkbox"/>	<input type="checkbox"/>	<input type="checkbox"/>	<input type="checkbox"/>	<input type="checkbox"/>
Internal Bend	<input type="checkbox"/>	<input type="checkbox"/>	<input type="checkbox"/>	<input type="checkbox"/>	<input type="checkbox"/>	use flat bend	use flat bend	<input type="checkbox"/>
External Bend	<input type="checkbox"/>	<input type="checkbox"/>	<input type="checkbox"/>	<input type="checkbox"/>	<input type="checkbox"/>	<input type="checkbox"/>	<input type="checkbox"/>	<input type="checkbox"/>
Equal Tee	<input type="checkbox"/>	<input type="checkbox"/>	<input type="checkbox"/>	<input type="checkbox"/>	<input type="checkbox"/>	<input type="checkbox"/>	<input type="checkbox"/>	<input type="checkbox"/>
Cable Outlet	<input type="checkbox"/>	<input type="checkbox"/>	<input type="checkbox"/>	<input type="checkbox"/>	<input type="checkbox"/>	use equal tee	<input type="checkbox"/>	<input type="checkbox"/>
Cable Inlet	<input type="checkbox"/>	<input type="checkbox"/>	<input type="checkbox"/>	<input type="checkbox"/>	<input type="checkbox"/>	<input type="checkbox"/>	<input type="checkbox"/>	<input type="checkbox"/>
Reducing Tee (to 30x15mm)	<input type="checkbox"/>	<input type="checkbox"/>	<input type="checkbox"/>	<input type="checkbox"/>	<input type="checkbox"/>	<input type="checkbox"/>	<input type="checkbox"/>	<input type="checkbox"/>
Coupler	<input type="checkbox"/>	<input type="checkbox"/>	<input type="checkbox"/>	<input type="checkbox"/>	<input type="checkbox"/>	<input type="checkbox"/>	<input type="checkbox"/>	<input type="checkbox"/>
End Cap	<input type="checkbox"/>	<input type="checkbox"/>	<input type="checkbox"/>	<input type="checkbox"/>	<input type="checkbox"/>	<input type="checkbox"/>	<input type="checkbox"/>	<input type="checkbox"/>
End Cap Left (¼ round only)	<input type="checkbox"/>	<input type="checkbox"/>	<input type="checkbox"/>	<input type="checkbox"/>	<input type="checkbox"/>	<input type="checkbox"/>	<input type="checkbox"/>	<input type="checkbox"/>
End Cap Right (¼ round only)	<input type="checkbox"/>	<input type="checkbox"/>	<input type="checkbox"/>	<input type="checkbox"/>	<input type="checkbox"/>	<input type="checkbox"/>	<input type="checkbox"/>	<input type="checkbox"/>
10mm Pipe Exit End Cap	<input type="checkbox"/>	<input type="checkbox"/>	<input type="checkbox"/>	<input type="checkbox"/>	<input type="checkbox"/>	<input type="checkbox"/>	<input type="checkbox"/>	<input type="checkbox"/>
Corner Tee	<input type="checkbox"/>	<input type="checkbox"/>	<input type="checkbox"/>	<input type="checkbox"/>	<input type="checkbox"/>	<input type="checkbox"/>	<input type="checkbox"/>	<input type="checkbox"/>
Box Adaptor Tee	<input type="checkbox"/>	<input type="checkbox"/>	<input type="checkbox"/>	<input type="checkbox"/>	<input type="checkbox"/>	<input type="checkbox"/>	<input type="checkbox"/>	<input type="checkbox"/>
30x15mm Box Adaptor	<input type="checkbox"/>	<input type="checkbox"/>	<input type="checkbox"/>	<input type="checkbox"/>	<input type="checkbox"/>	<input type="checkbox"/>	<input type="checkbox"/>	<input type="checkbox"/>
Pattress Adaptor	<input type="checkbox"/>	<input type="checkbox"/>	<input type="checkbox"/>	<input type="checkbox"/>	<input type="checkbox"/>	<input type="checkbox"/>	<input type="checkbox"/>	<input type="checkbox"/>
Circular Adaptor	<input type="checkbox"/>	<input type="checkbox"/>	<input type="checkbox"/>	<input type="checkbox"/>	<input type="checkbox"/>	<input type="checkbox"/>	<input type="checkbox"/>	<input type="checkbox"/>

Safe-D Clips - Fire Rated

SAFE-D30 (BS5839 part 1)	<input type="checkbox"/>	<input type="checkbox"/>	<input type="checkbox"/>	<input type="checkbox"/>	<input type="checkbox"/>	<input type="checkbox"/>	<input type="checkbox"/>
SAFE-D40 (BS5839 part 1)	<input type="checkbox"/>	<input type="checkbox"/>	<input type="checkbox"/>	<input type="checkbox"/>	<input type="checkbox"/>	<input type="checkbox"/>	<input type="checkbox"/>
SAFE-D50 (BS5839 part 1)	<input type="checkbox"/>	<input type="checkbox"/>	<input type="checkbox"/>	<input type="checkbox"/>	<input type="checkbox"/>	<input type="checkbox"/>	<input type="checkbox"/>

Surface Boxes

28mm Deep Single	<input type="checkbox"/>
28mm Deep Twin	<input type="checkbox"/>
35mm Deep Single	<input type="checkbox"/>
35mm Deep Twin	<input type="checkbox"/>
28mm Rounded Single	<input type="checkbox"/>
28mm Rounded Twin	<input type="checkbox"/>
35mm Rounded Single	<input type="checkbox"/>
35mm Rounded Twin	<input type="checkbox"/>

Clip-Over
Accessories



Smooth Fit
Accessories



* All oak/wood trunking accessories are brown finish, but can be stained to achieve best colour co-ordination to stained lengths (key surface of accessory with fine abrasive prior to staining)

½-Round Clip-Over Accessories - For 20x10mm, 30x15mm and 50x25mm only

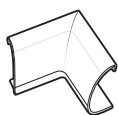

Internal Bend

Join lengths around 90 degree inside corners.



External Bend

Join lengths around 90 degree outside corners.

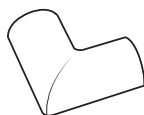

Flat Bend

Change direction by 90 degrees on flat surfaces.



Equal Tee

Use to join 3 lengths of same profile.

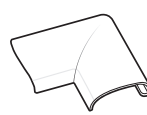

Door Top Bend

Change direction by 90 degrees around frame tops.



Box Adaptor Tee

For use with D-Line Surface Socket Boxes. 50 x 25mm only

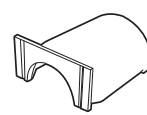

Flat Adaptor

Connect Mini Trunking to flat surfaces 30 x 15mm only

¼-Round Clip-Over Accessories - For 22x22mm only



Internal Bend

Join lengths around 90 degree inside corners.



External Bend

Join lengths around 90 degree outside corners.



Cable Inlet/Outlet

Use to provide cable entry/exit point between 2 lengths.



Use with Smooth-Fit Couplers & End Caps

½-Round Smooth-Fit Accessories

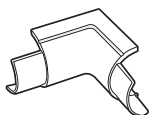

Internal Bend

Join lengths around 90 degree inside corners.

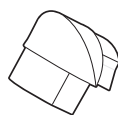

External Bend

Join lengths around 90 degree outside corners.

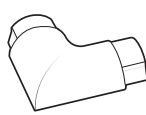

Flat Bend

Change direction by 90 degrees on flat surfaces.

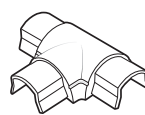

Equal Tee

Use to join 3 lengths of same profile.

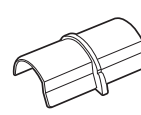

Coupler

Join 2 lengths of same profile on flat surface.

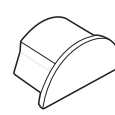

End Cap

Neatly finish open ends.

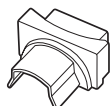

Pattress Adaptor

Connect Mini Trunking to round surface pattresses. 30 x 15mm only

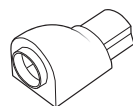

Circular Adaptor

Connect Mini Trunking to flat edge surfaces with 20mm Ø knock-outs. 30 x 15mm only

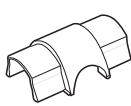

Cable Inlet/Outlet

Takes cables in or out of a Mini Trunking. Use between lengths on straight runs. 30 x 15mm only

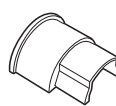

Box Adaptor

For use with D-Line Surface Socket Boxes. 30 x 15mm only

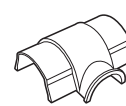

Box Adaptor Tee

For use with D-Line Surface Socket Boxes.



Reducing Tee

Connect to 30 x 15mm Mini Trunking.

¼-Round Smooth-Fit Accessories



Internal Bend

Join lengths around 90 degree inside corners.

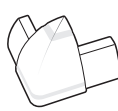

External Bend

Join lengths around 90 degree outside corners.

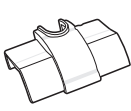

Cable Inlet

Use to provide cable entry point between 2 lengths.

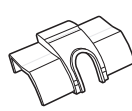

Cable Outlet

Use to provide cable exit point between 2 lengths.

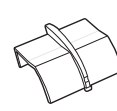

Coupler

Joins 2 lengths on flat surfaces.

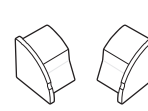

End Cap

Neatly finish open ends (left & right versions apply).

Other Accessories

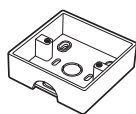

Single Surface Socket Box

For use with 30 x 15mm, 40 x 20mm & 50 x 25mm Trunking. Available in 28mm & 35mm depth.

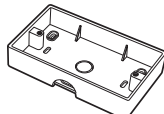

Twin Surface Socket Box

For use with 30 x 15mm, 40 x 20mm & 50 x 25mm Trunking. Available in 28mm & 35mm depth.



SAFE-D30 Clip

Fire rated cable clip for use with 30 x 15mm D-Line & 25mm+ wide traditional trunkings. Safe-D Red version also available.

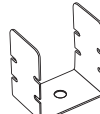

SAFE-D40 Clip

Fire rated cable clip for use with 40 x 20mm & 50 x 25mm D-Line & 40mm+ wide traditional trunkings.

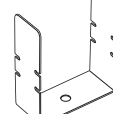

SAFE-D50 Clip

Fire rated cable clip for use with 60 x 30mm D-Line & 50mm+ wide traditional trunkings.



Ratchet Cutting Tool

Use to cut up to 40mm wide D-Line Trunking.