

Skypack™ QR Range

Installation instructions for Skypack™ LED Battens



Warnings & Cautions

- To avoid electric shock, serious injury or property damage, isolate power before installing, removing or servicing the product.
- It is recommended that luminaires are installed by a qualified electrician to ensure the installation complies with the local current wiring regulations.
- It may be necessary to upgrade your MCBs to allow for increased inrush current.
- This luminaire is suitable for indoor use only.
- This product cannot be covered with insulation material - do not cover.
- Any broken or damaged parts should be replaced as soon as possible. JCC will not accept responsibility for claims arising from sub-standard installations; which will void the warranty.
- Emergency product routine inspection and tests must be undertaken at times of least risk and in accordance with EN 50172:2004. A copy of this report must accompany any fitting returned to JCC for any reason.

INSTALLATION

ENGLISH

- To remove the diffuser and LED tray from the body press both the release buttons at each end of the fitting as shown in Fig. 1.
- The diffuser and LED tray is secured to the body with security tabs, which will support the diffuser when installing the body.
- Secure the fitting in the desired position either using the fixing points or BESA plates for conduit mounting.
- Terminate the wiring into the press fit terminal as shown in Fig. 2 or into fused terminal for the emergency version as shown in Fig. 3.
- Connect DALI or 1-10V dimming controls indicated as per Fig. 2(A)
- Connect batteries on emergency version (allow a full 24 hours for batteries to charge prior to testing). Please refer to periodic test procedure on page two.
- Refit the front cover by aligning the diffuser with the body and click into place.
- Turn on the mains supply and check operation.

N.B This luminaire is suitable for surface, BESA mounting or with conduit end entry to both ends.

Note: DO NOT carry out insulation tests with the driver connected to the circuit.

Dimming control input Figure 2(A).

1-10V control wires

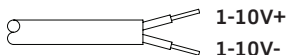

DALI control wires

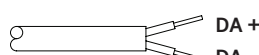

Standard version connection

220-240V 50/60Hz / Class I

Figure 2.

N = neutral
⊕ = earth
L = Live

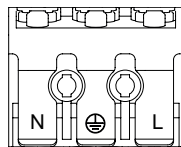

Emergency version connection

220-240V 50/60Hz / Class I

Figure 3.

L1 = Unswitched live
L = Switched Live
⊕ = earth
N = neutral

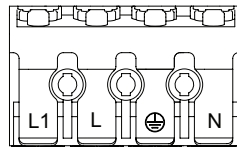
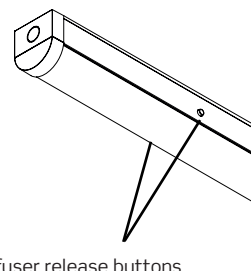

Figure 1.



Diffuser release buttons

Specifications Colour temp: 4000K Ra: 80

Skypack™	Product code	Total circuit wattage	Lumens	LpcW
4ft Single	JC71741	23	2760	120
4ft Single EM	JC71741EM	25	2760	110
4ft Twin	JC71742	40	4800	120
4ft Twin EM	JC71742EM	42	4800	114
5ft Single	JC71743	37	4440	120
5ft Single EM	JC71743EM	39	4440	113
5ft Twin	JC71744	60	7200	120
5ft Twin EM	JC71744EM	62	7200	116
6ft Single	JC71745	54	6480	120
6ft Single EM	JC71745EM	56	6480	116
6ft Twin	JC71746	82	9800	120
6ft Twin EM	JC71746EM	84	9800	117

Important warranty information

This product is supported by a 2-year standard warranty which will extend to 5-years if registered within the first year of purchase.
Please register at jcc.co.uk/warranty (Terms and conditions apply).

The installer will be asked to provide the following information, which is detailed on a label attached to the luminaire's chassis: Product Code/Date Code.



IP20 jcc.co.uk

BS EN ISO9001 - 2015 - Registered Firm Certificate No. GB 1552

JCC Lighting Products Ltd. Innovation Centre, Beeding Close, Southern Cross Trading Estate, Bognor Regis, West Sussex, PO22 9TS, United Kingdom

Technical Support: +44(0)1243 838986 Customer Services: +44(0)1243 838999

V8_Jan_2021_RS

All tests must be undertaken at times of least risk and in accordance with EN 50172:2004 as indicated below:

Monthly: (in addition to the daily check) If automatic testing devices are used, the results of the short duration tests shall be recorded. Test shall be carried out as follows:

- NOTE: The period of simulation failure should be sufficient for the purpose of this clause whilst minimising damage to the system components e.g lamps. During this period, all luminaires and signs shall be checked to ensure that they are present, clean and functioning correctly. At the end of this test period, the supply to the normal lighting should be restored and any indicator lamp or device should be checked to ensure that is showing that the normal supply has been restored.

- a) Each luminaire and internally illuminated sign shall be tested monthly as above but for its full duration in accordance with the manufacturer's information.
- b) The normal supply for the luminaire should be restored and any charge indicator lamp or device should be checked to ensure that it shows the normal supply has been restored. The charging arrangements should be checked for proper functioning.
- c) The date of the test and its results shall be recorded in the system logbook.

General Information

Maintenance

Both mains supply and battery protection fusing is incorporated internally. Should access to these or any other part of the circuitry be required this must be undertaken only by a suitably qualified person. Special care must be taken when removing the cover to circuitry and battery. Only replacement components authorised by the company must be used. Disposal of replaced components should be in accordance with the component manufacturers instructions.

You can help protect the environment. Please remember to respect the local regulations: hand in the non-working electrical equipment to an appropriate waste disposal centre. The packaging material is recyclable. Dispose of the packaging in an environmentally friendly manner and make it available for the recyclable material collection service.

6ft single/twin

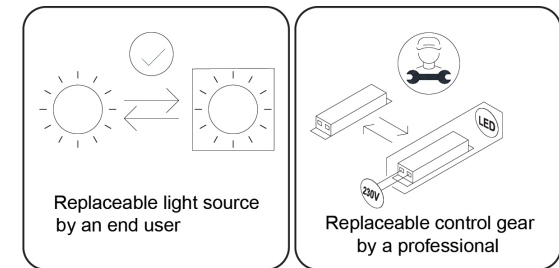
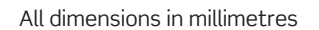
[illegible]