

Hammer-On Flange Clip, Bottom Mount

Features

- Can be used to support boxes, fixtures or other applications from beam flanges
- Assorted attachment points provided to reduce inventory
- Requires only a hammer to install

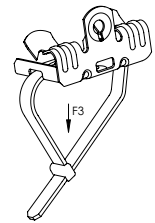
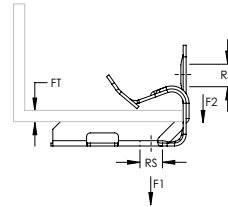

Part Number	Article Number	Flange Thickness	Rod Size	Static Load 1	Static Load 2	Static Load 3	Standard Packaging Quantity
Material: Spring Steel — Finish: CADDY ARMOUR							
EM24	170050	3 – 8 mm	M6	450 N	110 N	330 N	100 pc
EM24SP25	172170	3 – 8 mm	M6	450 N	110 N	330 N	10 x 25 pc
EM58	170060	8 – 14 mm	M6	450 N	110 N	330 N	100 pc
EM58SP25	172180	8 – 14 mm	M6	450 N	110 N	330 N	10 x 25 pc
EM912	170070	14 – 20 mm	M6	450 N	110 N	330 N	100 pc
EM912SP25	175760	14 – 20 mm	M6	450 N	110 N	330 N	10 x 25 pc
Material: Stainless Steel 301 [EN 1.4310]							
EM24S1	179720	3 – 8 mm	M6	450 N	110 N	330 N	100 pc
EM58S1	179730	8 – 14 mm	M6	450 N	110 N	330 N	100 pc
EM912S1	179740	14 – 20 mm	M6	450 N	110 N	330 N	100 pc