



Available finish:- 201 Stainless Steel

Read these instructions before commencing installation. Please give these instructions to the owner/occupier after installation to retain for future reference/maintenance.

IP44 0.5m 240V~50Hz GU10 35W Max

These fittings are Class I and must be Earthed

### Important Information

It is recommended that these luminaires are installed and fitted by a qualified electrician ensuring the installation complies with current IEE wiring regulations & local building control. These products are designed for connection to a 240V~50Hz supply.

Any faulty, broken or damaged luminaires should be replaced immediately.

KSR will not accept responsibility for any claims arising from a poor installation.

Please Note: The limited warranty shall be deemed null and void in the following circumstances: Failure by the installer, end user or any third party to exercise caution to protect any covered product or part from outside damage, humidity conditions, fluctuations in the electrical system or physical abuse as well as failure related to workmanship in the installation of the products or parts.

### Important User Advice

Always isolate mains supply before servicing, lamp changes and maintenance.

Please ensure that a suitable maintenance schedule is performed including greasing all moving parts and protection from exposure to natural elements in the form of a non-abrasive cleaner/water repellent protection to ensure the product gives you a long lasting trouble free life.

Please note that IP44 rated luminaires should not be installed in exposed areas where they are likely to be exposed to adverse weather conditions. i.e. heavy rain.

### Installation Procedure

Safely isolate the mains supply.

Remove and retain capped nuts and seals from luminaire to access terminal block and fixing holes.

Remove the backplate.

Using the backplate and mark the position of the fixings on the wall, avoiding any wiring in the wall.

Drill and prepare the holes for suitable fixings (Not Supplied) ensuring that the fixings are into solid material.

Bring the cable through the grommet, ensuring the grommet is creating a watertight seal around the cable. Please note this product is not suitable for looping in and out.

Fix the backplate to the substrate.

Support the luminaire whilst making connections. Always avoid straining cables.

Prepare supply cables as follows:

Remove insulation from the L/N/E connections.

Connect the live supply (L) Brown to the live terminal, connect the Neutral (N) Blue to the Neutral terminal and connect the Earth (E) Green / Yellow to the Earth Terminal in the terminal block.

When carrying out the connection procedure always ensure all terminations are fully tightened and no loose strands of wire are present.

Refit the luminaire to the base ensuring all seals are in place and no cables are trapped.

Reinstall seals on the bolts and refit and tighten the capped nuts.

Install lamps that are suitable for use in enclosed luminaires by unscrewing the cap anticlockwise.

Install lamp and ensuring the seal is in place and not damaged refit the cap by screwing clockwise.

Never exceed wattage shown on luminaire.

Turn on mains supply and test.

**Do Not** expose luminaire to areas where high pollution and saline maybe present.

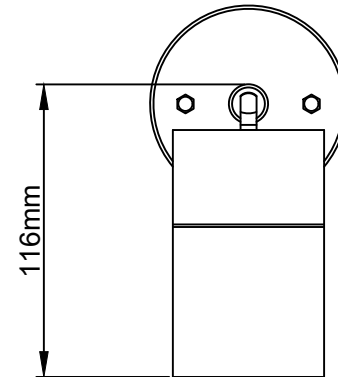
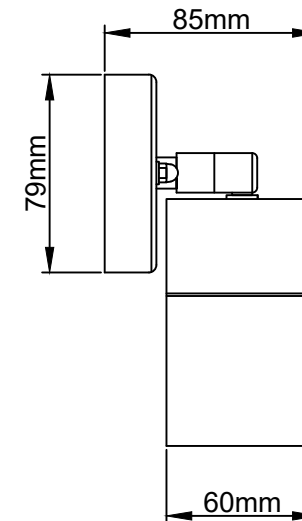
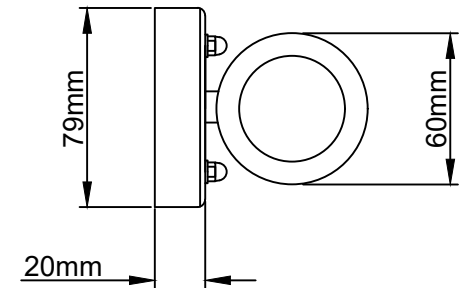

KSR1358

### Lamp Details

Lamp Cap: GU10  
Max Wattage: 35W

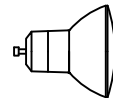

KSR Lighting recommend only branded lamps  
For example: Sylvania, GE, Philips or Osram

KSR Lighting Aftersales: 023 92 674343

E-mail: aftersales@ksrlighting.com

