

P1218

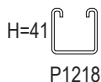

PG SS

P2785 - P2787

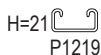
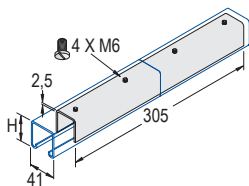
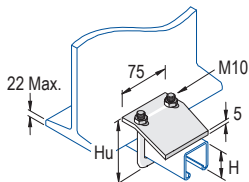

Used in pairs.

HG SS

Mild steel "U" bolts are zinc plated.

Part No.	SS	H (mm)	Hu (mm)
P2785	•	21-41	86
P2786	•	62-83	127
P2787		124-164	209

P3087

P3087=
P3087A + P3087B

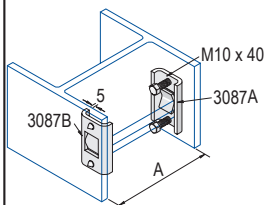

HG SS

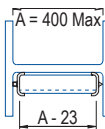

Apply load in one direction only.
Mild steel cone pointed screws are zinc plated.

Z10

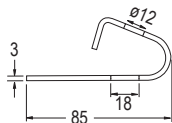
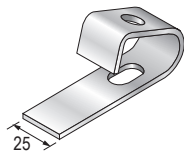

PG