

END SLEEVE, PRE-INSULATED WITH PA6, FOR FLEXIBLE COPPER CONDUCTORS



Features

TECHNICAL INFORMATION

Minimum operating temperature	-20 °C
Maximum operating temperature	115 °C
Threshold of operating temperature for short periods	130 °C
Conditions of use	statico, al chiuso
Type	singolo
Easy insertion input	Yes
Self-extinguishing fire class according to UL 94	V2

LOGISTIC

Type of packaging	; box
Unit in minimal packaging	25 PCS
Minimum order quantity	25 PCS
Customs code	85369010

MATERIAL COMPOSITION AND TREATMENTS

Conductor body material	Electrolitic copper with purity above 99,95%
Minimum thickness of the surface coating of the conducting body	3 µm
Surface treatment of the conductor body	tin plating
Insulated cover material	Poliammide PA6
Annealing	Yes
Dielectric strength of the insulated cover	16.5 kV/mm
Halogen free	Yes

CLASSIFICATION AND DATA ORDERING

ETIM Class 7	Cable end sleeve [EC000005]
Manufactured in	Taiwan

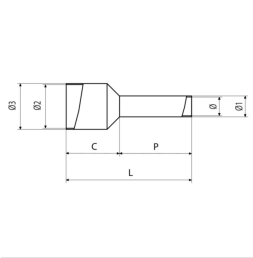

PKC

tipo	Insulated cover color	Range of cable cross section [mm²]	Gross weight [g]	C [mm]	Ø2 [mm]	Cable stripping length [mm]	Ø3 [mm]	P [mm]	L [mm]	Unit in standard packaging [pcs]
PKC70022	Yellow	70	6,470	16	16	22	13.5	22	38	100
PKC95025	red	95	7,731	19	18	25	14.7	25	44	100
PKC120027	blue	120	10,211	21	20	27	16.7	27	48	75