

PRODUCT CODE: CTM75ET
CABLE TRAY



DESCRIPTION

CTM75ET - 75mm GALV MEDIUM DUTY RETURN FLANGE 90 DEGREE
FLAT TEE

FINISH

PRE GALVANISED

MATERIAL

STEEL - GRADE Z275

PACKAGING

EACH

ADDITIONAL NOTES

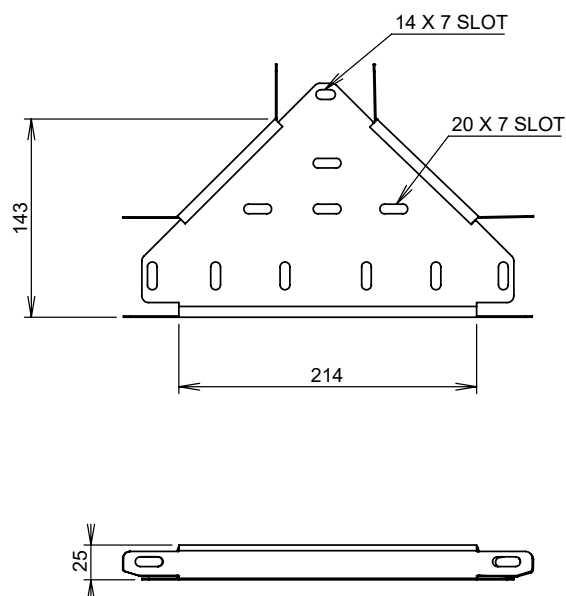

 Values are nominal and with a general tolerance $\pm 5\%$ unless otherwise specified