

PANEL MOUNTING APPLIANCE INLETS

- IEC 60309-1/2, EN 60309, VDE 0623
- Protection degree IP44

Panel Mounting Appliance Inlet

- Screw terminals
- Protection degree IP44

Ampere	Poles	110V 50-60 Hz			230V 50-60 Hz			400V 50-60 Hz			500V 50-60 Hz			100-300Hz > 50V			301-500Hz > 50V			Qty	each
		2P+E 4h	3P+E 4h	3P+N+E 4h	3pol 4h	4pol 4h	5pol 4h	3pol 6h	4pol 9h	5pol 9h	3pol 9h	4pol 6h	5pol 6h	3pol 7h	4pol 7h	5pol 7h	3pol 10h	4pol 10h	5pol 10h		
16	3				260			261		262										10	140
16	4				263			264		265		266	267		268					10	180
16	5				2610			2611		2612		2649			26036					10	180
32	3							2662												10	200
32	4				26026			2684		2663		2664	2679		26028					10	225
32	5				26023			26030		2600		26065			26029					10	230



Fig.: Type 2612

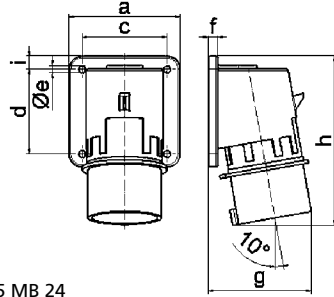

5 MB 24

Ampere	16	16	16	32	32	32
Poles	3	4	5	3	4	5
a	74.0	75.0	84.0	90.0	90.0	90.0
b	84.0	100.0	84.0	75.0	75.0	75.0
c	58.0	62.0	64.0	78.0	78.0	78.0
d	64.0	74.0	64.0	45.0	45.0	45.0
e ø	5.5	4.3	5.5	5.5	5.5	5.5
f	12.0	12.0	7.0	7.0	7.0	7.0
g	70.0	77.0	78.0	86.0	86.0	88.0
h	128.0	145.0	129.0	138.0	138.0	140.0
i	-	-	-	13.0	13.0	13.0
Cond. mm² min	1	1	1	2.5	2.5	2.5
Cond. mm² max	2.5	2.5	2.5	6	6	6

Panel Mounting Appliance Inlet

- Screw terminals
- With hinged lid
- Protection degree IP44

Ampere	Poles	110V 50-60 Hz			230V 50-60 Hz			400V 50-60 Hz			500V 50-60 Hz			100-300Hz > 50V			301-500Hz > 50V			Qty	each
		2P+E 4h	3P+E 4h	3P+N+E 4h	3pol 4h	4pol 4h	5pol 4h	3pol 6h	4pol 9h	5pol 9h	3pol 9h	4pol 6h	5pol 6h	3pol 7h	4pol 7h	5pol 7h	3pol 10h	4pol 10h	5pol 10h		
16	3				2625			2626		2627										10	165
16	4				2628			2629		2630		2631	2632		2633					10	200
16	5				2634			2635		2636		2671								10	265
32	3							2656												10	300
32	4							2685		2657		2658								10	315
32	5				26015					2655										10	340



Fig.: Type 2655

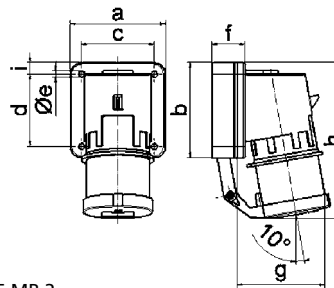

5 MB 2

Ampere	16	16	16	32	32	32
Poles	3	4	5	3	4	5
a	74.0	75.0	84.0	90.0	90.0	90.0
b	84.0	100.0	84.0	75.0	75.0	75.0
c	58.0	62.0	64.0	78.0	78.0	78.0
d	64.0	74.0	64.0	45.0	45.0	45.0
e ø	5.5	4.3	5.5	5.5	5.5	5.5
f	12.0	12.0	29.0	29.0	29.0	29.0
g	78.0	88.0	105.0	114.0	114.0	115.0
h	134.0	151.0	138.0	149.0	149.0	150.0
i	-	-	-	13.0	13.0	13.0
Cond. mm² min	1	1	1	2.5	2.5	2.5
Cond. mm² max	2.5	2.5	2.5	6	6	6