



DATA SHEET

11 WAY METAL RCD INCOMER CONSUMER UNIT

Catalogue Reference :- NMRS1106L
NMRM1106L

Image not to scale



Current Rating	100A
Operating Voltage	240Volts +10/-6%
Short Circuit Rating	16kA when protected by a 100A HRC fuse to BS1361
Insulation Voltage	500Volts AC
IP Rating	IP2XC
Consumer Unit	BSEN 61439-3
Main Switch	BSEN 60947-3
RCD Incomer	BSEN 61008
Colour	RAL 9010
Box Material	Steel
Lid Material (including visor)	Steel
Outgoing Terminal Size Neutral Bar	Maximum cable Size 16mm ²
Outgoing Terminal Size Earth Bar	Maximum cable Size 16mm ²
Incoming Terminal Size Neutral Bar	Maximum cable Size 16mm ²
Incoming Terminal Size Earth Bar	Maximum cable Size 16mm ²
Incoming Switch Disconnecter Size	Maximum cable size Main Switch 50mm ² , RCD 35mm ²
Dimensions	Width Fixings D E 438mm 356mm

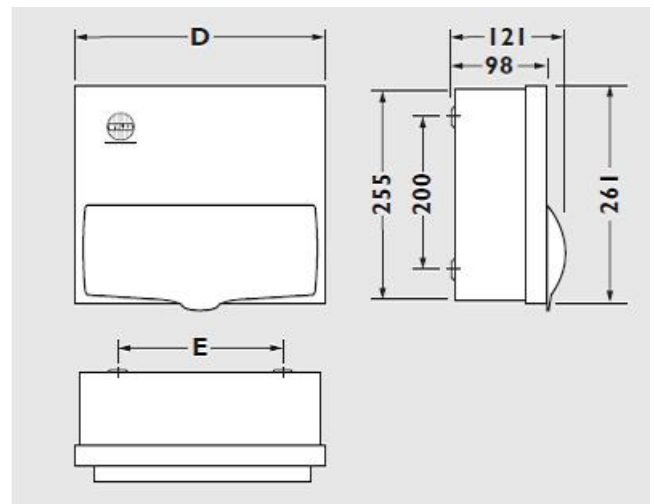

Compatible Circuit Protection Devices:			
MCBs		MINIATURE RCBOs	
6kA B curve (3-5In)	6kA C curve (5-10In)	6kA B curve (3-5In)	6kA C curve (5-10In)
NHXLB06	NHXLC06	NHXS1B06	NHXS1C06
NHXLB10	NHXLC10	NHXS1B10	NHXS1C10
NHXLB16	NHXLC16	NHXS1B16	NHXS1C16
NHXLB20	NHXLC20	NHXS1B20	NHXS1C20
NHXLB25	-	NHXS1B25	-
NHXLB32	NHXLC32	NHXS1B32	NHXS1C32
NHXLB40	NHXLC40	NHXS1B40	NHXS1C40
NHXLB50	NHXLC50	tba	tba

Replacement Incoming devices

- **WRS100/2** (100A 30mA RCD)
- **WRM100/2** (100A 100mA RCD)

Spare Items

- **B4471/SPARE** (user operating instructions)
- **NMTLK2** (Visor locking kit)
- **WPL** (Padlock)

Sales Telephone: 01543 455020
 Technical Telephone: 01543 438320
 Email: wylex.technical@electrium.co.uk

Web: www.electrium.co.uk

WY-V01-2018