

Shower specifications†

Satellites HP Mixer Unit

thermostatic mixer shower

Temperature Control	Thermostatic
Inlet Connections	15mm push fit flexible hoses supplied with unit
Water Entry Points	Side exposed
Cable Entry Points	Pre-wired
Outlet Connection	15mm push fit flexible hoses supplied with unit
Plumbing System Compatibility	High pressure only
Minimum Running Pressure/Flow	1 Bar @ 8 l/min
Maximum Running Pressure	5 Bar
Maximum Static Pressure	10 Bar
Open Outlet Flowrate at 1 Bar	9.6l/min
Mains Supply	230V, 50Hz, current 5 amps
Approvals, Complies with	CE, IPX4
Guarantee	5 years

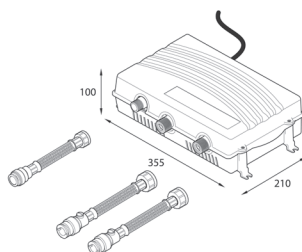

Finish	High pressure mixing unit and sirona panel
Code	SATMIXSIR-HP

Satellites LP Mixer Unit

thermostatic mixer shower

Temperature Control	Thermostatic
Inlet Connections	15mm push fit flexible hoses supplied with unit
Water Entry Points	Side external
Cable Entry Points	Pre-wired
Outlet Connection	15mm push fit flexible hoses supplied with unit
Plumbing System Compatibility	Low pressure gravity
Minimum Head Pressure/Flow	100mm
Maximum Head Pressure	10m (1 Bar)
Maximum Static Pressure	10m (1 Bar)
Open Outlet Flowrate at 0.1 Bar	15.3l/min
Mains Supply	230V, 50Hz, current 5 amps
Approvals, Complies with	BEAB, CE, IPX4
Guarantee	5 years

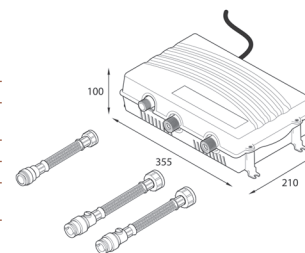

Finish	Low pressure mixing unit and sirona panel
Code	SATMIXSIR-LP

Satellites Sirona Control Panel

thermostatic mixer shower

Dip switch	Low pressure settings	High pressure settings
1 on	Run time set @10 mins	Run time set @10 mins
1 off	Run time set @20 mins	Run time set @20 mins
2 on	Temp range 35-41°C	Temp range 35-41°C
2 off	Temp range 35-47°C	Temp range 35-47°C
3 on	Eco mode set to on	Eco mode set to 'on' if dip 4 set to 'off'
3 off	Full flow control	Full flow control if dip 4 set to 'off'
4 on	Commissioning	Flow set at number 10 (combi flow)
4 off	Normal operation	Normal operation

Approvals, Complies with IPX4

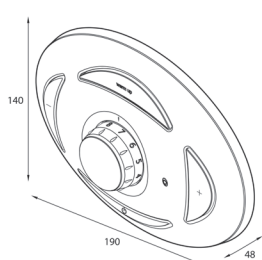

Finish	High pressure mixing unit and sirona panel
Code	SATMIXSIR-HP
Finish	Low pressure mixing unit and sirona panel
Code	SATMIXSIR-LP

Satellites Metis Kit

- Suitable for both loft or cupboard installations

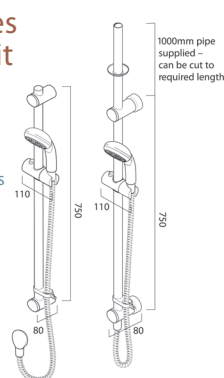

Finish	Code
Chrome	KITSATMET

Satellites Mellena Kit

- Suitable for loft installations

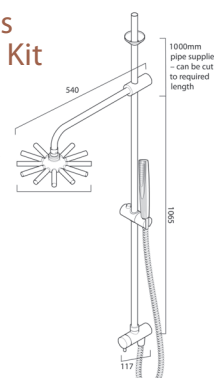

Finish	Code
Chrome	KITSATMEL

Satellites Bellona Kit

- Suitable for loft installations

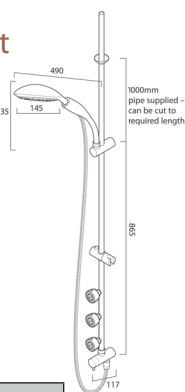

Finish	Code
Chrome	KITSATBEL

Satellites Carlova Kit

- Suitable for both loft or cupboard installations

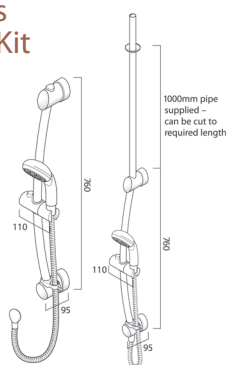

Finish	Code
Chrome	KITSATCAR

Satellites Cyrene Kit

- Suitable for loft installations only
- Attaches to ceiling

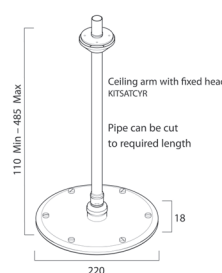

Finish	Code
Chrome	KITSATCYR

Aspirante & T300si

wireless electric shower

Temperature Control	Stabilised
Power Ratings	9.5 kW, 10.5 kW
Inlet Connection	15mm compression
Water Entry Points	Bottom, back (right hand side of unit)
Cable Entry Points	Back, top (right hand side of unit)
Outlet Connection	1/2" BSP
Plumbing System	Cold water only
Minimum Running Pressure/Flow	1 Bar @ 8 l/min and 1.5 Bar @ 11 l/min for 10.5 kW
Maximum Static Pressure	10 Bar
Surface Mounted Only	
Approvals, Complies with	BEAB, CE, BSI Kitemark
Guarantee	2 years

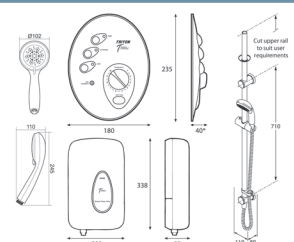

T300si	Finish	Power	Code
	Satin/Chrome	9.5 kW	SP309SIWLSA
	Satin/Chrome	10.5 kW	SP310SIWLSA

Aspirante	Finish	Power	Code
	Chrome	9.5 kW	ASP3CHR09SIWL
	Chrome	10.5 kW	ASP3CHR10SIWL

Aspirante & T300si

remote electric shower

Temperature Control	Stabilised
Power Ratings	8.5kW, 9.5 kW, 10.5 kW
Inlet Connection	15mm compression
Water Entry Points	Bottom, back (right hand side of unit)
Cable Entry Points	Back, top (right hand side of unit)
Outlet Connection	1/2" BSP
Plumbing System	Cold water only
Minimum Running Pressure/Flow	1 Bar @ 8 l/min and 1.5 Bar @ 11 l/min for 10.5 kW
Maximum Static Pressure	10 Bar
Surface Mounted Only	
Approvals, Complies with	BEAB, CE, BSI Kitemark
Guarantee	2 years

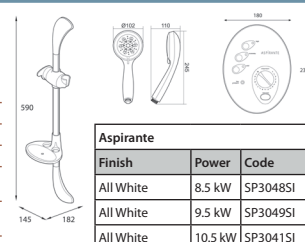

Aspirante	Finish	Power	Code
	All White	8.5 kW	SP3048SI
	All White	9.5 kW	SP3049SI
	All White	10.5 kW	SP3041SI
	White/Chrome	8.5 kW	SP3008SI
	White/Chrome	9.5 kW	SP3009SI
	White/Chrome	10.5 kW	SP3001SI

T300si	Finish	Power	Code
	Chrome	8.5 kW	ASP3008SI
	Chrome	9.5 kW	ASP3009SI
	Chrome	10.5 kW	ASP3001SI

† NOTE: Variations in pipework may affect flow rate figures at 0.1 bar