

Hamilton® Sheer CFX®

Concealed Fixing Accessories on Stylish Flat Plates

Sheer CFX® are simple and elegant, flat-plate switches and sockets. The range features Hamilton's patented CFX® 4 point face plate clipping system allowing concealed fixing for a clean and contemporary finish that looks stylish in any environment. Sheer CFX® also benefits from an integral gasket that forms part of the mounting frame, this is ideal for use on walls that are not perfectly flat.

- Minimalist, modern flat plate
- Six finishes
- Concealed fixing
- Integral gasket – ideal for imperfectly flat walls
- Grid Fix and Eurofix options also available (see separate GRID-IT and EuroFix sections)



87C 2X40



84C DTRID W



81C T22



89C SPN AB-B



84C 1X40



88C R22 BK-B

Hamilton Sheer CFX® Concealed Fixing

← Plate Depth 4.5 mm including gasket

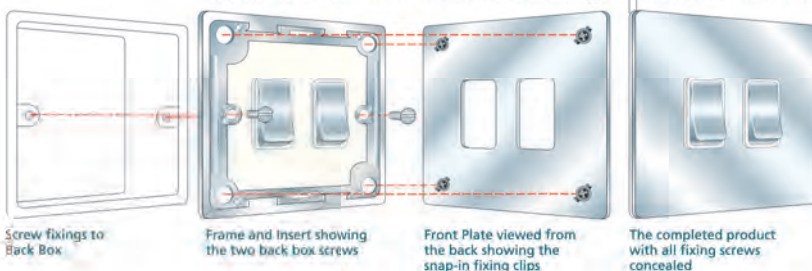

Hamilton® *fashion, finish, function and flexibility*

Hamilton Sheer CFX®

Concealed Fixing Double Pole Switches



**1 gang 20AX
Double Pole
Rocker + Neon**

Nominal Plate Size:
86 x 86 mm
Min. Wall Box
Depth: 25 mm
Technical Insert
Reference: **DPN**
Product Code



**1 gang 45A
Double Pole
Red Rocker +
Neon**

Nominal Plate Size:
86 x 86 mm
Min. Wall Box
Depth: 35 mm
Technical Insert
Reference: **45N**
Product Code



**45A Double Pole
Red Rocker +
Neon + 13A
Switched Socket**

Nominal Plate Size:
145 x 86 mm
Min. Wall Box
Depth: 35 mm
Technical Insert
Reference: **45SS1**
Product Code

Plate Finish	Insert Finish	Insert Surround Colour	1 gang 20AX Double Pole Rocker + Neon	1 gang 45A Double Pole Red Rocker + Neon	45A Double Pole Red Rocker + Neon + 13A Switched Socket
Bright Chrome 	Bright Chrome Bright Chrome Red Plastic Red Plastic	White Black White Black	87C DPN BC-W 87C DPN BC-B - -	- - 87C 45N W 87C 45N B	87C 45SS1 BC-W 87C 45SS1 BC-B - -
Polished Brass 	Polished Brass Polished Brass Red Plastic Red Plastic	White Black White Black	81C DPN PB-W 81C DPN PB-B - -	- - 81C 45N W 81C 45N B	81C 45SS1 PB-W 81C 45SS1 PB-B - -
Satin Brass 	Satin Brass Satin Brass Red Plastic Red Plastic	White Black White Black	82C DPN SB-W 82C DPN SB-B - -	- - 82C 45N W 82C 45N B	82C 45SS1 SB-W 82C 45SS1 SB-B - -
Antique Brass 	Antique Brass Red Plastic	Black Black	89C DPN AB-B -	- 89C 45N B	89C 45SS1 AB-B -
Satin Stainless 	Satin Stainless Satin Stainless Red Plastic Red Plastic	White Black White Black	84C DPN SS-W 84C DPN SS-B - -	- - 84C 45N W 84C 45N B	84C 45SS1 SS-W 84C 45SS1 SS-B - -
Black Nickel 	Black Nickel Red Plastic	Black Black	88C DPN BK-B -	- 88C 45N B	88C 45SS1 BK-B -