

Grommets in mm	A	B	B1	C	D
ESM 16	16.5	22	18.5	14.5	8.5
ESM 20	20.5	26	22.5	14.5	8.5
ESM 25	26.0	31	27.5	14.5	8.5
ESM 32	33.0	38	34.5	17.5	8.5
ESM 40	41.0	46	42.5	17.5	8.5

Grommets ESM

Degree of protection IP 55
Grommets ESM are inserted into knockouts. There is no counter nut required!

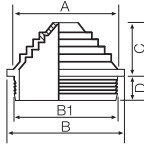
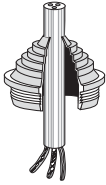

Stepped grommets in mm	A	B	B1	C	D
STM 16	13.2	21.2	19	7.4	8.0
STM 20	18.0	25	23	9.2	8.0
STM 25	21.6	30	28	11.5	7.4
STM 32	27.6	37	35	11.5	8.6
STM 40	33.6	45	43	15.1	8.6

Stepped grommets STM

Degree of protection IP 55
Stepped glands STM are inserted into knockouts. There is no counter nut required!

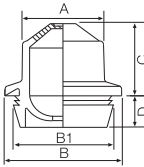
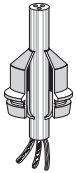

Grommets in mm	A	B	B1	C	D
EDK 16	14.5	22	18.5	13.5	8.5
EDK 20	18.5	26	22.5	14.5	8.5
EDK 25	23.5	31	27.5	14.5	8.5
EDK 32	30.5	38	34.5	19.5	8.5
EDK 40	38.5	46	42.5	19.5	8.5

Grommets EDK

Degree of protection IP 65
Grommets EDK are inserted into knockouts. There is no counter nut required!

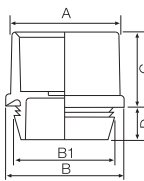
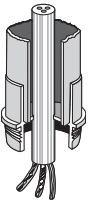

Grommets for conduits in mm	A	B	B1	C	D
EDR 16	20	22	18.5	14.5	8.5
EDR 20	24	26	22.5	14.5	8.5
EDR 25	29	31	27.5	14.5	8.5
EDR 32	36	38	34.5	17.5	8.5
EDR 40	44	46	42.5	17.5	8.5

Grommets for conduits EDR

Degree of protection IP 65
Grommets for conduits EDR are inserted into knockouts. There is no counter nut required!

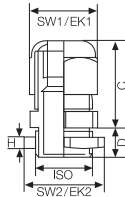
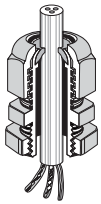

in mm	Cable glands AKM/ASS with strain relief counter nut, degree of protection IP 65							
	ISO	SW1 across flats	EK1 across corners Ø	C max.	D	SW2 across flats	EKS across corners Ø	H
AKM/ASS 12	M 12	15	16.4	22	8	17	19.0	5
AKM/ASS 16	M 16	20	22.0	26	8	22	24.7	5
AKM/ASS 20	M 20	24	26.5	29	8	27	30.2	6
AKM/ASS 25	M 25	29	32.0	34	8	32	36.0	6
AKM/ASS 32	M 32	36	39.7	39	10	41	46.0	7
AKM/ASS 40	M 40	46	50.5	46	10	50	54.1	7
AKM/ASS 50	M 50	55	60.0	51	10	60	66.3	8
AKM/ASS 63	M 63	68	74.7	55	10	75	83.0	8

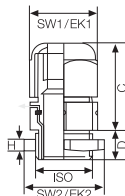
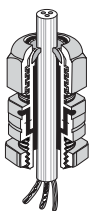

in mm	Combi climate glands KBM / KBS with strain relief counter nut, degree of protection IP 66 / IP 67							
	ISO	SW1 across flats	EK1 across corners Ø	C max.	D	SW2 across flats	EK2 across corners Ø	H
KBM/KBS 20	M 20	24	27.0	42	8	27	29.0	5
KBM/KBS 25	M 25	29	32.0	45	8	32	35.5	5
KBM/KBS 32	M 32	36	40.0	47	10	40	44.5	6
KBM/KBS 40	M 40	46	50.5	59	10	50	54.1	7

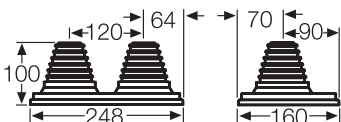

Flange MV FP 66

Degree of protection IP 55
for retrofitting onto boxes made of sheet steel material thickness ≥ 1.5 mm

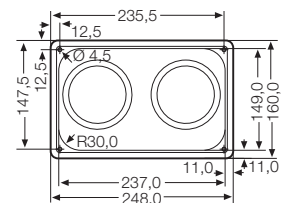

	ESM ... STM ... EDK ... EDR ... KST... MV FP 66	AKM ... ASS ...	AKS ... KBM ... KBS ...
Application area	Suitable for indoor installation (normal environment and/or protected outdoor)	Suitable for outdoor installation - harsh environment and / or outdoor	
Ambient temperature			
- Average value over 24 hours	+ 35 °C	+ 55 °C	+ 55 °C
- Maximum value	+ 40 °C	+ 70 °C	+ 70 °C
- Minimum value	- 25 °C	- 25 °C	- 25 °C
Fire protection in the event of internal faults	Demands placed on electrical devices from standards and laws: Minimum requirements - Glow wire test in accordance with IEC 60695-2-11: - 650 °C for boxes and Cable glands		
Burning behaviour			
- Glow wire test IEC 60695-2-11	750 °C	960 °C	960 °C
- UL Subject 94	flame-retardant self-extinguishing	V-0 flame-retardant self-extinguishing	V-2 flame-retardant self-extinguishing
Toxic behaviour	halogen-free silicone-free	halogen-free silicone-free	halogen-free silicone-free
	"Halogen-free" in accordance with IEC 60754-2 "Common test methods for cables - Determination of the amount of halogen acid gas". For material properties see technical data.		