



# CoreLine SlimDownlight

## DN145B LED20S/840 PSU II WH

LED Module, system flux 2000 lm - 840 neutral white - Power supply unit - Safety class II - White RAL9016

CoreLine SlimDownlight delivers on the CoreLine promise of innovative, easy-to-use and high-quality luminaires. The CoreLine SlimDownlight is an innovative range of recessed and surface-mounted luminaires. The high-quality CoreLine SlimDownlight is designed to replace existing downlight luminaires with CFL-ni/CFL-I lamp technology and provides even, natural lighting across multiple environments. With instant energy savings and a longer lifetime, this is an environmentally friendly and cost-saving solution. Simple and easy installation means that our recessed luminaire fits the same-size cut-out, while the minimal built-in depth of 34 mm makes this product an ideal space-saving solution, especially for projects with limited fitting space. Interact ready luminaires with integrated wireless communications, fully compatible with Interact gateways, sensors and software, are also available.

### Product data

General Information			
Number of light sources	1 [ 1 pc]	Luminaire light beam spread	84°
Lamp family code	LED20S [ LED Module, system flux 2000 lm]	Control interface	-
Light source colour	840 neutral white	Connection	Connection unit 2-pole
Light source replaceable	No	Cable	-
Number of gear units	1 unit	Protection class IEC	Safety class II
Driver/power unit/transformer	PSU [ Power supply unit]	Standard RAL colour	White RAL9016
Driver included	Yes	Glow-wire test	Temperature 650 °C, duration 30 s
Optic type	90 [ Beam angle 90°]	Flammability mark	F [ For mounting on normally flammable surfaces]
Optical cover/lens type	O [ Opal]	CE mark	CE mark

# CoreLine SlimDownlight

ENEC mark	ENEC mark
Warranty period	5 years
Remarks	* - According to the Lighting Europe guidance paper 'Evaluating performance of LED based luminaires – January 2018': statistically there is no relevant difference in lumen maintenance between the B50 and, for example, the B10. Therefore, the median useful life (B50) value also represents the B10 value.
Constant light output	No
Number of products on MCB (16 A type B)	13
EU RoHS compliant	Yes
Unified glare rating CEN	28

## Operating and Electrical

Input Voltage	220 to 240 V
Input frequency	50 or 60 Hz
Inrush current	28.9 A
Inrush time	0.0016 ms
Power factor (min.)	0.9

## Controls and Dimming

Dimmable	No
----------	----

## Mechanical and Housing

Housing material	Aluminium die-cast
Reflector material	-
Optic material	Polymethyl methacrylate
Optical cover/lens material	Polystyrene
Fixation material	-
Optical cover/lens finish	Opal
Overall height	28 mm
Overall diameter	215 mm
Colour	White RAL9016
Dimensions (height x width x depth)	28 x NaN x NaN mm (1.1 x NaN x NaN in)

## Approval and Application

Ingress protection code	IP20/44 [ Finger-protected; wire-protected, splash-proof]
-------------------------	---

Mech. impact protection code	IK02 [ 0.2 J standard]
------------------------------	------------------------

## Initial Performance (IEC Compliant)

Initial luminous flux (system flux)	2100 lm
Luminous flux tolerance	+/-10%
Initial LED luminaire efficacy	100 lm/W
Init. Corr. Colour Temperature	4000 K
Init. Colour rendering index	>80
Initial chromaticity	(0.38212,0.38031) SDCM<3
Initial input power	21 W
Power consumption tolerance	+/-10%

## Over Time Performance (IEC Compliant)

Control gear failure rate at median useful life 50,000 h	5 %
Lumen maintenance at median useful life* 50,000 h	L70

## Application Conditions

Ambient temperature range	0 to +35 °C
Performance ambient temperature Tq	25 °C
Maximum dimming level	Not applicable
Suitable for random switching	Yes

## Product Data

Full product code	871016333950499
Order product name	DN145B LED20S/840 PSU II WH
EAN/UPC – product	8710163339504
Order code	33950499
SAP numerator – quantity per pack	1
Numerator – packs per outer box	10
SAP material	911401806280
SAP net weight (piece)	0.520 kg



CoreLine SlimDownlight

Dimensional drawing

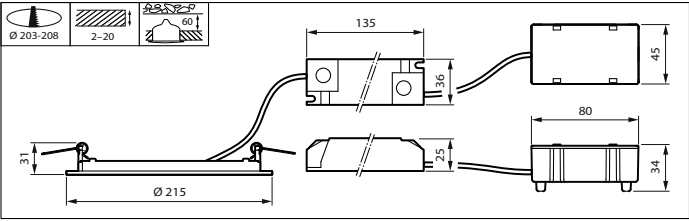

CoreLine SlimDownlight

Photometric data

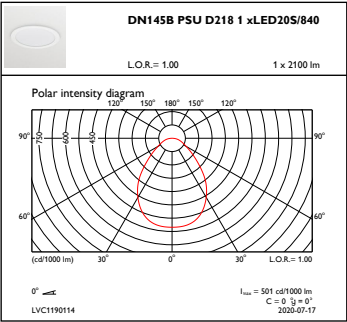

OFPC1\_DN145BPSUD2181xLED20S840

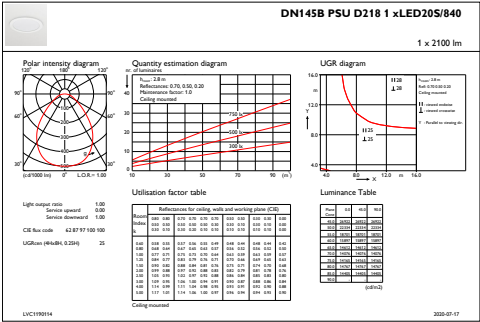

IFGU1\_DN145BPSUD2181xLED20S840

