

# STERLING CURVE

Sterling Curve Profile 1 and 2 are stylish curved perimeter dado and skirting systems that are easy and cost effective to use. Sterling Curve is a sleek data compliant medium sized trunking system with three segregated compartments. The adaptable system has 1 or 2 curved data compartments designed to stop clutter, avoid dust traps and to make cleaning easy.

## Product information

- 167 x 50mm
- 3 segregated compartments
- Suitable for dado and skirting application
- Boxes available to comply with Part M (DDA)
- Comprehensive range of flush power and data accessories
- Single piece moulded fittings
- Flat Tees and Flat Angles have integral bend radius control
- Profile 1 is available in charcoal as standard
- Self extinguishing and non-flame propagating PVC-U
- Fire clips available to secure cables within trunking and prevent premature collapse in the event of a fire

## Data information

- Compliant up to Cat 7a
- Standard bend radius 25mm
- Data fittings available for bend radius up to 50mm
- Compartment can be screened to assist against EMI with no reduction in cable capacity (refer to p103)
- Adjustable data box 32-40mm
- Screened data boxes
- Steel screening divider available to BS EN 50714-2

See  
page 81  
for quick  
reference  
chart

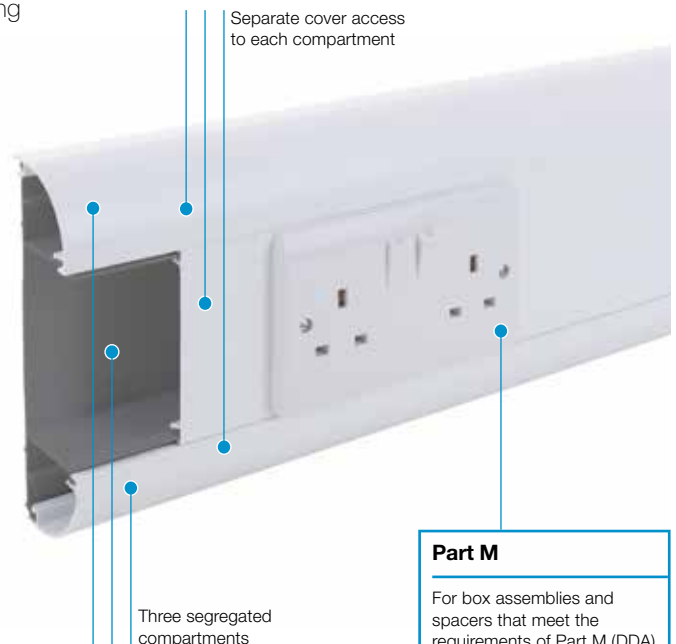

## Part M

For box assemblies and spacers that meet the requirements of Part M (DDA) please refer to page 54.



## Standard Colours

WH

CH

WH: White CH: Charcoal

**Colour options:** Charcoal solid colour option is available as standard item for selected Profile 1 fittings. Please indicate when ordering by replacing the WH colour code suffix with CH for charcoal.

## Trunking profiles



### Curve Profile 1 trunking assembly

code	size	pack
CEP1MWH	167 x 50mm	1 x 3m

Charcoal is available as standard for Profile 1



### Curve Profile 2 trunking assembly

code	size	pack
CEP2MWH	167 x 50mm	1 x 3m



REASSURINGLY RECYCLED

OUR WHITE STERLING CURVE BUILT UP PROFILES ARE MANUFACTURED USING THE FOLLOWING PERCENTAGES OF RECYCLED MATERIAL.

PROFILE 1 66%  
PROFILE 2 60%

## Basic components



### Base unit

code	pack
ETB1M	4 x 3m

Please note the colour of the unseen base ETB1M may vary



### Main compartment cover

code	pack
ETL1WH	8 x 3m

Charcoal is available as standard



### Curve cover

code	pack
CETC1WH	8 x 3m

Charcoal is available as standard



### Square cover

code	pack
ETSC1WH	8 x 3m

## Firefly clips



NEW

**Fire clip Sterling centre compartment**

code	pack
FCSPC	50



NEW

**Fire clip Sterling angle & curve compartment**

code	pack
FCSPAC	100



NEW

**Fire clip Sterling square compartment**

code	pack
FCSPS	100



NEW

Don't forget, Firefly clips to comply with the current edition of BS 7671 Wiring Regulations

See page 141 for more information

## Boxes and plates

**\*RCD/MCB Housing**

code	pack
EAHC1MWH	1

Not available in charcoal  
\*Up to 4 modules can be accommodated

**Note:** RCDs are not supplied by Marshall-Tufflex

**1 gang accessory box**

code	depth	pack
ESSB1WH	30mm	20

**2 gang accessory box**

code	depth	pack
ESSB2WH	30mm	10

**Accessory box spacer**

code	size	pack
ES1WH	14mm	4

For use between accessory boxes

**1 gang adjustable depth box**

code	depth	pack
EAB1WH	32 – 47mm	10

**2 gang adjustable depth box**

code	depth	pack
EAB2WH	32 – 47mm	5

**1 gang accessory plate**

code	pack
ESSP1WH	2

**2 gang accessory plate**

code	pack
ESSP2WH	2

Please see page 261 for more information on the range of adjustable boxes

## Screening

**Steel screening divider**

code	pack
ESF1	1 x 1.5m

**Note:** optional steel screening divider to assist in compliance with BS EN 50174-2

**Steel screening divider bonding strap**

code	pack
ESF2	5

**Bonding strap**

code	pack
ESBS1	5

**1 gang screened accessory box**

code	depth	pack
ESSB1SWH	30mm	20

**2 gang screened accessory box**

code	depth	pack
ESSB2SWH	30mm	10

**Screening**

Conductive spray (CS) is unique to Marshall-Tufflex and is applied in the factory to assist in screening from electromagnetic interference to data and communications cabling within trunking systems. The coating is applied to a range of data boxes, covers, clip-on components and fabricated fittings.

**WARNING:** A CS coating is not suitable for low voltage circuits. As per the current version of BS 7671 wiring regulations. For data/voice use only.

**Screened compartments key to coding**

CS13 = screening in compartments 1 and 3

p248

Technical  
Information

## Curve Profile 1 fittings

**Curve Profile 1  
Coupler**

code	pack
CECP1MWH	2

Charcoal is available as standard

**Curve Profile 1  
End cap**

code	pack
CEEC1MWH	2

Charcoal is available as standard

**Curve Profile 1  
Internal bend**

code	pack
CEIB1MWH	2

Charcoal is available as standard

**Curve Profile 1  
External bend**

code	pack
CEXP1MWH	2

Charcoal is available as standard

**Curve Profile 1  
Flat angle cover (ABS)**

code	pack
CEFA1MWH	1

Charcoal is available as standard

**Curve Profile 1  
Flat angle complete (ABS)**

code	pack
CEFA1MBWH	1

Charcoal is available as standard

**Curve Profile 1  
Flat tee cover (ABS)**

code	pack
CEFT1MWH	1

Charcoal is available as standard

**Curve Profile 1  
Flat tee complete (ABS)**

code	pack
CEFT1MBWH	1

Charcoal is available as standard

## Curve Profile 2 fittings

**Curve Profile 2  
Coupler**

code	pack
CECP2MWH	2

**Curve Profile 2  
End cap**

code	pack
CEEC2MRHWH (right)	2
CEEC2MLHWH (left)	2

**Curve Profile 2  
Internal bend**

code	pack
CEIB2MWH	2

**Curve Profile 2  
External bend**

code	pack
CEXP2MWH	2

**Curve Profile 2  
Flat angle up cover (ABS)**

code	pack
CEFA2UMWH	1

**Curve Profile 2  
Flat angle up complete (ABS)**

code	pack
CEFA2UMBWH	1

**Curve Profile 2  
Flat tee up cover (ABS)**

code	pack
CEFT2MWH	1

**Curve Profile 2  
Flat tee up complete (ABS)**

code	pack
CEFT2MBWH	1

## Components

**Main crossover bridge**

code	pack
EMCB1	5

**Angled cable retainer**

code	pack
EACR1	10

p248

Technical  
Information

## Sterling Curve Trunking

Sterling Curve features a host of practical features for quick and easy installation

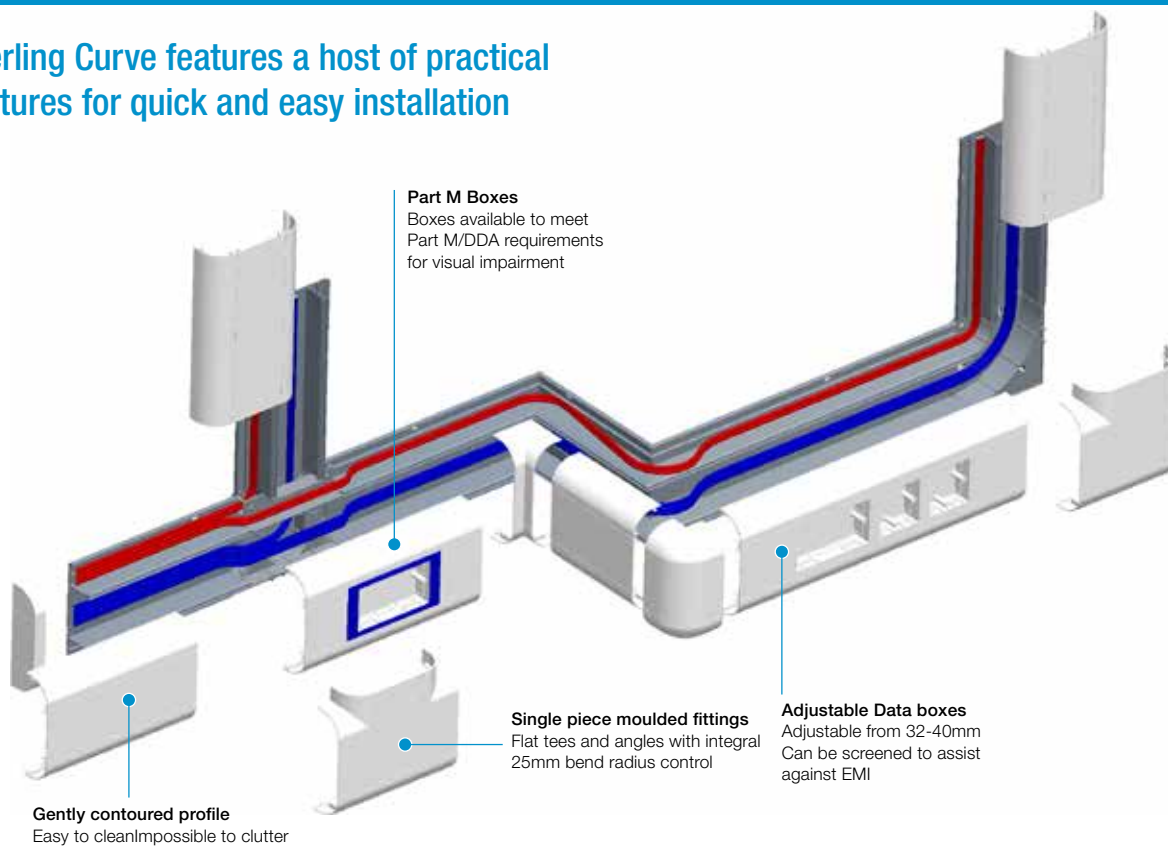

Our PVC-U products have been  
**MANUFACTURED USING  
 80% RECYCLED MATERIAL.**

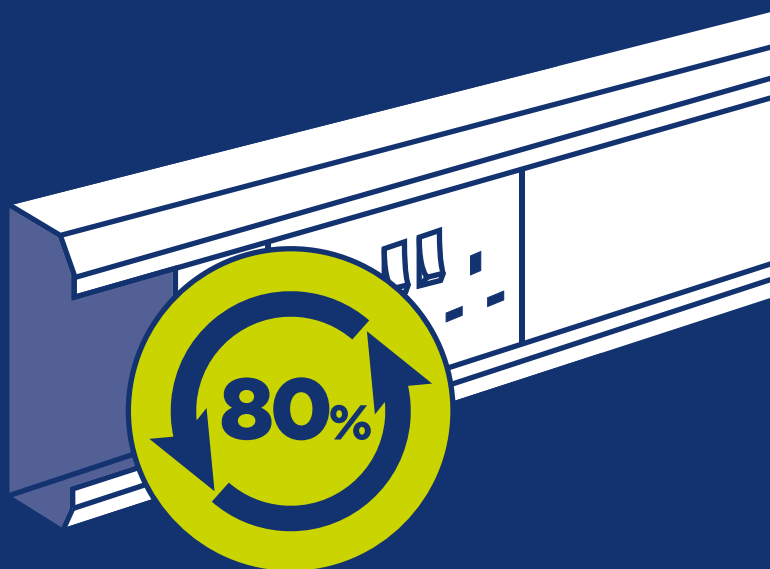

**REASSURINGLY  
 RECYCLED**