

REPLACEMENT BATTERY TYPE:

3.6V 3.0Ah Ni-CD.

BATTERY REPLACEMENT:

If after routine operation check, the lamp does not remain lit for the three hour period, a new battery pack may be required.

- 01) Switch off the electricity at the mains.
- 02) Allow batteries to fully discharge then reconnect to supply and allow to charge for 24 hours.
- 03) Test again for 3 hours, if light does not remain lit change the battery pack as follows:
- 04) Isolate the mains supply to the unit.
- 05) Remove the cover of emergency pack.
- 06) Unplug the battery lead.
- 07) Remove the battery pack.
- 08) Write current date on the new emergency pack.
- 09) Fit new battery pack.
- 10) Replace cover.
- 11) Restore power and allow to charge for 24 hours.
- 12) Perform operation check and update test record.

IMPORTANT NOTES:

The ballast and control gear must be operated only within the enclosure supplied. The gear must not be operated outside of the enclosure.

The battery charging circuit and DC ballast are separated from the mains by at least basic (single layer) insulation.

When energised by a constant mains supply, the battery will be constantly charged whether or not the lamp is illuminated. On failure of the constant mains supply, the fitting will switch automatically using transistorised switching from battery charging to battery discharge powering the lamp whether or not the lamp was illuminated before the power failure. Both the mains and battery supplies incorporate fuse protection: see fitting for location and rating.

If battery short circuits on battery terminals then fuse needs to be replaced before recharging.

Ballast is proofed against polarity reversal.

EVENTUALLY, YOU MAY WANT TO REPLACE THIS PRODUCT:

Regulations require the recycling of Waste from Electrical and Electronic Equipment (European "WEEE Directive" effective August 2005—UK WEEE Regulations effective 2nd January 2007). Environment Agency Registered Producer: WEE/GA0248QZ.

WHEN YOUR PRODUCT COMES TO THE END OF ITS LIFE OR YOU CHOOSE TO REPLACE IT, PLEASE RECYCLE IT WHERE FACILITIES EXIST - DO NOT DISPOSE WITH HOUSEHOLD WASTE.

INDUSTRIAL BATTERIES:

Within certain products Eterna Lighting Ltd places lead acid, lithium ion, nickel cadmium & nickel metal hydride batteries on the market. Industrial batteries are subject to waste regulation under the Waste Batteries and Accumulators Regulations 2009 and should be disposed of responsibly. Purchasers may be able to dispose of their waste industrial batteries locally via legitimate licensed trade waste contractors. Eterna is obliged to take back, free of charge and within a reasonable time, waste industrial batteries of the same chemistry supplied to a Purchaser, for treatment and recycling and is required to do this in any calendar year new industrial batteries are placed on the market. In certain circumstances, this may include batteries not originally supplied by Eterna. If any Purchaser requires Eterna to take back Industrial batteries, they should write to the Operations Director, Eterna Lighting Ltd, Huxley Close, NN8 6AB, who will then advise on the necessary arrangements for the receipt, proper treatment and recycling of, the waste industrial batteries.

CLEANING:

Clean this fitting only with a soft dry cloth.

Do not use any chemical or abrasive cleaners.

IF YOU EXPERIENCE PROBLEMS:

If you believe your product is defective, please return it to the place where you bought it. Our Technical Team will gladly advise on any Eterna Lighting product, but may not be able to give specific instructions regarding individual installations.



INSTALLATION INSTRUCTIONS

A guide for qualified electricians

3 HOURS DURATION IN EMERGENCY MODE

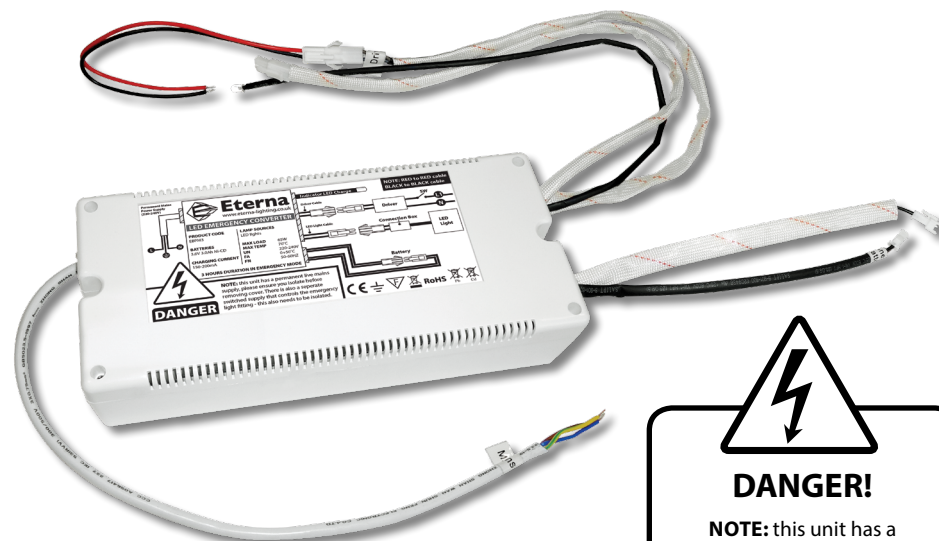

Pack contents:
1 x Emergency pack
1 x Maintenance check record

Model:
EBPM3



DANGER!

NOTE: this unit has a permanent live mains supply, please ensure you isolate before removing cover. There is also a separate switched supply that controls the emergency light fitting - this also needs to be isolated.

Emergency Pack For Commercial LED Downlights & LED Panel Lights

These instructions are provided as a guideline to assist you.

PLEASE READ THESE INSTRUCTIONS BEFORE INSTALLATION AND RETAIN FOR FUTURE REFERENCE

Email: sales@eterna-lighting.co.uk / technical@eterna-lighting.co.uk

Visit our website: www.eterna-lighting.co.uk

Made in China

Issue 0516

READ THIS FIRST:

Check the pack and make sure you have all of the parts listed on the front of this booklet. If not, contact the outlet where you bought this product.

This fitting must be installed by a competent person in accordance with the current building and IEE wiring regulations.

As the buyer, installer and/or user of this product it is your own responsibility to ensure that this fitting is fit for the purpose for which you have intended it. Eterna Lighting cannot accept any liability for loss, damage or premature failure resulting from inappropriate use.

Switch off the mains before commencing installation and remove the appropriate circuit fuse or lock of MCB.

Disconnect from the electrical supply before flash or high voltage testing.

This unit is suitable for indoor use only.

Do not cover the fitting with any insulating materials.

This product is designed for permanent connection to fixed wiring: this should be a suitable circuit (protected with the appropriate MCB or fuse)

When making connections, ensure that the terminals are tightened securely and that no strands of wire protrude. Check that the terminals are tightened onto the bared conductors and not onto any insulation.

This product must be connected to Earth termination.

Make connections to the electrical supply in accordance with the following code:

Live: Brown or Red (L)
Neutral: Blue or Black (N)
Earth: Green and Yellow (E)

You are advised at every stage of your installation to double-check any electrical connections you have made. After you have completed your installation there are electrical tests that should be carried out: these tests are specified in the Wiring Regulations (BS7671) referred to in the Building Regulations.

The batteries supplied with this fitting are a consumable part and therefore may be outside of any warranty offered.

INSTALLATION:

DANGER! Please note that there are two live supplies, one switched and one permanent; please ensure you isolate both before you undertake any work on the emergency fitting.

This emergency pack is designed for use with the Eterna General Purpose Downlight and Panel Light.

01. Switch off the mains before commencing installation and remove the appropriate circuit fuse or MCB.
02. Site the emergency pack within one metre of the luminaire to be converted.
03. Connect a permanent live supply to the emergency pack & connect the battery cables.

LED PANEL LIGHT INSTALLATION:

NOTE: Before commencing installation or maintenance ensure that the mains supply is isolated and locked off.

NOTE: If using with surface mount (SURFMK), remove control gear from box.

1. Remove the cable from the driver supplied.
2. Connect the cable from the panel / downlight to the supplied connection box.
3. Connect the emergency pack output trailing lead marked "LED Light" to the connection box making sure the polarity is observed.
4. Connect the emergency pack lead marked "LED Driver" to the output side of the driver which was supplied with the panel / downlight.
5. Connect 240V mains switch supply to the input side of the driver.
6. Connect a permanent 240V mains supply to the emergency pack.
7. Connect the two battery leads from the pack.
8. Insert the green LED indicator into the 5mm hole and secure in place using a cable tie; the green LED should be visible when the light is on.
9. Mark the installation date on the battery pack.
10. Restore power; a green indicator light will be present to show that the batteries are charging.

NOTE: For non-maintained operation do not connect a switched supply to the fitting.

OPERATION CHECKS:

Periodic testing should be carried out to ensure emergency lighting is operating correctly. Interruption of the supply, causing the fitting to be energised from the battery, should be carried out by the operation of a local keyswitch or other isolation device. During this period all fittings should be examined visually to ensure that they are functioning correctly. At the end of the test period the supply shall be restored and all indicator lamps or devices checked to ensure that the normal supply has been restored.

DAILY:

Visual inspection of the battery charge LED.

EACH MONTH:

Isolate the power supply for a period sufficient to ensure that each lamp is illuminated. Endorse the test record form supplied.

ONCE EACH YEAR:

Isolate the power supply and check that the light is still illuminated after 3 hours. Endorse the test record form.

Because of the possibility of a failure of the normal lighting supply occurring shortly after a period of testing of the emergency lighting system or during the subsequent recharge period, all full duration tests shall wherever possible be undertaken preceding time of low risk to allow for battery recharge.

NOTE: please keep this instruction booklet and the test record in a safe place. A fire officer or other authorised person may want to see your record of inspection and testing.

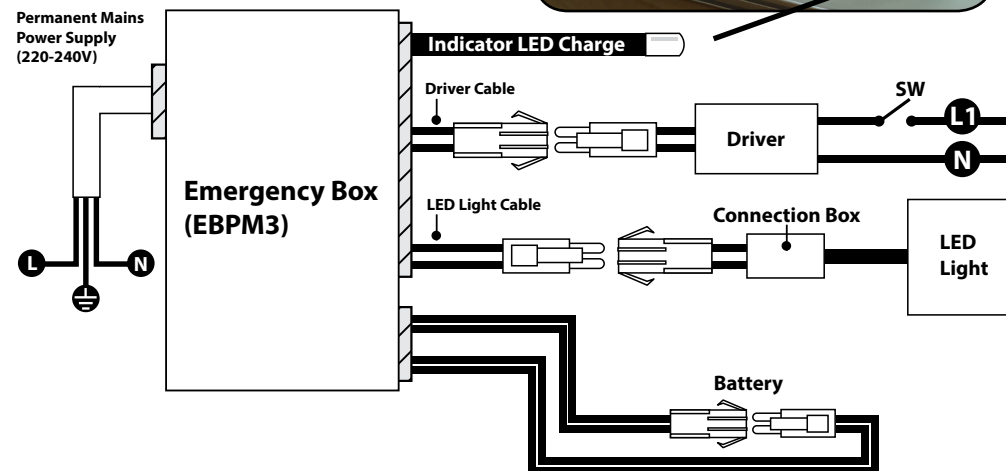
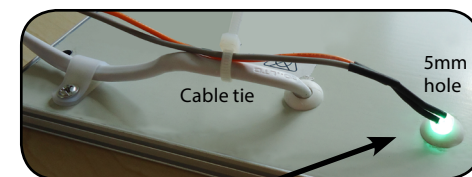
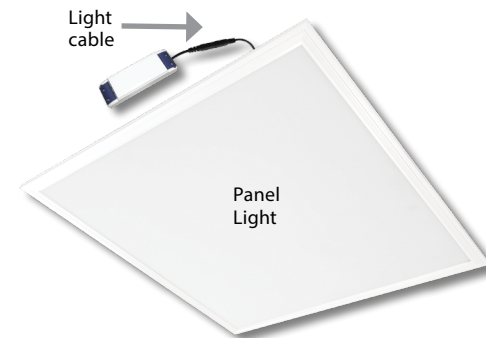



INSTALLATION, MAINTENANCE AND OPERATION CHECK RECORD

Installed
By:

[illegible]

Eterna EBPM3 + LED Panel Wiring Instructions

www.eterna-lighting.co.uk NN8 6AB UK

Email: sales@eterna-lighting.co.uk

Email: technical@eterna-lighting.co.uk

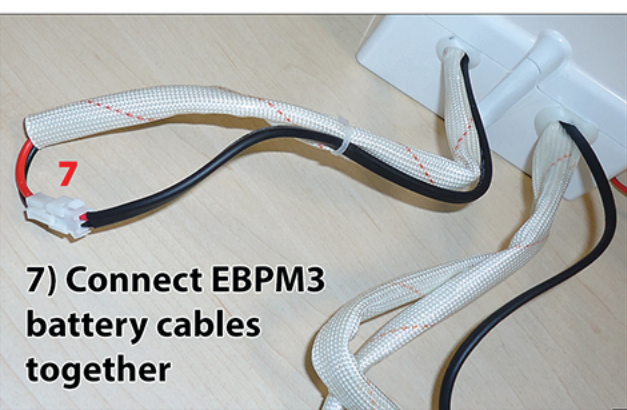
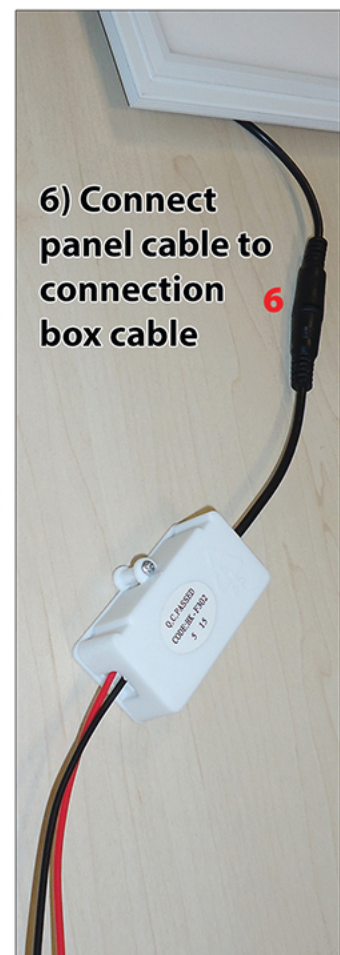
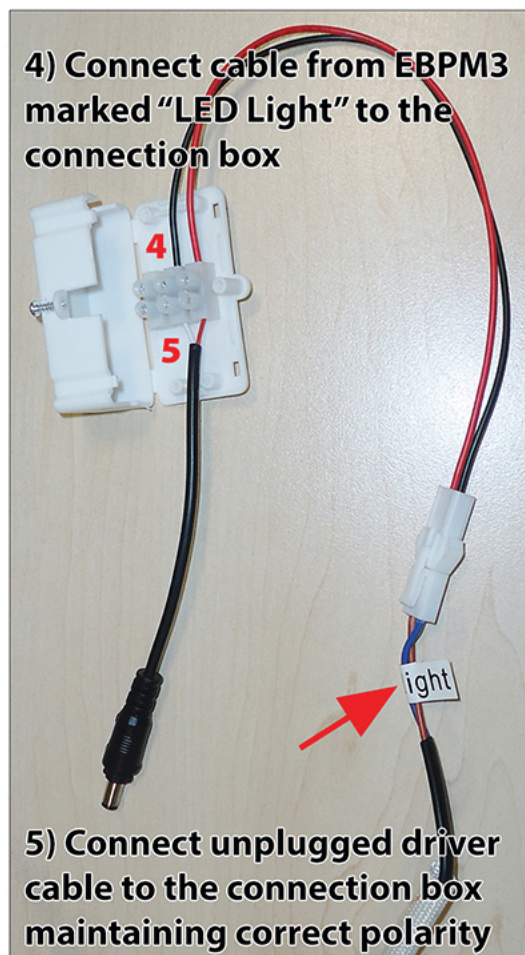
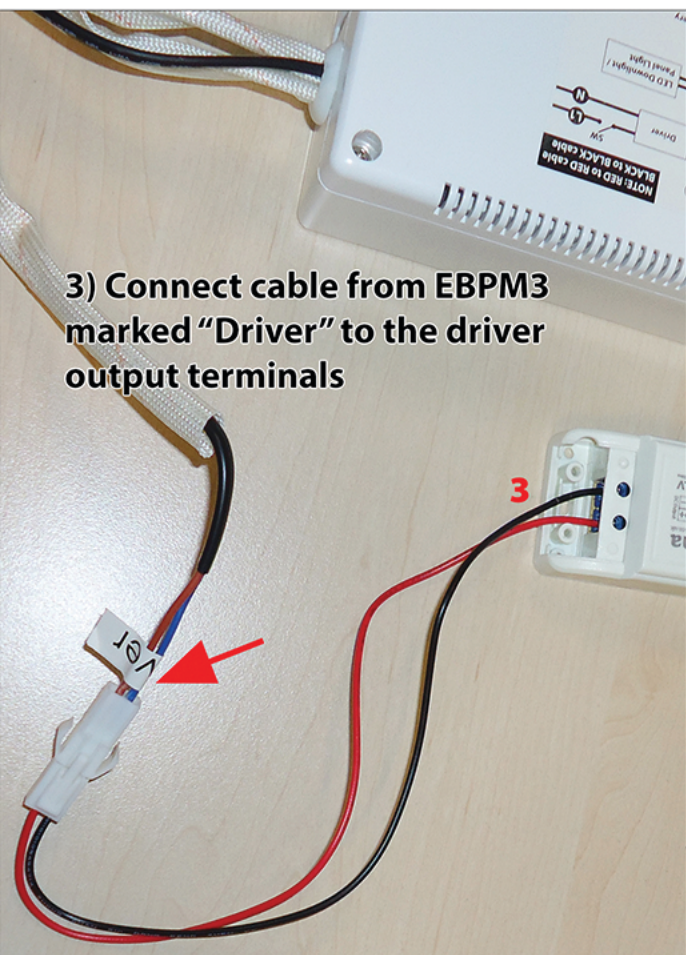
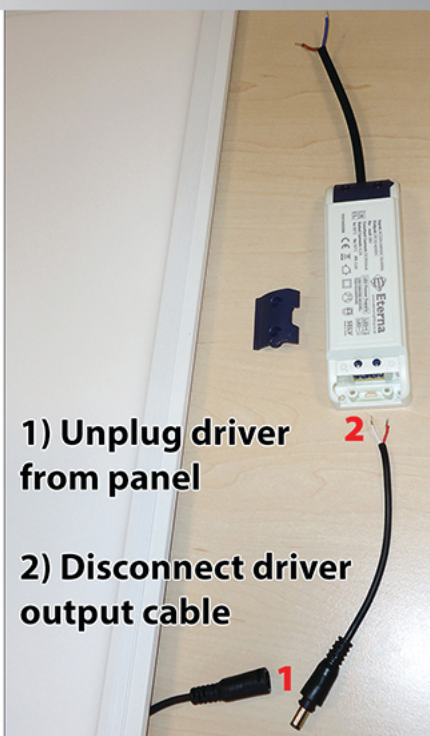
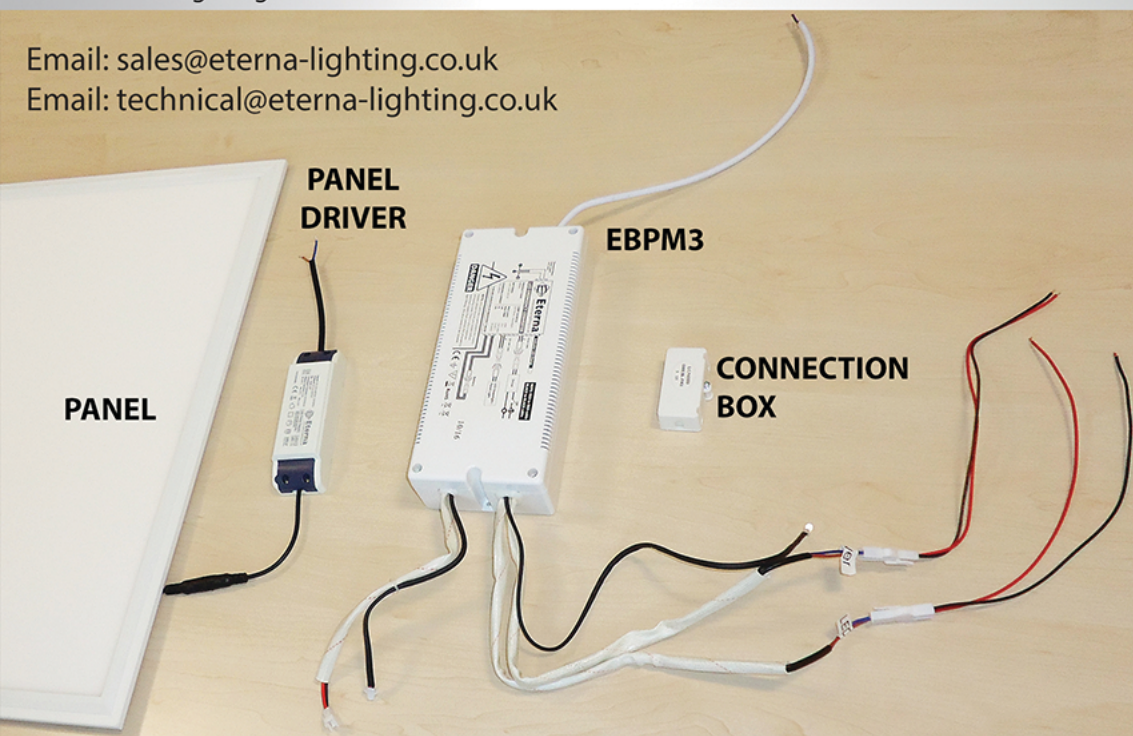

8) Connect 240V permanent mains supply to the battery pack and connect 240V mains switched supply to the driver input

9) Insert the green LED indicator into the 5mm hole and secure in place using a cable tie

10) Mark the installation date on the battery pack

11) Restore power; the green indicator light will be present to show that the batteries are charging