

Product End of Life Instructions

PrismaSeT Wireless Panel Server



Potential disassembly risks

Risk of electric shock due to secondary electrical components connected.

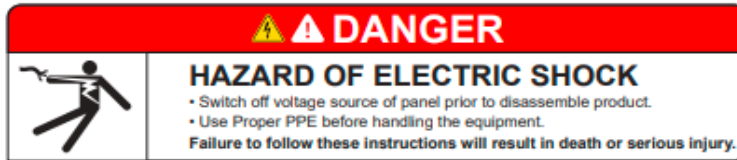

This product PCB Board electronics components materials which are recommended to be treated separately during the End of Life operations.

There are several steps to process the products at the end of life so as to recover components, materials or energy :

Reuse --> Depollution --> Dismantling --> Shredding

End of Life Instructions

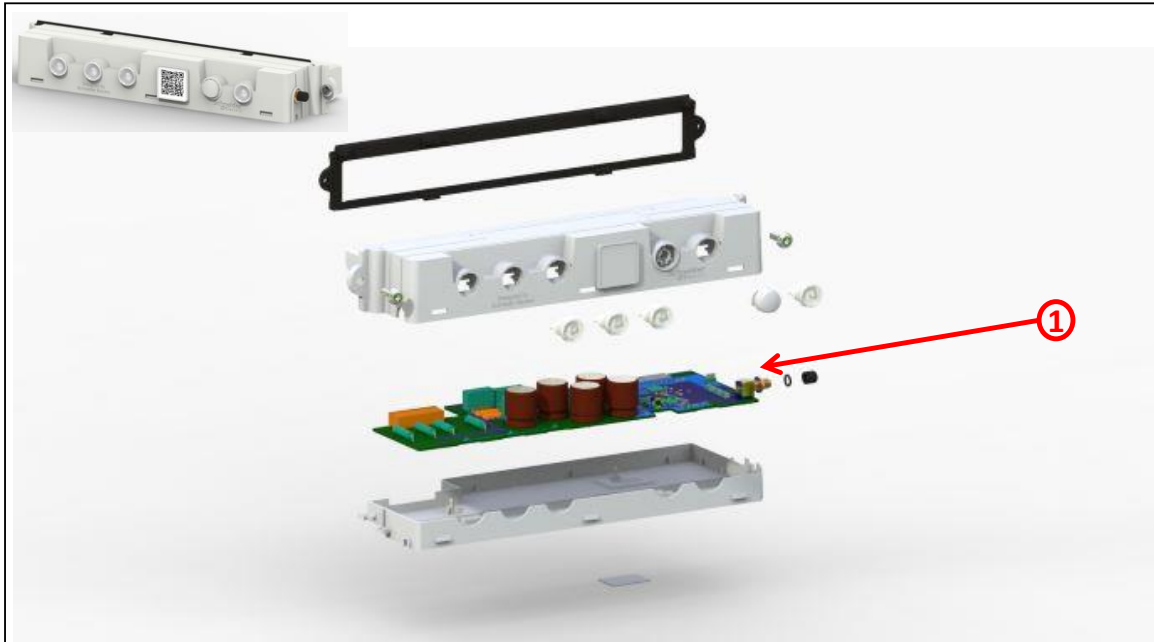

Recommendation	Number on drawing	Component / Material	Weight (in g)	Comment
To be depolluted	1	Electronic Board (Communication) > 10cm ²	124.5	PCBA Board



Product description

Manufacturer identification	Schneider Electric Industries SAS
Brand name	SCHNEIDER ELECTRIC
Product function	<p>DPAS is the gateway module which act as voltage loss indicator and sends the voltage loss information through LoRa network. Also it acts as Zigbee to Lora gateway to send critical alarms and measurements of connected sensors.</p> <p>Upstream Interface : LoRa Downstream Interface : Zigbee Commisioning interface : BLE Operating Temperature : -10 to 70 C Operating Voltage : 230V +/- 15% Operating Current : 10mA</p>
Product reference	SMT10019
Total representative product mass	335 g
Representative product dimensions	275 mm X 90 mm X 40.5 mm
Accessories	No
Date of information release	01/2021



Additional information

Legal information	This product family is in the scope of European Union directive 2012/19/EU on Waste Electrical and Electronic Equipment (WEEE). The product family must be disposed according to the legislation of the country. This document is intended for use by end of life recyclers or treatment facilities. It provides the basic information to assure an appropriate end of life treatment for the components and materials of the product.	
Recyclability potential	38%	Based on "ECO'DEEE recyclability and recoverability calculation method" (version V1, 20 Sep. 2008 presented to the French Agency for Environment and Energy Management: ADEME).

Schneider Electric Industries SAS
Country Customer Care Center
<http://www.schneider-electric.com/contact>

35, rue Joseph Monier
CS 30323

F- 92506 Rueil Malmaison Cedex
RCS Nanterre 954 503 439
Capital social 896 313 776 €

www.schneider-electric.com

ENVEOLI2101008_V1

Published by Schneider Electric

© 2019 - Schneider Electric – All rights reserved

01/2021