

## HAZARDOUS LOCATION LED LIGHTS, STRIP



### APPLICATION

Hazardous Location LED Strip Lights provide enclosure illumination in hazardous environments. These lights are ideal for remote and darkened enclosure applications in Class 1, Division 2 hazardous areas. With a robust design, these lights have a life span of 100,000 hours and superior lighting performance with easy field angle adjustment brackets. These versatile, lightweight LED lights provide mounting flexibility and are easy to install in an enclosure.

### FEATURES

- Direct transfer of heat from PCB to the casing to maximize lifetime and reliability
- Operating temperature of -40 F (-40 C) to 140 F (60 C)
- Easy installation with included mechanical assembly kit while maintaining enclosure rating up to UL Type 4X
- Includes 3-ft connect cable with flying leads
- Maximum lighting for control panels with 578 to 2,351 lumens and 5,000K color temperature
- Linear drive circuit with no flicker or high frequency electronic noise
- Easy field angle adjustment with mounting bracket
- Wide beam optics with 100 degree angle of illumination
- Available in 12, 24, 36, and 48-inch lengths

### INDUSTRY STANDARDS

UL 844 Listed; File No. E492323  
cUL Listed per CSA C22.2 No. 137; File No. E492323  
Class I, Division 2 Groups A, B, C, D, T4\*; Class II, Division 2, Groups F, and G, T6; Class III; Class I, Zone 2, Group IIC; Zone 22

IEC 60529, IP66/67

\*T3C for simultaneous exposure rating, Class I Div. 2 & Class II, Div. 2

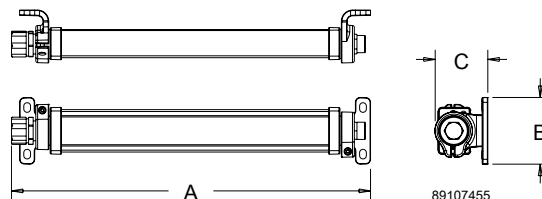

### BULLETIN: HLY

### Standard Product

Catalog Number	AxBxC in./mm	Description	Weight (lbs.)	Weight (kg)	VDC	Amps	Power	Lumens
LEDHL24V12	15.46 x 2.20 x 2.78 393 x 56 x 71	LED Light, 12-in.	1.8	.8	22-28	.4	11W	578
LEDHL24V24	26.46 x 2.20 x 2.78 672 x 56 x 71	LED Light, 24-in.	2.6	1.2	22-28	.75	21W	1172
LEDHL24V36	37.46 x 2.20 x 2.78 952 x 56 x 71	LED Light, 36-in.	3.9	1.8	22-28	1.1	32W	1758
LEDHL24V48	48.46 x 2.20 x 2.78 1231 x 56 x 71	LED Light, 48-in.	5.3	2.4	22-28	1.5	42W	2351

HAZARDOUS LOCATION LED LIGHT, CAN



INDUSTRY STANDARDS

ETL Listed  
Class I Division 2, Groups A, B, C and D, T3  
Conforms To CSA.22.2 No. 137, 213, 250 Standards  
Conforms To UL 844 & 1598 Standards  
Conforms to ISA-12.12-01  
Maintains enclosure Type 4, 4X rating when properly installed

APPLICATION

Hazardous Location LED CAN Light provides efficient indoor or outdoor illumination in hazardous environments. This light is ideal for Class 1, Division 2 hazardous areas. With a robust design, this light has a projected lifespan of 100,000 hours and superior lighting performance with minimal power consumption. This versatile, durable LED light provides mounting flexibility and is easy to install.

FEATURES

- Robust construction design for suitable outdoor applications; IP66
- Minimum power consumption and superior lighting with 12-24 VDC power input
- Maximum lighting with 469 lumens output
- 360-degree rotation allows flexible and versatile mounting
- Wide beam optics with 100-degree angle of illumination

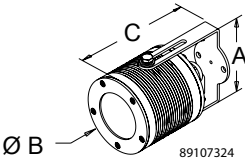

BULLETIN: HLY

Standard Product

Catalog Number	AxBxC in./mm	Description	Weight (lbs.)	Weight (kg)	VDC	Amps	Power	Lumens
LEDHL24VCAN	3.74 x 3.48 x 5.62 95 x 88 x 143	LED Light, CAN	2.3	1.0	12 - 24	.66A @ 12VDC .35A @ 24VDC	7.9W @ 12VDC 8.4W @ 24VDC	469

REPLACEMENT HARDWARE KIT FOR HAZARDOUS LOCATION LED LIGHTS

Replacement Hardware Kit is available for the replacement of lost or damaged hardware supplied with Hazardous Location LED lights. Kit includes bracket adapter plate, all mounting hardware and complete instructions.

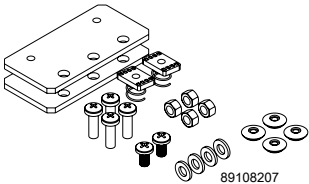

BULLETIN: HLY

Catalog Number	Description
AHKC1D2LED	Replacement Hardware Kit

HAZARDOUS LOCATION DOOR SWITCH



INDUSTRY STANDARDS

**Switch Rating**  
Explosion-proof for Class 1, Division 2, Groups A, B, C, and D

APPLICATION

The Hazardous Location Door Switch is designed to be used with Hoffman Hazardous Location LED Lights in Class 1, Division 2 hazardous areas. The included hardware kit allows the door switch to easily be mounted and maintain the enclosure rating up to UL Type 4X. This versatile switch activates the LED light when the enclosure door is opened and can be mounted on any flange of the enclosure. The included five-foot connect cable allows ease of wiring to the enclosure back panel.

BULLETIN: HLY

Catalog Number	Description	Rated Current/Voltage	Operating Temperature	Max. load
LEDHLSWITCH	Door Switch, C1D2	5A / AC 250V 0.25A / DC 250V	-4F (-20C) to 194F (90C)	5 Amps at 30 VDC