

CEO BS88 Offset bolted tags fuse links



Product description

Eaton's Bussmann® series CEO British Standard fuse links, size A4, are specifically designed for the protection of general industrial applications e.g. power distribution, cable protection, motor protection.

Standard features

- Good peak let-through current limitation
- 1:1:6 Selective coordination ratio between "minor" and "major" fuse
- Suitable for motor protection if gM type selected
- Power loss values well within the limits of IEC 60269-2

Catalogue symbol:

- CEO (Amps)

Technical data:

- Rated voltage: 500 V a.c. (gG) / 415 V a.c. (gM)
- Rated current: 32 to 100 A
- Breaking capacity: 80kA a.c.
- BS reference: A4
- Breaking range and utilisation category: gG and gM

Standards/approvals:

- BS88-2
- IEC 60269-2
- Suitable for use in RoHS compliant applications

Fuse holder (ordered separately)

- RS100H (Red Spot)

Packaging:

- MOQ 10

Table 1. Technical data

| Part number | Voltage | Current rating (amps) | Energy integrals I ² t (A ² S) | | Watts loss | Weight |
|-------------|------------|-----------------------|--|---------------|------------|--------|
| | | | Pre-arcing | Total at 415V | W | |
| CEO32 | 500 V a.c. | 32 | 1000 | 2760 | 3.5 | 75g |
| CEO40 | 500 V a.c. | 40 | 1400 | 3750 | 4.7 | 75g |
| CEO50 | 500 V a.c. | 50 | 3000 | 8350 | 4.9 | 75g |
| CEO63 | 500 V a.c. | 63 | 7000 | 18,800 | 5.6 | 75g |
| CEO80 | 500 V a.c. | 80 | 13,000 | 35,200 | 7.2 | 75g |
| CEO100 | 500 V a.c. | 100 | 25,000 | 76,500 | 8.5 | 75g |
| CEO100M125 | 415 V a.c. | 100M125 | 57,000 | 150,000 | 6.5 | 100g |
| CEO100M160 | 415 V a.c. | 100M160 | 72,500 | 190,000 | 5 | 100g |
| CEO100M200 | 415 V a.c. | 100M200 | 120,000 | 290,000 | 3.5 | 195g |

Dimensions - mm

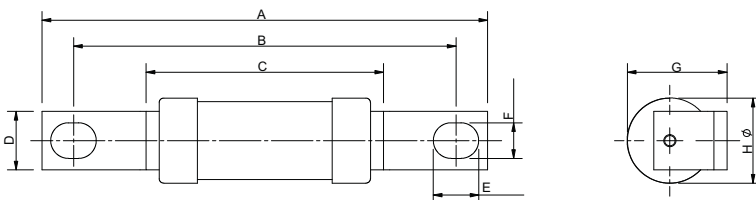

| Catalogue numbers | A | B | C | D | E | F | G | H |
|-------------------|-------|----|------|------|----|-----|------|------|
| CEO32-100 | 109.5 | 94 | 58.5 | 14.3 | 11 | 8.7 | 24.5 | 21 |
| CEO100M125-160 | 109 | 94 | 58 | 14.3 | 11 | 8.7 | 26.8 | 25.8 |
| CEO100M200 | 110 | 94 | 47 | 19 | 10 | 9 | 29.5 | 31 |

Time current curve - CEO32 to CEO100 A

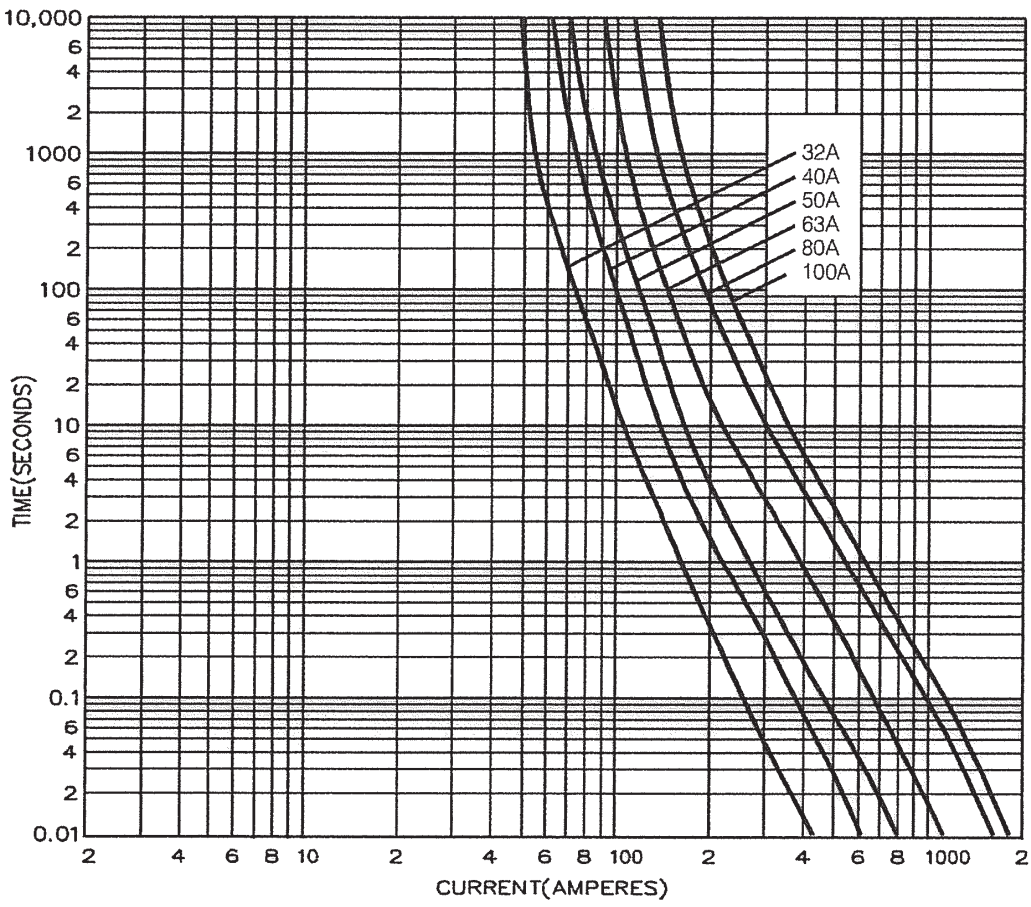

Time current curve - CEO100M

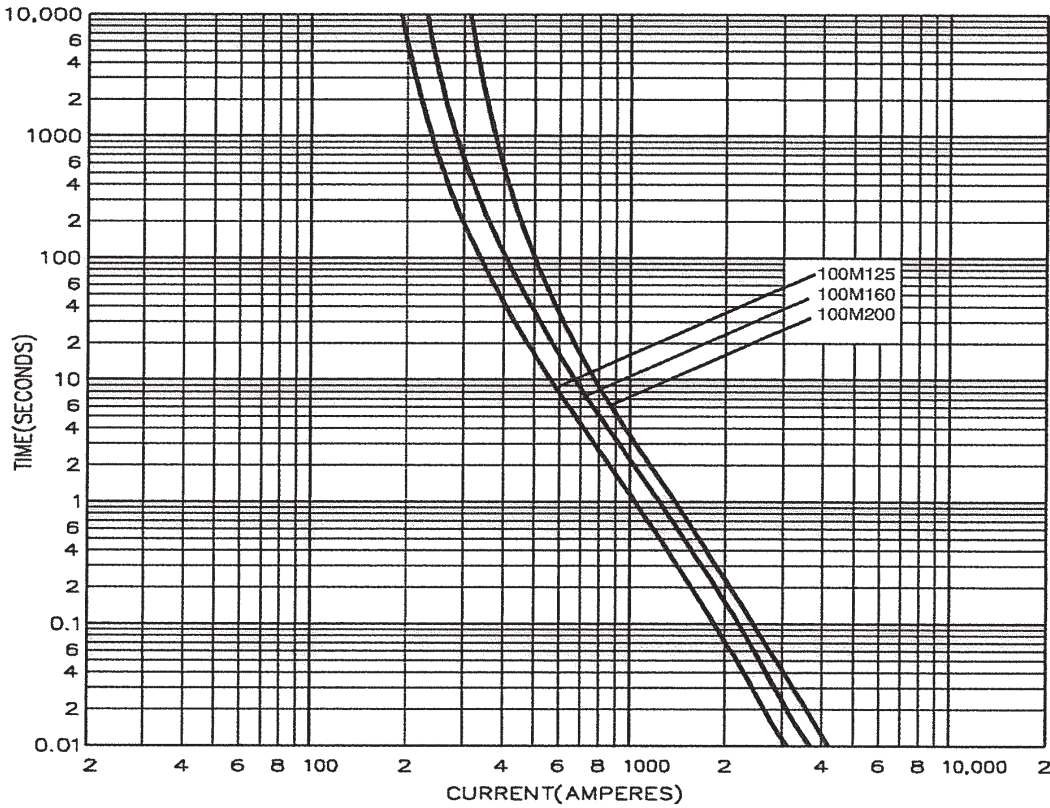

Changes to the products, to the information contained in this document, and to prices are reserved; so are errors and omissions. Only order confirmations and technical documentation by Eaton is binding. Photos and pictures also do not warrant a specific layout or functionality. Their use in whatever form is subject to prior approval by Eaton. The same applies to Trademarks (especially Eaton, Moeller, and Cutler-Hammer). The Terms and Conditions of Eaton apply, as referenced on Eaton Internet pages and Eaton order confirmations.

Eaton
 EMEA Headquarters
 Route de la Longeraie 7
 1110 Morges, Switzerland

Eaton Electrical Products Limited
 Melton Road
 Burton-on-the-Wolds
 Leicestershire, LE12 5TH
 United Kingdom

© 2017 Eaton
 All Rights Reserved
 PDF Only
 Publication No. 4115
 October 2017