

03/21 IL014053ZU

EN 62208 - Lege omhulsels voor laagspanningsschakelmaterieel – Algemene eisen
EN 62208 - Empty enclosures for low-voltage switchgear and controlgear assemblies
General requirements
EN 62208 - Enveloppes vides destinées aux ensembles d'appareillage a basse tension.
Exigences générales
EN 62208 - Leergehäuse für Niederspannungs-Schaltgerätekombinationen – Allgemeine Anforderungen

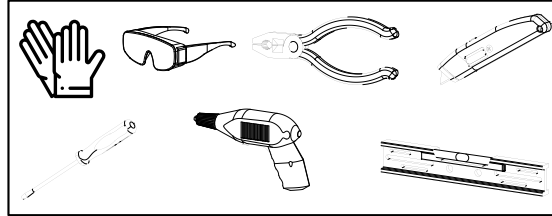

(nl) **Levensgevaar door elektrische stroom!**
Installatie van het apparaat en alle werkzaamheden eraan, mogen uitsluitend door een gekwalificeerd elektricien of speciaal opgeleid vakpersoneel worden uitgevoerd.

(en) **Electric current! Danger to life!**
Installation, commissioning and maintenance work must be carried out by qualified personnel only.

(fr) **Tension électrique dangereuse !**
L'installation de l'appareil, ainsi que tous les travaux effectués sur celui-ci, doivent être réalisés par un électricien qualifié ou par un personnel spécialement formé.

(de) **Lebensgefahr durch elektrischen Strom!**
Arbeiten bzw. Montage an diesem Produkt darf nur von Elektrofachkräften und elektrotechnisch unterwiesenen Personen ausgeführt werden.

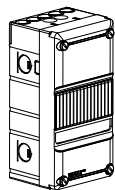

HT110-S42

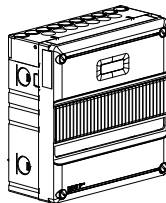

HT220-S44

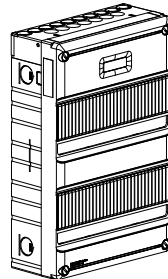

HT330-S64

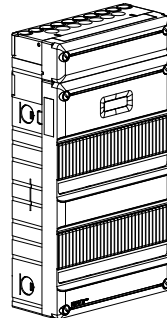

HT385-S74

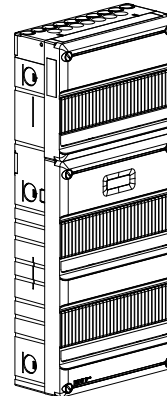

HT495-S94

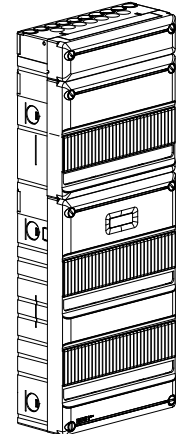

HT550-S104

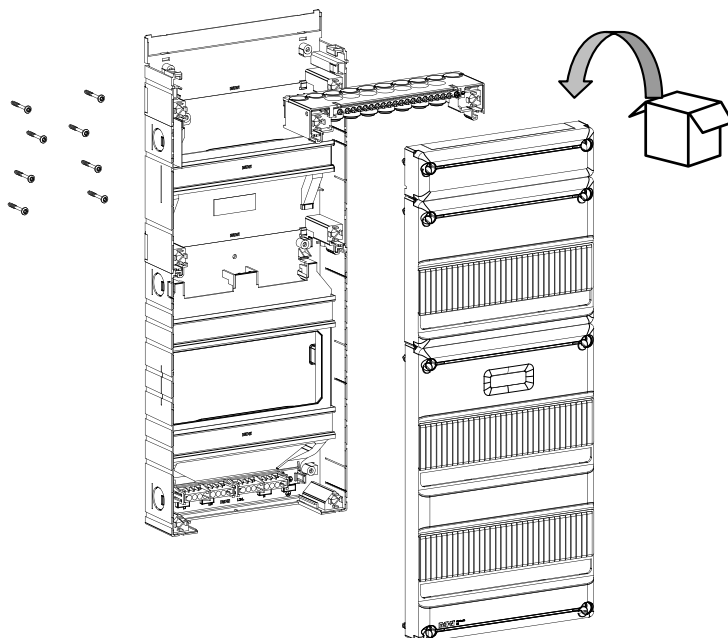

	Pv[W] Δt = 20 K	Pv[W] Δt = 30 K
HT110-S42	4,7	7,2
HT220-S44	10,0	15,4
HT330-S64	15,3	23,6
HT385-S74	18,0	27,5
HT495-S94	23,4	35,9
HT550-S104	26,1	40,0

6134709 ZADEL - 16/19

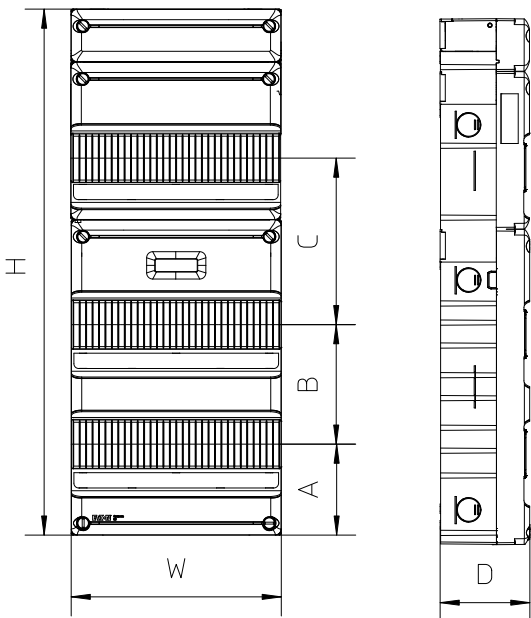
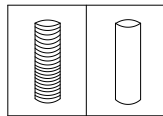
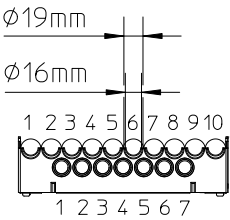
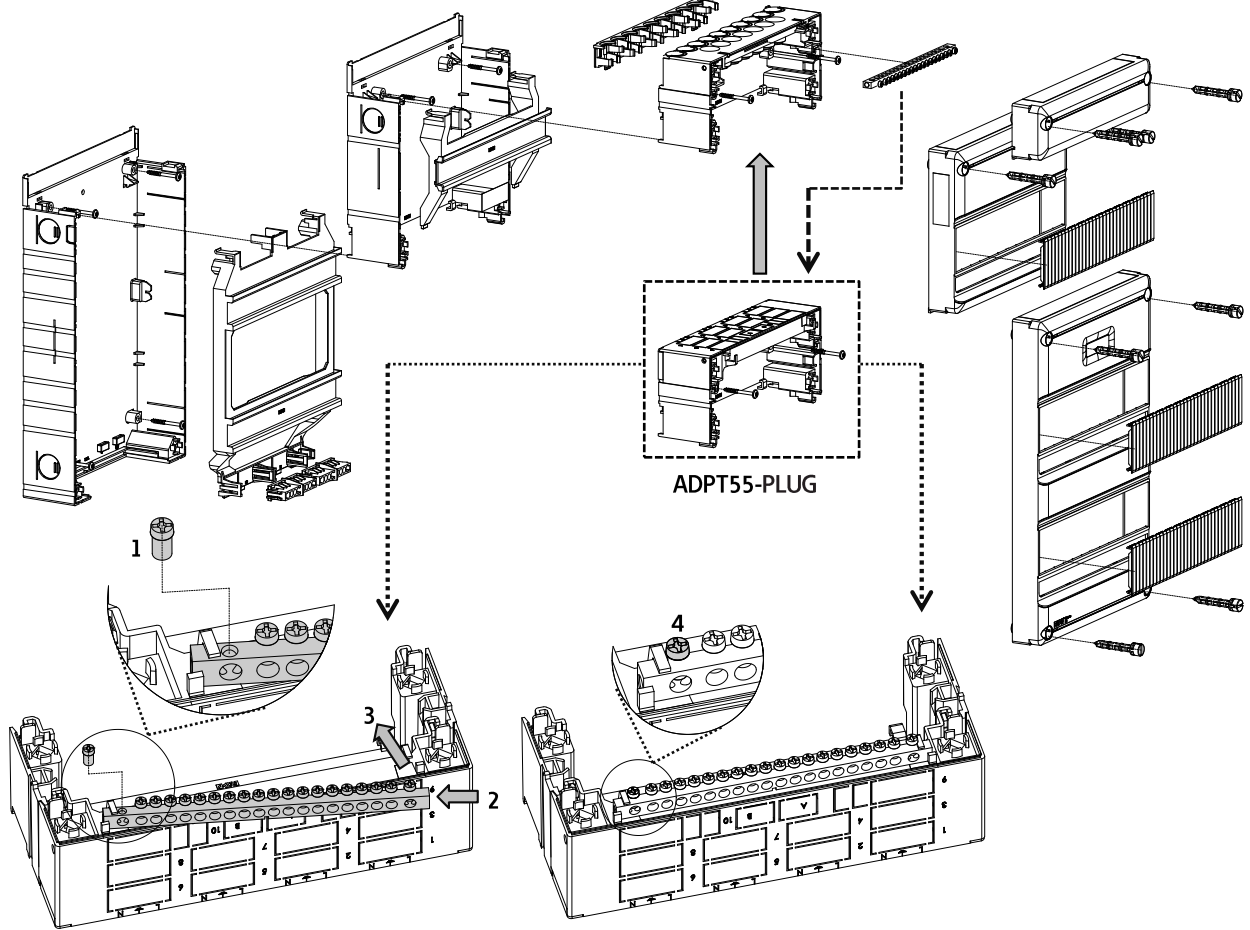

	H (mm)	W (mm)	D (mm)	A (mm)	B (mm)	C (mm)
HT110-S42	220	114	95	110	-	-
HT220-S44	220	220	95	110	-	-
HT330-S64	330	220	95	95	125	-
HT385-S74	385	220	95	95	125	-
HT495-S94	495	220	95	95	125	174
HT550-S104	550	220	95	95	125	174

09/18 IL014053ZU

1

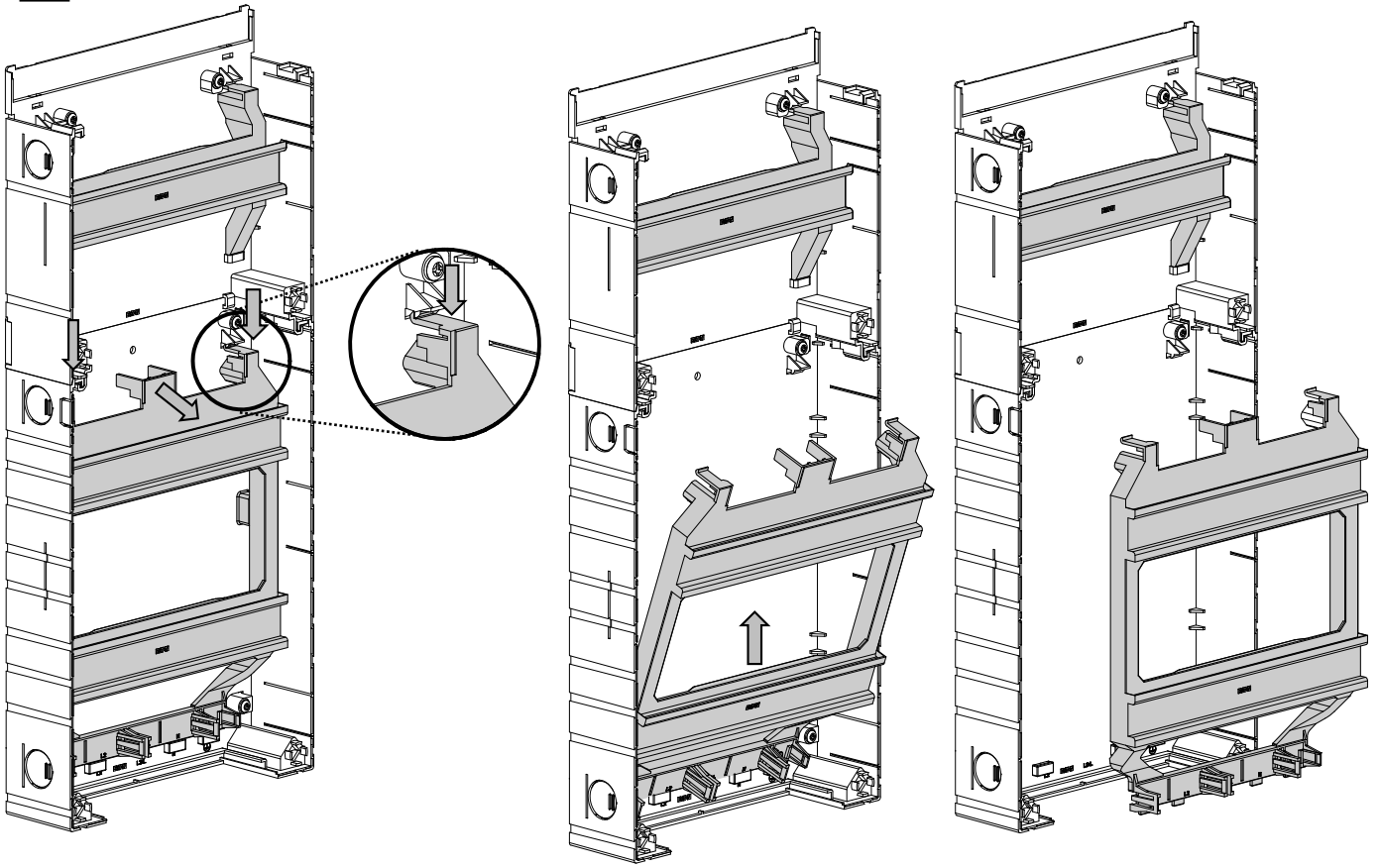

09/18 IL014053ZU

2

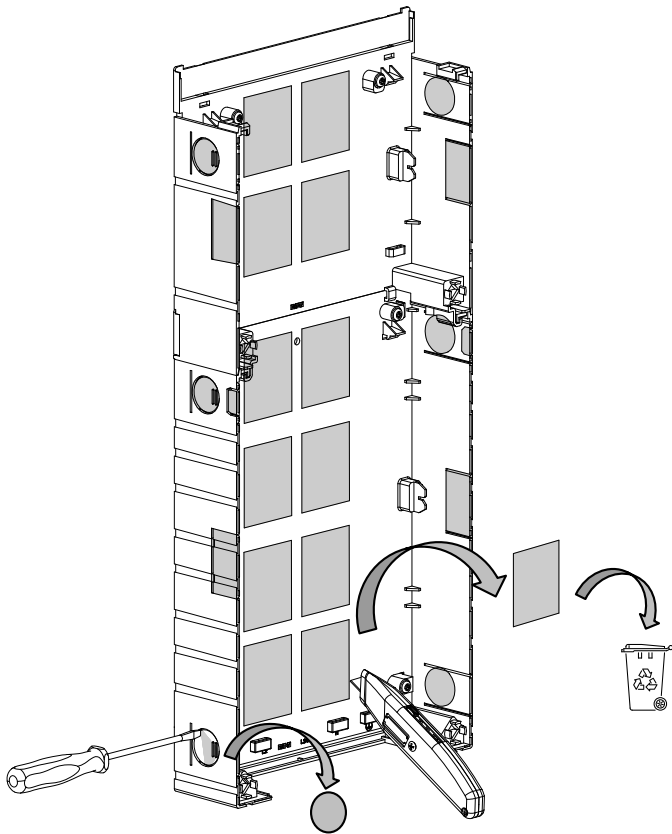

3

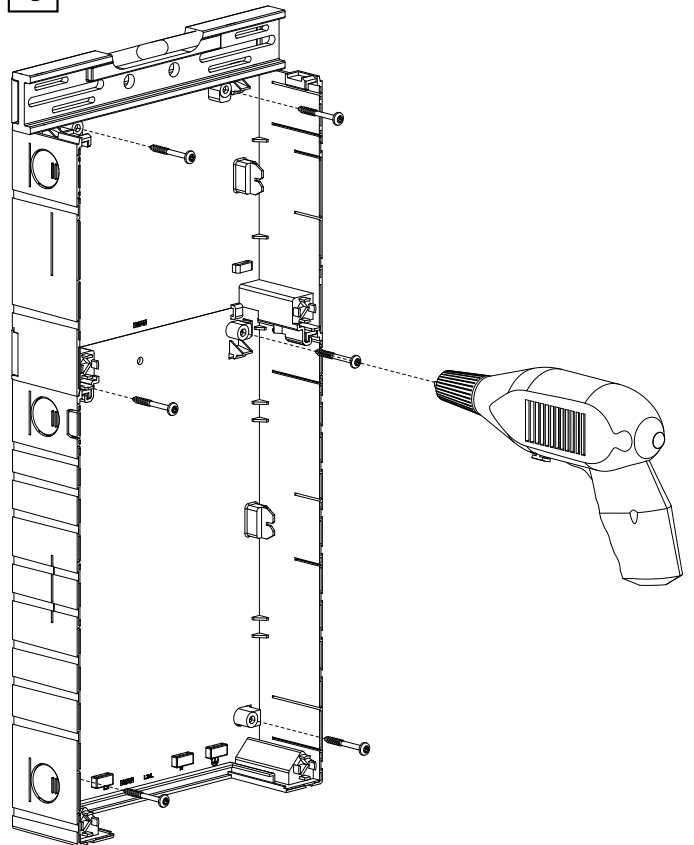

4a

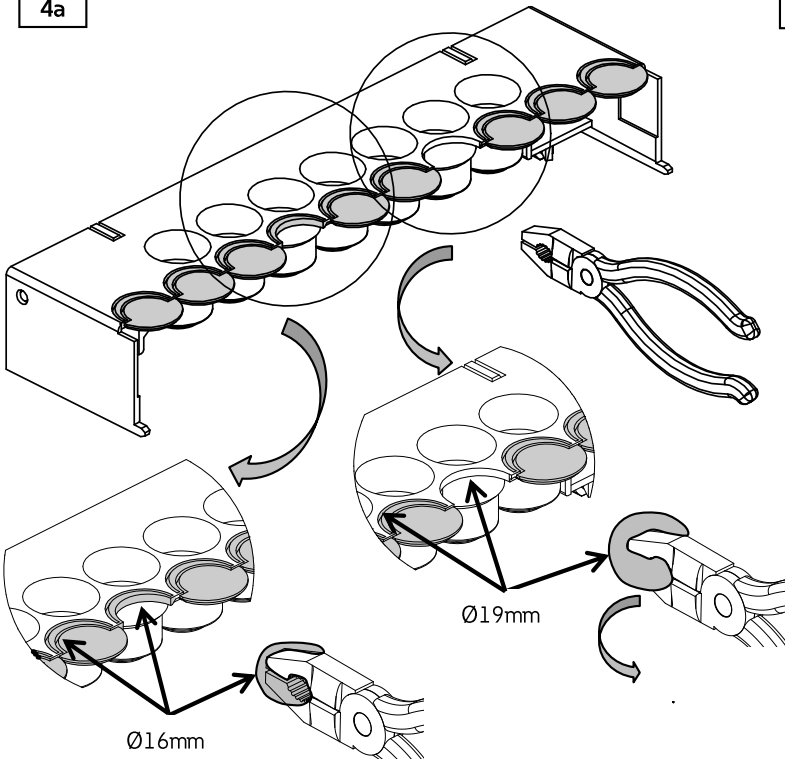

4b

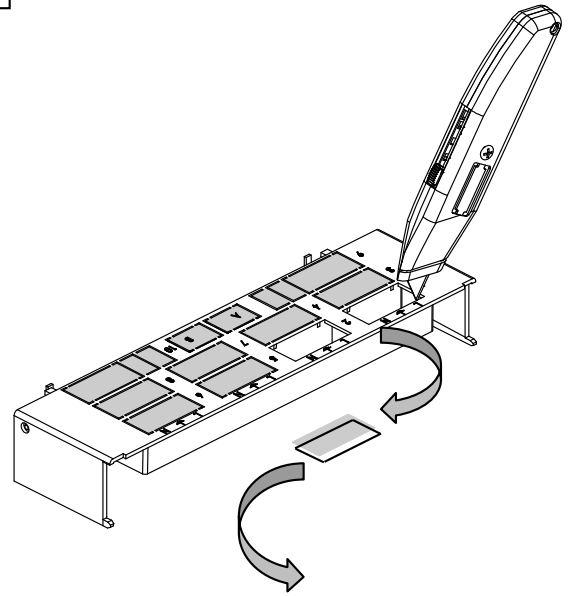

5a

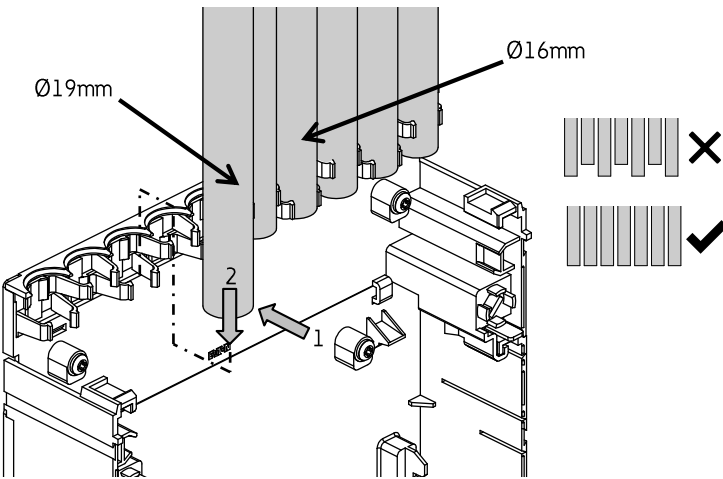

5b

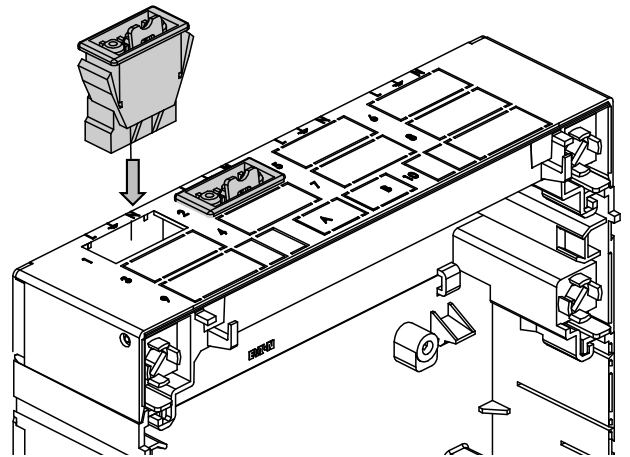

09/18 IL014053ZU

6a

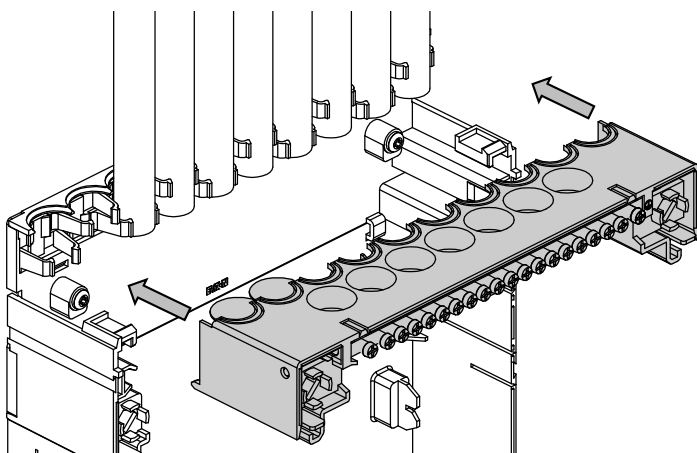

6b

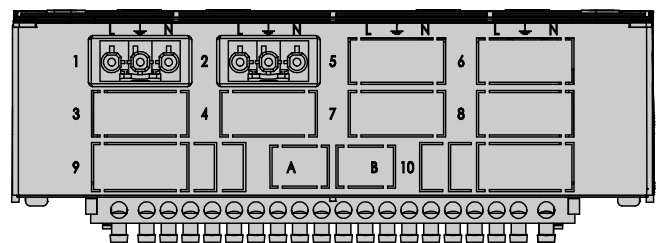

ADPT55 - PLUG

7a

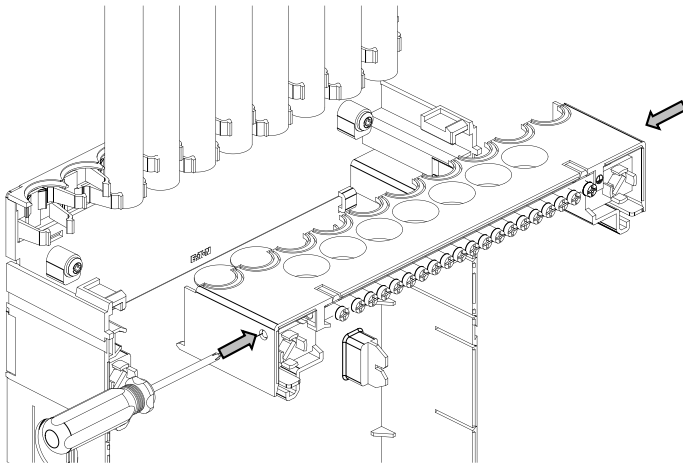

7b

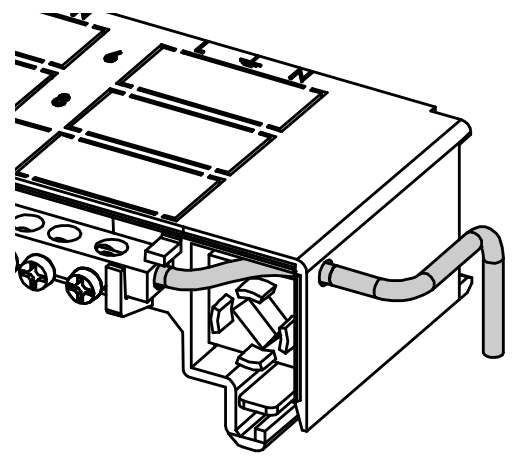
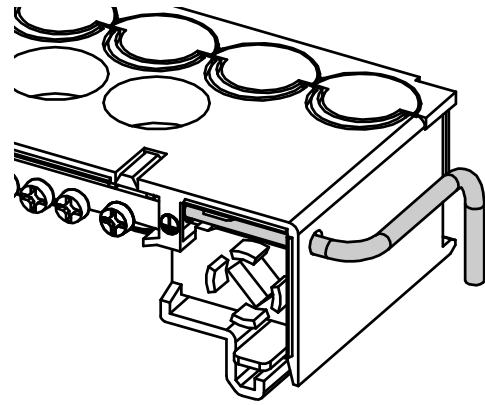
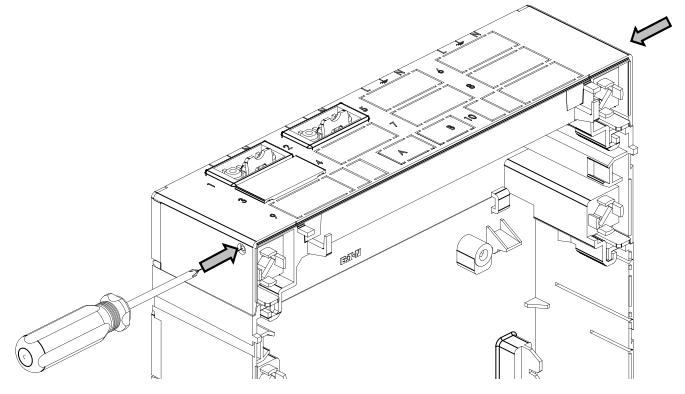

09/18 IL014053ZU

8a

Aardrail voor behuizing HT110-S42
 Earth bar for enclosure HT110-S42
 Barre de terre pour enceinte HT110-S42
 Erdungsschiene für Gehäuse HT110-S42

	massief solid massif eindrätig	$2 \times 1.5 - 16 \text{ mm}^2$	$L = 8 \text{ mm}$	$1.2 - 1.5 \text{ Nm}$	 PZ2
	flexibel met adereindhuls stranded with ferrule torsadé avec embout isolé feindrätig mit Aderendhülse	$2 \times 1.5 - 10 \text{ mm}^2$	$L = 8 \text{ mm}$	$1.2 - 1.5 \text{ Nm}$	 PZ2
	massief solid massif eindrätig	$6 \times 1.5 - 10 \text{ mm}^2$	$L = 8 \text{ mm}$	$1.2 - 1.5 \text{ Nm}$	 PZ2
	flexibel met adereindhuls stranded with ferrule torsadé avec embout isolé feindrätig mit Aderendhülse	$6 \times 1.5 - 6 \text{ mm}^2$	$L = 8 \text{ mm}$	$1.2 - 1.5 \text{ Nm}$	 PZ2

8b

Aardrail voor behuizing HT220-S44, HT330-S64, HT385-S74, HT495-S94, HT550-S104
 Earth bar for enclosure HT220-S44, HT330-S64, HT385-S74, HT495-S94, HT550-S104
 Barre de terre pour enceinte HT220-S44, HT330-S64, HT385-S74, HT495-S94, HT550-S104
 Erdungsschiene für Gehäuse HT220-S44, HT330-S64, HT385-S74, HT495-S94, HT550-S104

	massief solid massif eindrätig	$20 \times 1.5 - 16 \text{ mm}^2$	$L = 8 \text{ mm}$	$1.2 - 1.5 \text{ Nm}$	 PZ2
	flexibel met adereindhuls stranded with ferrule torsadé avec embout isolé feindrätig mit Aderendhülse	$20 \times 1.5 - 10 \text{ mm}^2$	$L = 8 \text{ mm}$	$1.2 - 1.5 \text{ Nm}$	 PZ2

9a 1015009

	massief solid massif eindrätig	$2 \times 2.5 - 16 \text{ mm}^2$	$L = 8 \text{ mm}$	$1.2 - 1.5 \text{ Nm}$	 PZ2
	flexibel met adereindhuls stranded with ferrule torsadé avec embout isolé feindrätig mit Aderendhülse	$2 \times 2.5 - 10 \text{ mm}^2$	$L = 8 \text{ mm}$	$1.2 - 1.5 \text{ Nm}$	 PZ2

09/18 IL014053ZU

9b 1015121

	massief solid massif eindrätig	$8 \times 1 - 4 \text{ mm}^2$	$L = 8 \text{ mm}$	$1.2 - 1.5 \text{ Nm}$	 PZ2
	flexibel met adereindhuls stranded with ferrule torsadé avec embout isolé feindrätig mit Aderendhülse	$2 \times 2.5 - 10 \text{ mm}^2$	$L = 8 \text{ mm}$	$1.2 - 1.5 \text{ Nm}$	 PZ2

9c 1014839

	massief solid massif eindrätig	$3 \times 2.5 - 10 \text{ mm}^2$	$L = 8 \text{ mm}$	$1.2 - 1.5 \text{ Nm}$	 PZ2



10a

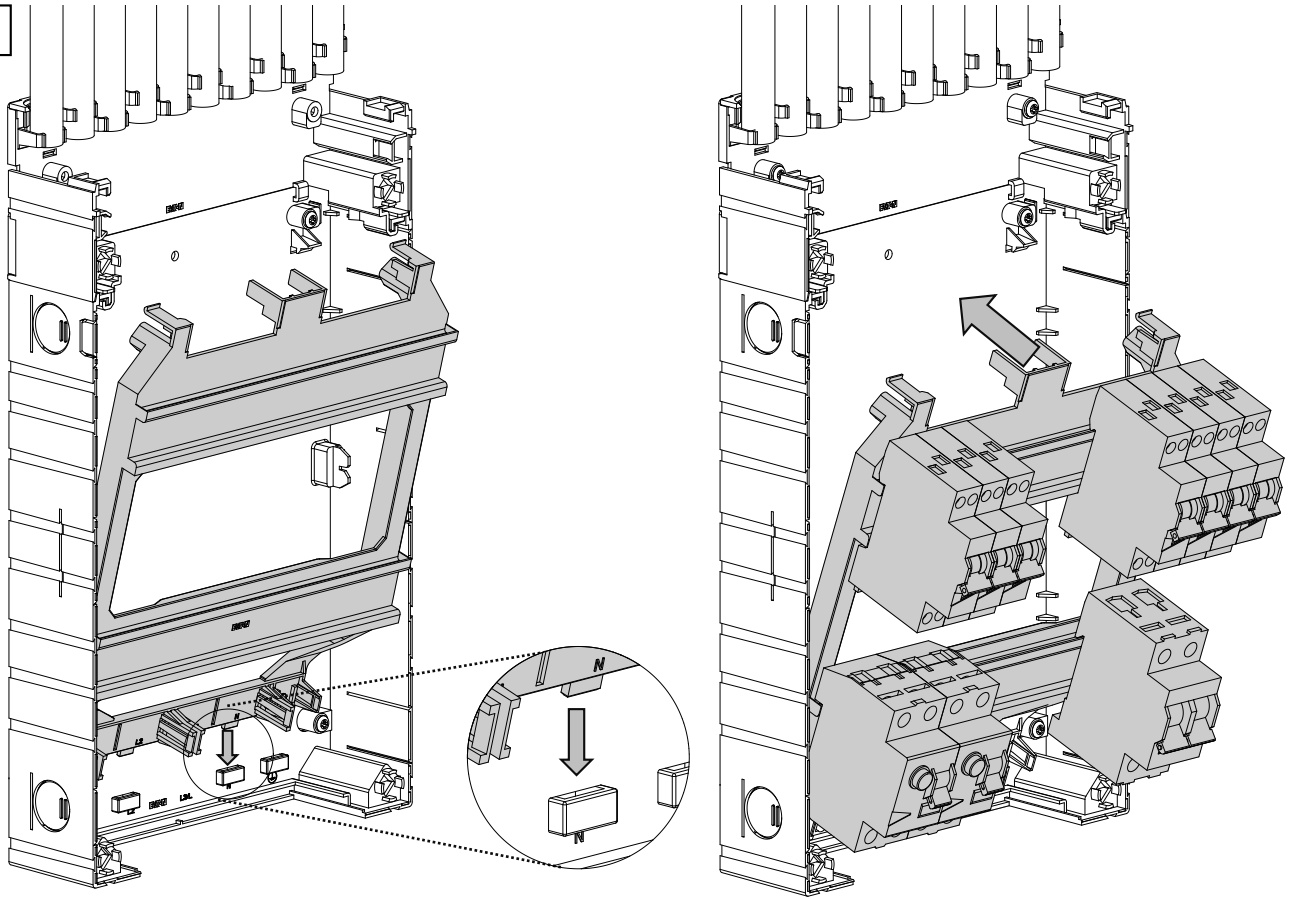

09/18 IL014053ZU

10a

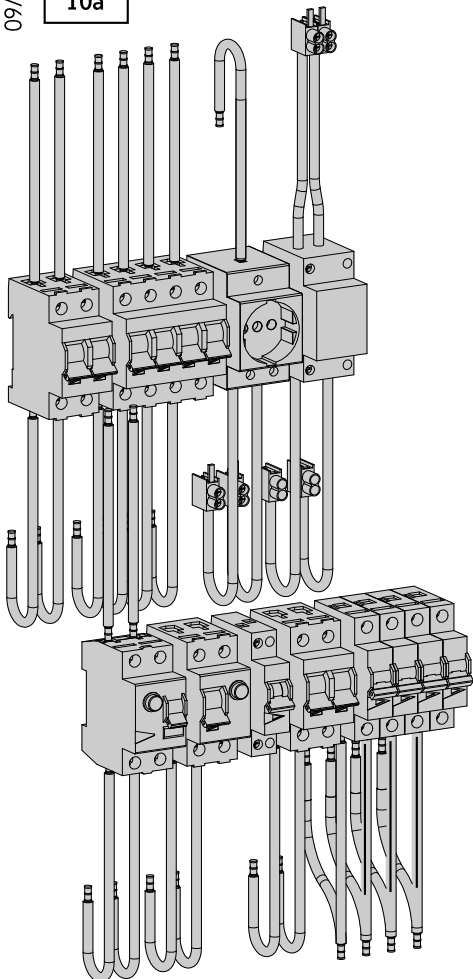

10b

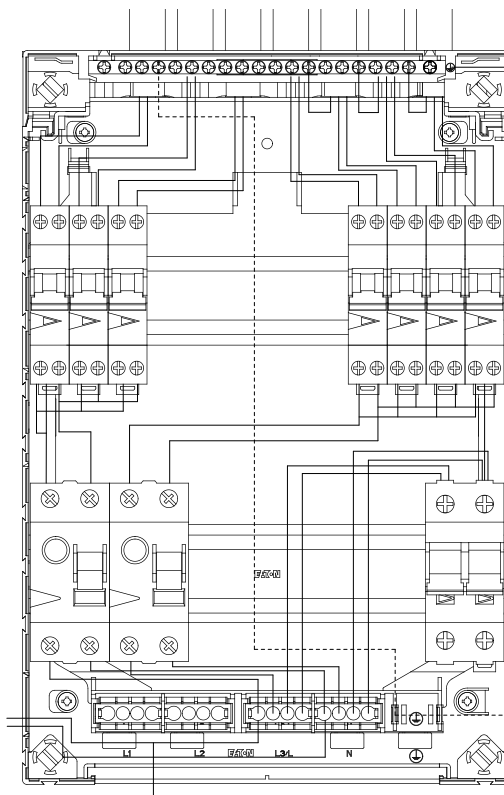

Ook aansluitmogelijkheid aan de linkerzijde
 Connection possibility also on the left side
 Possibilité de raccordement aussi du côté gauche
 Anschlussmöglichkeit auch nach links

Externe aarde, max 10mm² massief / 6mm² flexibel met adereindhuls

Connection to main earth, max. 10mm² solid / 6mm² stranded with ferrule

Raccordement au terminal de terre d'entrée, max 10mm² massif / 6mm² torsadé avec embout isolé

Verbindung zur Haupterdung, max 10mm² eindrätig / 6mm² feindrätig mit Aderendhülse

Interne aarde (optioneel) max 2.5-10mm² massief

Internal main earth connection (optional) max. 2.5-10mm² solid

Raccordement au terminal de terre interne (optionnel), max. 2.5 – 10mm² massif

Interne Haupterdung (optional) max 2.5-10mm² eindrätig

Doorverbinding naar naastliggende kast max 10mm²

Connection to next enclosure max 10mm²

Raccordement au boîtier voisin max 10mm²

Verbindung zum angrenzende Gehäuse max 10mm²



11

Voor aansluitblok beltrafo
 For terminal block doorbell transformer
 Für Klemmleiste Klingeltrafo
 Pour bomier de transformateur de sonnette

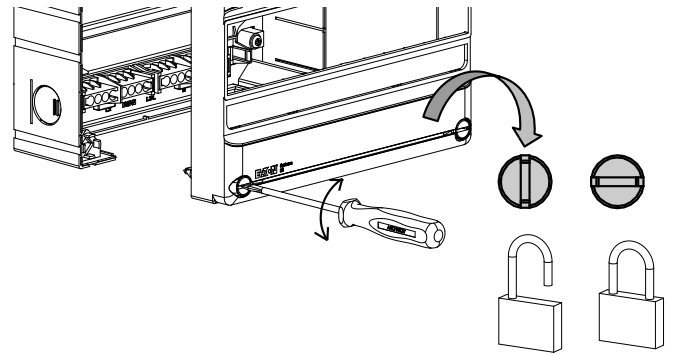
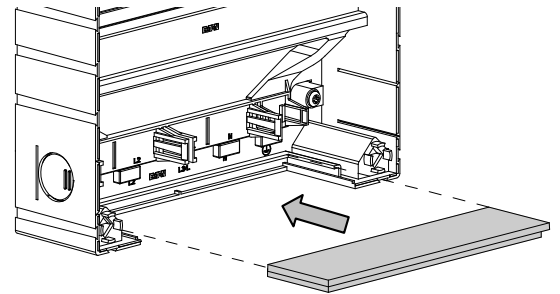
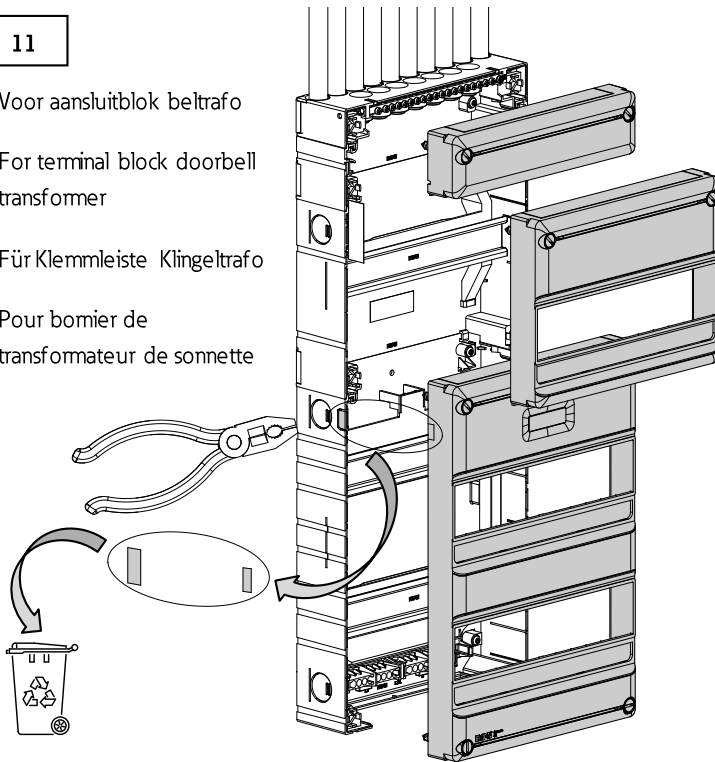

12

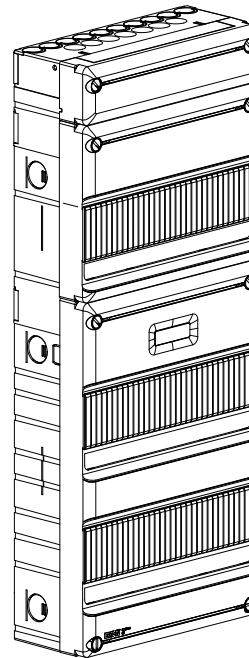
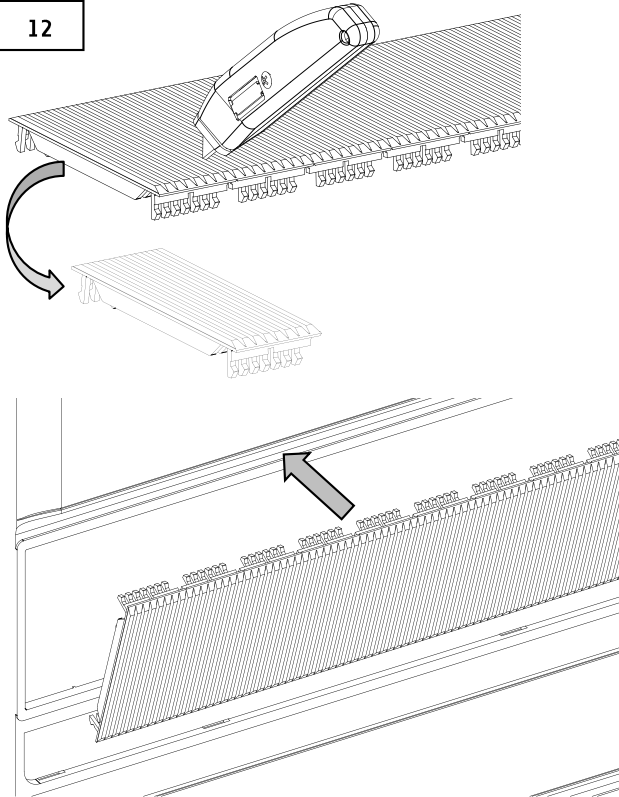

Alle openingen moeten worden afgesloten om de IP3X standaard te bereiken
 All openings need to be closed to fulfill IP3X standard
 Toutes les ouvertures doivent être fermées hermétiquement pour satisfaire aux normes IP3X
 Alle Leerplätze müssen geschlossen sein, um die Schutzart IP3X zu erfüllen

09/18 IL014053ZU

13

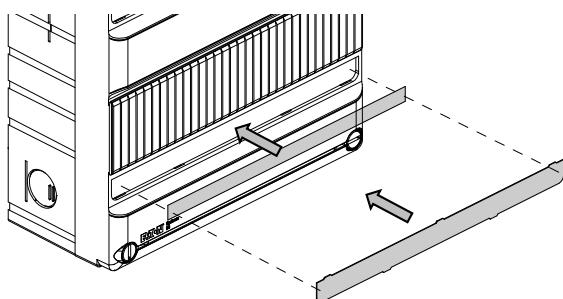

14

