

Binary Input CBEU-02/03

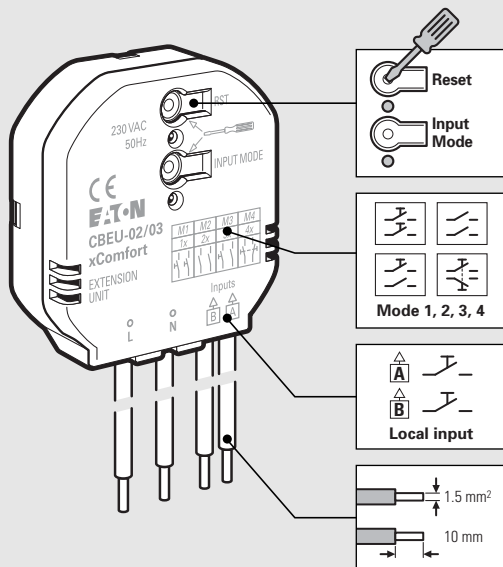

Technical Data / Technische gegevens / Tekniske data / Technische Daten / Technická data

Power supply	230 VAC +10% -15%, 50 Hz
Power standby (Typical)	230 mW
Local Input	230 VAC (Max. 265 V)
Binary Input voltage	Maximum 265 V (Same phase)
Input contact resistance IN to L	< 10 kΩ reliably ON, > 50 kΩ reliably OFF
Voltage difference IN to L	< 1 V reliably ON > 3 V reliably OFF
Dimensions	49.5 x 45.5 x 18 mm (H x W x D)

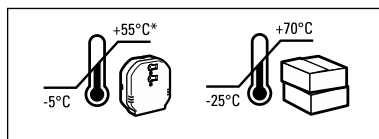

MRF Version 2.44

CBEU-02/03

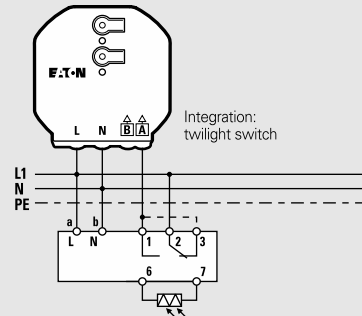
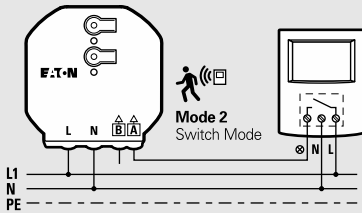
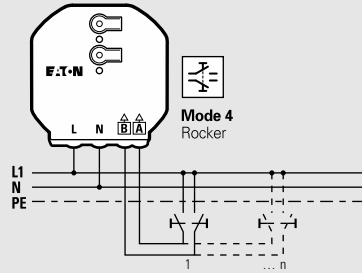
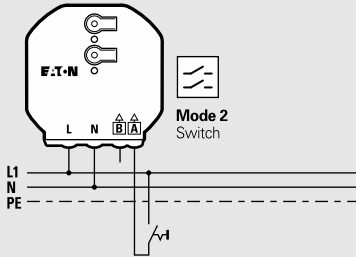
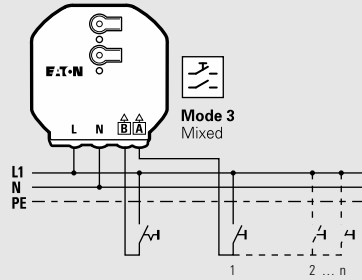
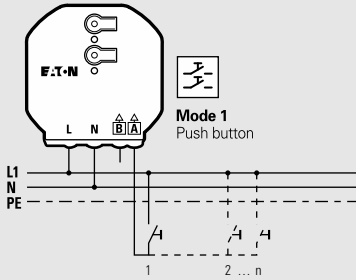

Set Local Input Mode / Lokale Ingang toewijzen / Tildele Lokal Inngang / Zuweisung lokaler Eingang / Přřazení místního vstupu

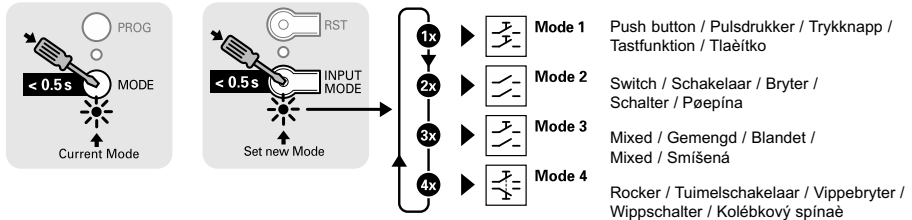

Back to factory default / Terug naar fabrieksinstellingen / Tilbake til fabrikkinnstillinger / Auf Auslieferungszustand zurřcksetzen / Zpět na tovární hodnoty

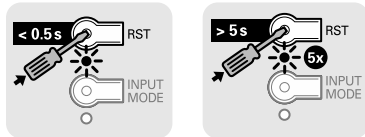



Declaration of Conformity

We, **EATON Industries (Austria) GmbH**
3943 Schrems, Eugenia 1
Austria

declare under our sole responsibility that the product (family)

Eaton - Binary input with 230VAC power supply, CBEU-02/03 (contains RF-Modul CSCZ-01/xx)

(the declaration of conformity applies to all listed types within our actual product catalogue)

provided that it is installed, maintained and used in the application intended for, with respect to the relevant manufacturers instructions, installation standards and 'good engineering practices'

complies with the provisions of Council directive(s):

RED Directive 2014/53/EU

RoHS Directive 2011/65/EU

based on compliance with following standard(s):

EN 301489-3 V2.1.1, EN 300220-2 V3.1.1, EN 60669-2-1:2010,
EN 50428:2005+A1:2007+A2:2009, EN 55015:2013, EN 61547:2009,
EN 50491-5-1:2010, EN 50491-5-2:2010, EN 60950-1:2006 + A11:2009
+ A1:2010 + A12:2011 + A2:2013, EN 62479:2010, EN 50581:2012

EU- type examination performed by:
TÜV Austria Services GmbH, Notified Body
1230 Vienna, Deutschstrasse 10, Austria

Affixing date of CE mark: 2015
Doc.Id.: CBEU-0203_171117

Fernando Ceccarelli

Senior Vice President
General Manager

17.11.2017

Friedrich Schröder

Director Quality
& Systems

