

EcoStruxure

Link150 Ethernet Gateway

Firmware Release Notes

EcoStruxure offers simple, cost-effective serial-to-Ethernet connectivity.

DOCA0182EN-05
06/2022

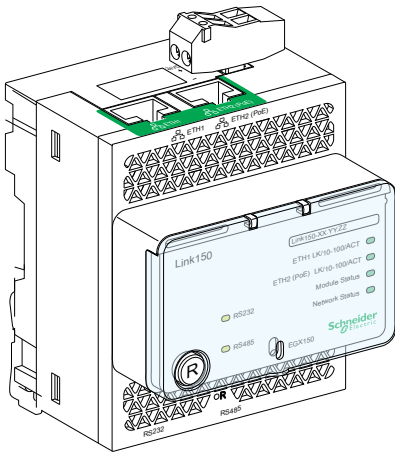

Legal Information

The Schneider Electric brand and any trademarks of Schneider Electric SE and its subsidiaries referred to in this guide are the property of Schneider Electric SE or its subsidiaries. All other brands may be trademarks of their respective owners.

This guide and its content are protected under applicable copyright laws and furnished for informational use only. No part of this guide may be reproduced or transmitted in any form or by any means (electronic, mechanical, photocopying, recording, or otherwise), for any purpose, without the prior written permission of Schneider Electric.

Schneider Electric does not grant any right or license for commercial use of the guide or its content, except for a non-exclusive and personal license to consult it on an "as is" basis. Schneider Electric products and equipment should be installed, operated, serviced, and maintained only by qualified personnel.

As standards, specifications, and designs change from time to time, information contained in this guide may be subject to change without notice.

To the extent permitted by applicable law, no responsibility or liability is assumed by Schneider Electric and its subsidiaries for any errors or omissions in the informational content of this material or consequences arising out of or resulting from the use of the information contained herein.

Table of Contents

Introduction	5
EcoStruxure Master Range	5
Link150 Ethernet Gateway	5
Firmware Release History	5
Firmware Update Policy	5
Firmware Update	6
Firmware Versions	7
Firmware Version 005.002.005	7
Firmware Version 005.001.024	7
Firmware Version 005.001.022	7
Firmware Version 005.001.019	7
Firmware Version 005.001.018	8
Firmware Version 005.001.015	8
Firmware Version 005.000.029	8
Related Documents	9

Introduction

EcoStruxure Master Range

EcoStruxure is Schneider Electric's IoT-enabled, plug-and-play, open, interoperable architecture and platform, in Homes, Buildings, Data Centers, Infrastructure and Industries. Innovation at Every Level from Connected Products to Edge Control, and Apps, Analytics and Services.

Link150 Ethernet Gateway

Link150 Ethernet gateway is a communication device that provides connectivity between Ethernet (Modbus TCP/IP) and Modbus serial line devices.

It allows:

- Modbus TCP/IP clients to access information from serial slave devices
- Serial master devices to access information from slave devices distributed across an Ethernet network.

Firmware Release History

Date	Firmware version	Availability
May 2022	005.002.005	Release for manufacturing
June 2021	005.001.024	Obsolete
April 2021	005.001.022	Obsolete
December 2020	005.001.019	Obsolete
October 2020	005.001.018	Obsolete
December 2019	005.001.015	Obsolete
February 2019	005.000.029	Obsolete

Firmware Update Policy

If the latest features of a firmware update are not required, it is not mandatory to update the firmware of a device. However, potential cybersecurity vulnerabilities are regularly addressed and update is recommended.

Use this release note to determine whether an update to the latest version of the Link150 firmware is interesting or relevant for your application.

Firmware Update

Link150 firmware can be updated by using the Link150 Firmware Upgrade Tool. The latest version of the Link150 Firmware Upgrade Tool can be downloaded from Schneider Electric website at www.se.com/ww/en/download/.

This tool is mandatory to update the firmware to the latest version for Link150 gateway with firmware version 005.002.005 or earlier. For more information, refer DOCA0223EN – *Link150 Ethernet Gateway Firmware Upgrade Tool – User Guide*.

For Link150 gateway with firmware version 005.002.005 or later, use either the webpage or the firmware upgrade tool to update the firmware. For more information, refer DOCA0110EN – *Link150 Ethernet Gateway – User Guide*.

Firmware Versions

Firmware Version 005.002.005

Security Updates

- General Security Improvements.
- Product supports Encrypted Firmware upgrade only.

Quality

- Modbus Timeouts Performance Improvements.
- Added Client Connection Timeout and Message Timeout Configuration.
- Modbus Request queue size has been increased from 4 to 10.

Firmware Version 005.001.024

Security Updates

- Removed the support for TLS 1.0 and TLS 1.1.
- Disabled the TCP option **Timestamp**.
- Included the Treck TCP stack patch for IPv6 vulnerabilities.

New Features

Added the user certificate management feature.

Firmware Version 005.001.022

New Features

- Added the configurable Modbus port numbers for remote device connections in Modbus Slave mode.
- Added a feature to disable the Ethernet port not in use.
- Added the security updates in support of SNMP default configurations.

Firmware Version 005.001.019

Bugs Fixed

IP configuration was not possible for some devices according to their MAC address.

Firmware Version 005.001.018

Security Updates

Treck TCP/IP Vulnerabilities (Ripple20) was fixed. Refer to [SEVD-2020-175-01](#) Schneider Electric Security Notification – Treck TCP/IP Vulnerabilities (Ripple20).

NOTE: Link150 gateway with firmware version 005.001.018 cannot be downgraded to older version of firmware (up to version 005.001.015).

Firmware Version 005.001.015

Security Updates

- Security updates in support of:
 - Self-signed certificate
 - Link150 gateway in **HTTPS Enabled** mode by default
 - RBAC-User Account Management supported with Admin and Guest pre-defined roles
- Removed the FTP feature for better security

New Features

Added the following features:

- New user interface layout in the webpages
- RSTP feature
- Firmware update supported through webpage for version 005.001.015

NOTE:

- Firmware version 005.001.015 is not backward compatible with existing User Account Management. By updating to firmware version 005.001.015, user will lose all the user account settings.
- Connection of Modbus TCP/IP cannot be configured from firmware version 005.001.015, and supports up to 32 address.
- Link150 gateway with firmware version 005.001.015 cannot be downgraded to older version of firmware (up to version 005.000.029).

Firmware Version 005.000.029

Bugs Fixed

- Connectivity with PME software for ION connection was improved.
- Modbus slave ID in response to exceptions in Modbus ASCII was corrected.

Related Documents

The following table lists the documents that are compatible with a Link150 gateway with the latest firmware version:

Title of documentation	Publication date	Reference number
Link150 Ethernet Gateway – User Guide	05/2022	DOCA0110EN-07
Link150 Ethernet Gateway – Instruction Sheet	11/2021	NHA50221-04
Link150 Ethernet Gateway Firmware Upgrade Tool – User Guide	09/2021	DOCA0223EN-01

You can download these technical publications and other technical information from the website at <https://www.se.com/en/download>.

Schneider Electric
35 rue Joseph Monier
92500 Rueil Malmaison
France

+ 33 (0) 1 41 29 70 00

www.se.com

As standards, specifications, and design change from time to time,
please ask for confirmation of the information given in this publication.

© 2022 Schneider Electric. All rights reserved.

DOCA0182EN-05