

Completely pre-assembled Signal Towers / CleanSIGN

CleanSIGN WM Contin. tone 24VDC MC



| | |
|-----------|------------|
| Part No.: | 695.000.55 |
| Series: | CleanSIGN |



MECHANICAL DATA

| | |
|------------------------------|-----------------------------|
| Length | 125 mm |
| Width | 112 mm |
| Height | 485 mm |
| Diameter | 76 mm |
| Materials | PA |
| Dome colour | Clear |
| Housing colour | Black |
| Protection category | IP67 IP69K |
| Connection | Screw terminals |
| cross-sectional area maximum | 1,50mm ² / 16AWG |
| Type of fixing | Wall mounting |
| Working temperature minimum | -30°C |
| Working temperature maximum | +50°C |
| Weight with packaging | 637 g |
| Product weight | 457 g |

ELECTRICAL DATA

| | |
|-----------------------------|--------------------|
| Operating voltage | 24V |
| Operating voltage type | DC |
| Operating voltage tolerance | +/- 10% |
| Rated operational voltage | 24 VDC |
| Rated operational current | 270 mA |
| Rated inrush current | 1.000 mA |
| Protection class | Protection class 2 |
| Pollution degree | 3 |

OPTICAL DATA

| | |
|----------------------|---------------------------|
| Light source | LED |
| Light colour | MC 7 colours |
| Optical signal image | Blink EVS Permanent |
| Blink frequency | 1 Hz |
| Service life optical | 50,000 h maximum |

ACOUSTIC DATA

| | |
|-----------------------------|-----------------|
| Volume (max) at 1m distance | 85,0 dB (A) |
| Acoustic signal image | Continuous tone |
| Audio frequency | 2400 Hz |



For additional installation and mounting information, refer to the appropriate user guide at www.werma.com. This printed copy is for information only and is subject to alteration.

Completely pre-assembled Signal Towers / CleanSIGN

CleanSIGN WM Contin. tone 24VDC MC

| | |
|-----------------------|-----------------|
| Acoustic service life | 5,000 h minimum |
|-----------------------|-----------------|

| APPROVAL DATA | |
|-------------------------------|-----------------------|
| Conforms with CE | Yes |
| WEEE | No |
| Conforms with ATEX-directive | No |
| Conforms with CCC | No |
| Conforms with UL | No |
| Conforms with FCC | No |
| Conforms with IC | No |
| EAC certificate available | Yes |
| Conforms with UKCA (Importer) | Yes (WERMA (UK) Ltd.) |
| Conforms with CMIM | No |
| Conforms with AS-I | No |
| ICAO Certification | No |
| Conforms with DNV | No |
| Conforms with RoHS CN | No |
| Conforms with VdS | No |



For additional installation and mounting information, refer to the appropriate user guide at www.werma.com. This printed copy is for information only and is subject to alteration.

Completely pre-assembled Signal Towers / CleanSIGN

CleanSIGN WM Contin. tone 24VDC MC

DRAWING

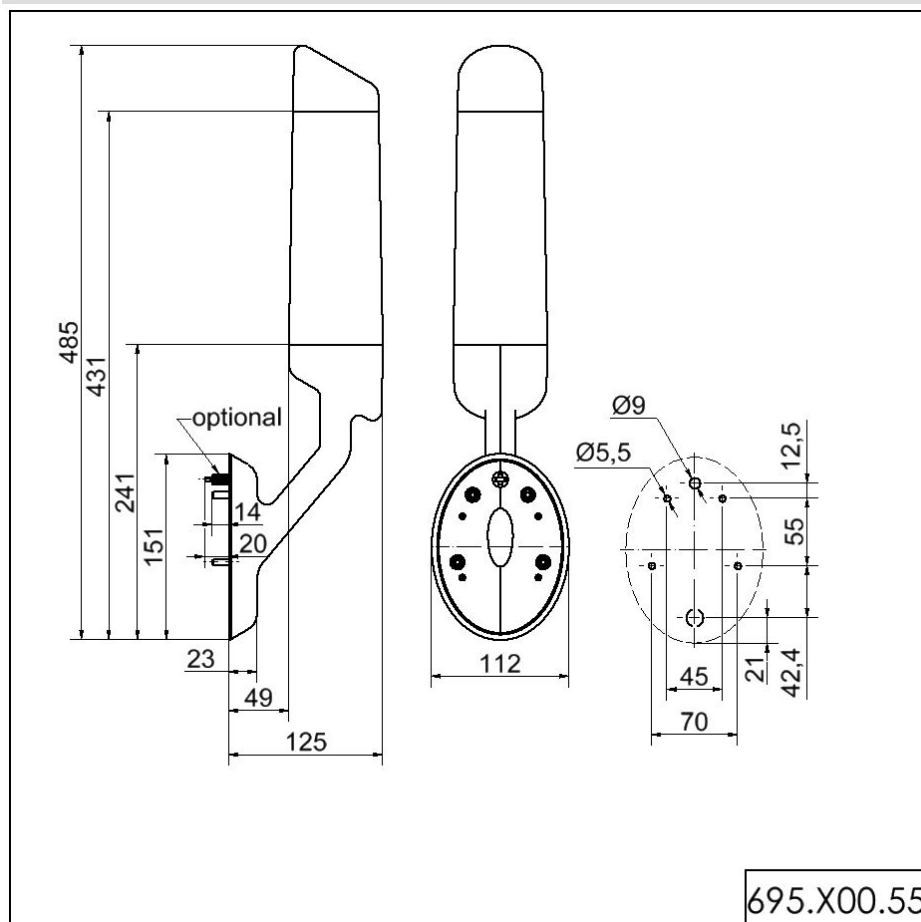

For additional installation and mounting information, refer to the appropriate user guide at www.werma.com. This printed copy is for information only and is subject to alteration.