

# Product End-of-Life Instructions

Product Range: PM1000 series power meter and DM6000 series digital panel meter

Marketing Model/Name: PM1000, PM1200, DM6000 and DM6200

## Purpose:

The product family must be disposed according to the legislation of the country. This document is intended for use by end of life recyclers or treatment facilities. It provides the basic information to assure an appropriate end of life treatment for the components and materials of the product.

## Note :

This product family is in the scope of EU directive 2002/96/EC, Waste Electrical and Electronic Equipment (WEEE).



Size in mm:

H x L x D in mm: **96 x 96 x 83 mm**  
Weight in g: **400 g**

## Operations recommended for the end of life treatment

There are several steps to process the products at the end of life so as to recover components, materials or energy : Reuse → Separation for special treatment → Other dismantling → Shredding.

**The components of the products that optimize the recycling performances are listed, identified and located hereunder.**

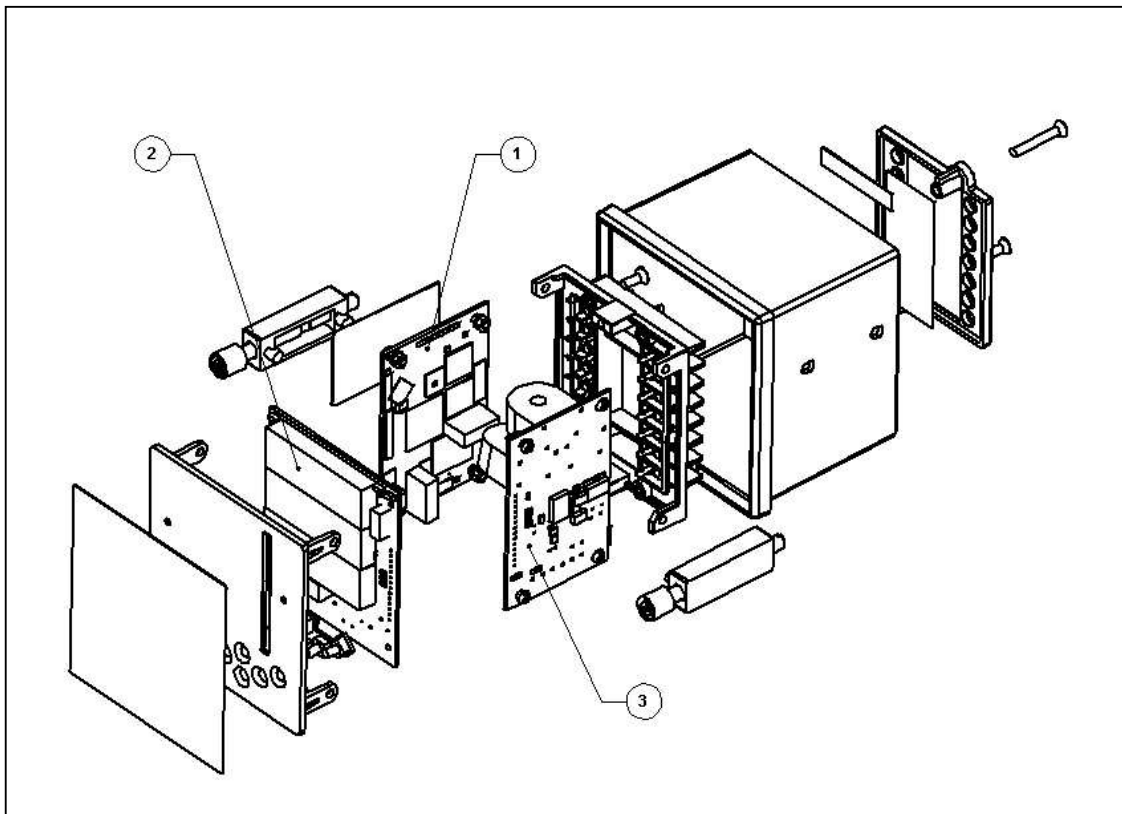

Number on drawing	Components	Comment	
Components listed for special treatment which improves the recycling performances			
1	Printed circuit boards	52.5 g	Input Board PCB Assembly
2	Printed circuit boards	54.5 g	Low Voltage PCB Assembly
3	Printed circuit boards	57.54 g	Current Transformer and Communication PCB Assembly

**Schneider Electric SA**  
 43-45, boulevard Franklin Roosevelt  
 F-92500 Rueil-Malmaison Cedex (France)  
 Tel.: +33 (0) 1 41 29 70 00  
 www.schneider-electric.com

The version of the Guide used to create the document: End of Life Instruction Drafting Guide of Schneider Electric version V1

ENVEOL120112EN

Publication date : 21/04/2013