

Product End-of-Life Instructions

ALTIVAR PROCESS

Product Range

Altivar Process – Ranges: 11 kW – 3PH – 200/240 V – IP21 / 15 to 22 kW – 3PH – 400/480V – IP21

Marketing Model

ATV630D22N4, ATV630D15N4, ATV630D18N4, ATV630D11M3

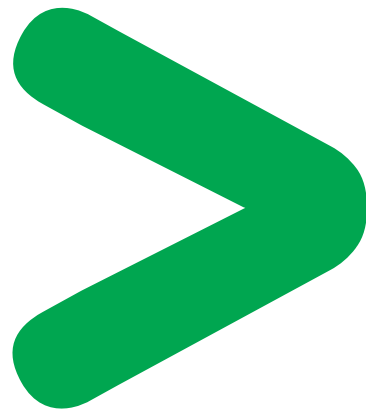

Size in mm:

W x H x D : 211 x 546 x 232

Weight in g:

From 14150 to 17020 for the product range.

Weight is 17020 for ATV630D22N4 including packaging and batteries (weight of the battery is 3)



Operations recommended for the end of life treatment

There are several steps to process the products at the end of life so as to recover components, materials or energy :

Reuse ⇒ Separation for special treatment ⇒ Other Dismantling ⇒ Shredding

This product contains electrolytic capacitors which may cause electrical shock during the end of life treatment process. **BEFORE SERVICING, REMOVE ALL POWER, WAIT 15 MINUTES.**

The components of the products that optimize the recycling performances are listed, identified and located hereunder.

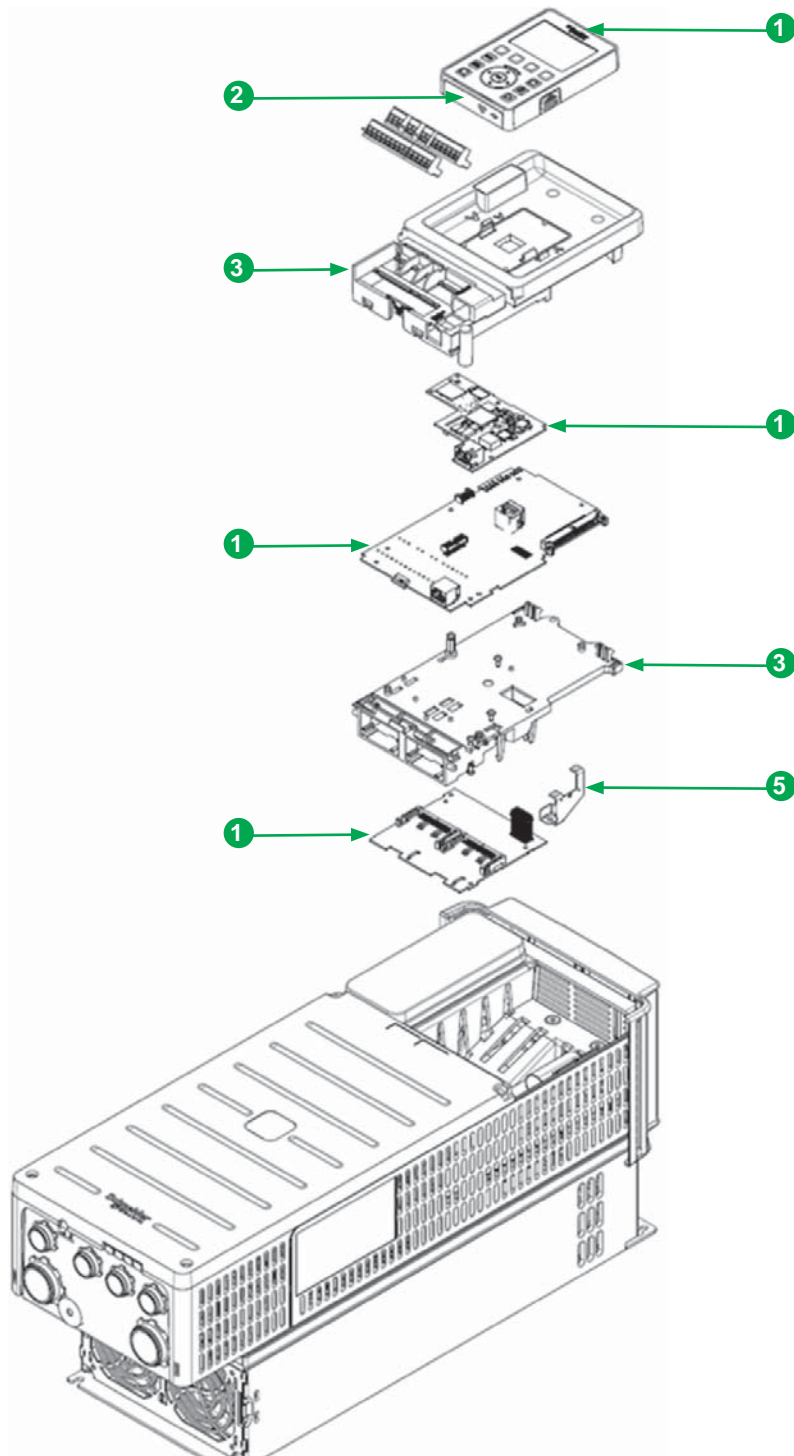

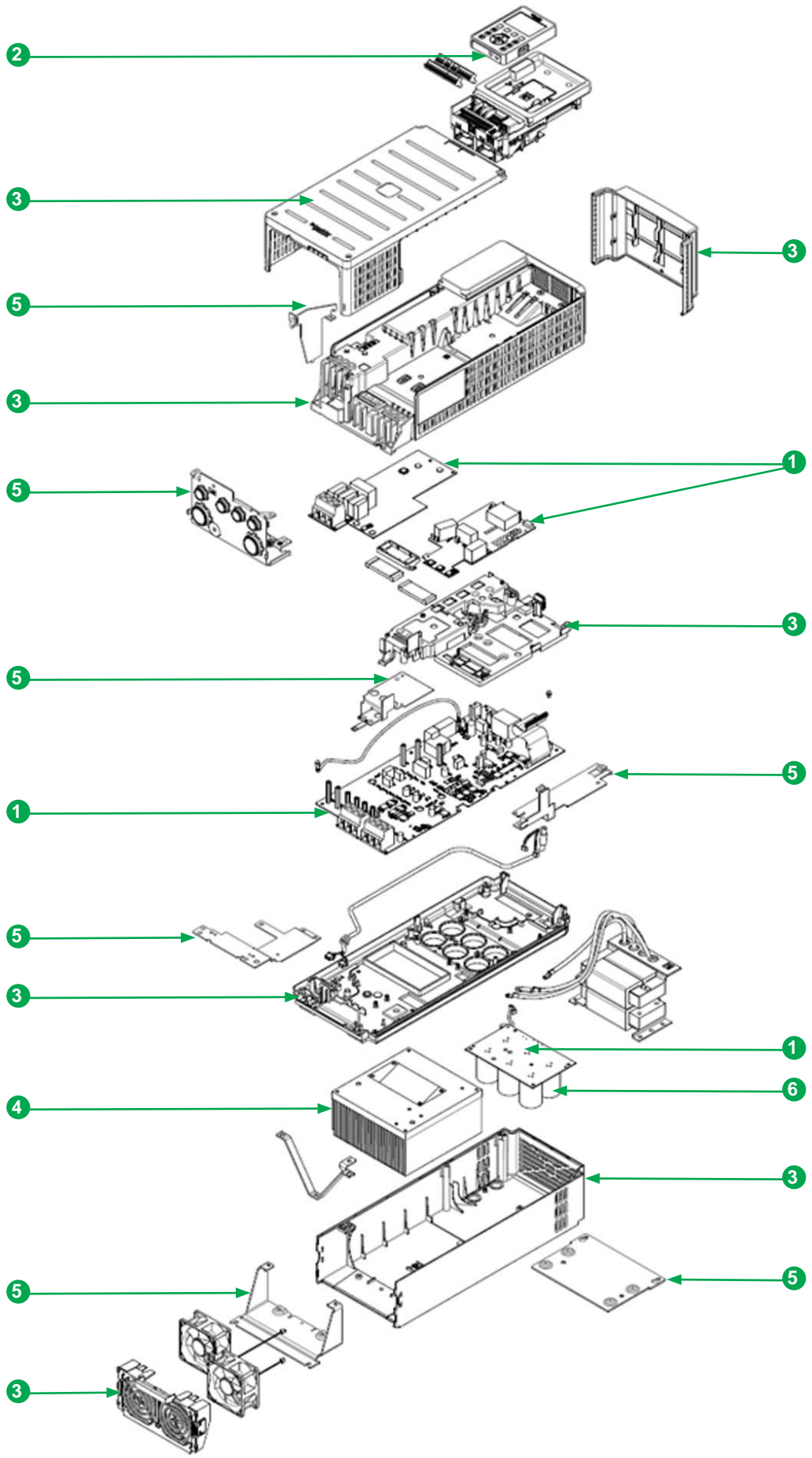



3

4

5

2

6

1



Recommendation	Number on drawing	Components	Weight (g)	Comment
Operating hazards	6	Electrolytic capacitors	685	-
Special treatment	1	Printed Circuit Board Assembly (PCBA) or power components	2365	8 PCBAs are included
	2	Manganese Dioxide Lithium Coin Battery	3	The battery is located inside the Keypad
Other dismantling	3	Plastic part	3330	PC FR
	4	Aluminium	2530	Heatsink
	5	Steel	1760	-

Schneider Electric Industries SAS

35, rue Joseph Monier
 CS30323
 F - 92506 Rueil Malmaison Cedex

RCS Nanterre 954 503 439
 Capital social 896 313 776 €
 www.schneider-electric.com

The version of the Guide used to create the document: End of Life Instruction Drafting Guide of Schneider Electric version V6.

Publication : Schneider Electric