

# Product End-of-Life Instructions

## ALTIVAR PROCESS

### Product Range

Altivar Process - Ranges: 0.75 to 4 kW – 3PH – 200/240V – IP21 / 0.75 to 5.5 kW – 3PH – 400/480V – IP21

### Marketing Model

ATV630U55N4, ATV630U07M3, ATV630U07N4, ATV630U15M3, ATV630U15N4, ATV630U22M3, ATV630U22N4, ATV630U30M3, ATV630U30N4, ATV630U40M3, ATV630U40N4

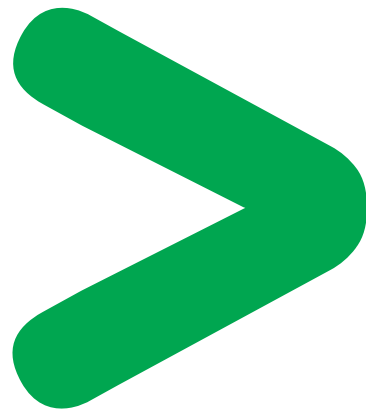

### Size in mm:

W x H x D : 144 x 320 x 203

### Weight in g:

From 5760 to 6220 for the product range.

Weight is 6220 for ATV630U55N4 including packaging and batteries (weight of the battery is 3)



## Operations recommended for the end of life treatment

There are several steps to process the products at the end of life so as to recover components, materials or energy :

Reuse ⇒ Separation for special treatment ⇒ Other Dismantling ⇒ Shredding

This product contains electrolytic capacitors which may cause electrical shock during the end of life treatment process. **BEFORE SERVICING, REMOVE ALL POWER, WAIT 15 MINUTES.**

The components of the products that optimize the recycling performances are listed, identified and located hereunder.

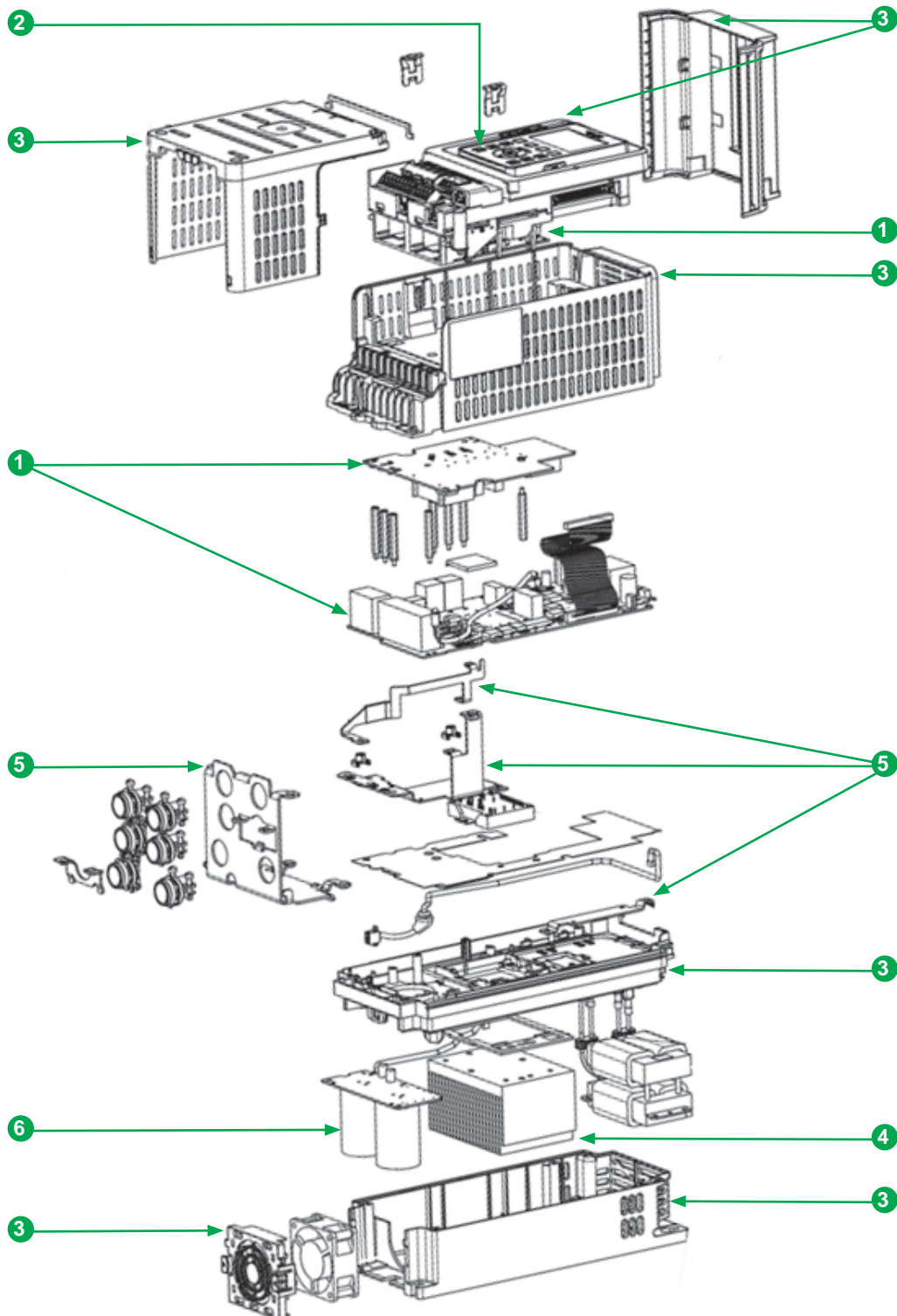

Note:



Recommendation	Number on drawing	Components	Weight (g)	Comment
Operating hazards	6	Electrolytic capacitors	175	–
Special treatment	1	Printed Circuit Board Assembly (PCBA) or power components	924	7 PCBAs are included
	2	Manganese Dioxide Lithium Coin Battery	3	The battery is located inside the Keypad
Other dismantling	3	Plastic part	1540	PC FR
	4	Aluminium	498	Heatsink
	5	Steel	130	–

**Schneider Electric Industries SAS**

35, rue Joseph Monier  
CS30323  
F - 92506 Rueil Malmaison Cedex

RCS Nanterre 954 503 439  
Capital social 896 313 776 €  
www.schneider-electric.com

The version of the Guide used to create the document: End of Life Instruction Drafting Guide of Schneider Electric version V6.

Publication : Schneider Electric