

Circularity Profile

VarSet

423 Products from 6kvar to 1150kvar

Size in mm :H x L x D in mm: from 600x450x250 to 2200x2800x600

Weight in kg : from 57 to 1904



Potential disassembly risks

The Circularity profile provides information about preparation for re-use and treatment. It identifies the relevant EEE components and materials as well as their location. Safety instructions for product dismantling and depollution are provided into the User manual or maintenance guide.

End of Life Instructions

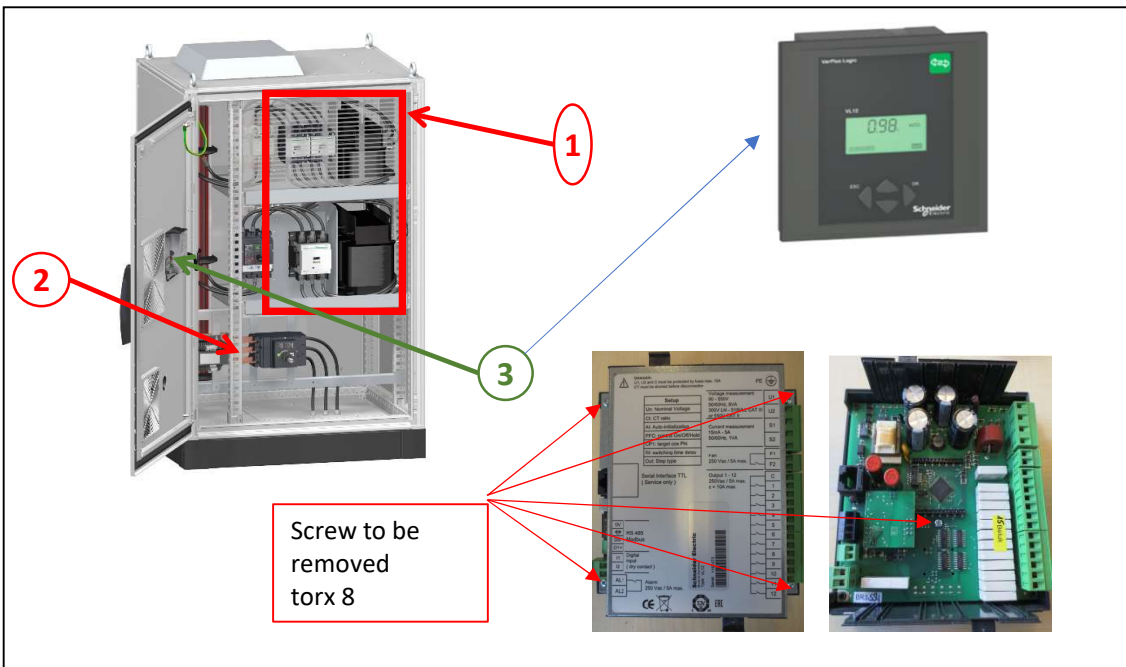

Recommendation	Number on drawing	Component / Material	Weight (in g)	Comment
Potential hazards	1	capacitors lugs, detuned reactors lugs		Capacitors are discharged at 1mn U<50V
Other	2	Circuit breaker/circuit board		If circuit breaker with reference 33XXX see ENVEOLI100604EN LV43XXXX see ENVEOLI1702004 LV5XXXXX see ENVEOLI1603001 LV56XXXX see ENVEOLI1603002
To be dismantled	3	Controller/Circuit board		see ENVEOLINHA7895600



Product description

Manufacturer identification	Schneider Electric Industries SAS
Brand name	Schneider Electric
Product function	Low voltage capacitor bank, to generate reactive energy from 6kvar to 1150kvar during 15 years
Product reference	VLVAF2P03512AA
Additional similar product references	All the product with reference structure as below: VLVA (VarSet LowVoltage Automatic) / WON, W1N, W2N, W3N, F5N, F7N, F2P, F3P, F5P, F6P, F8P, WOL, W1L, W2L, F3L, F5L (product type) / xxxxxxx (rating) VLVF (VarSet Low Voltage Fixe) / WON, W1N, W2N, F2P (product type) / xxxxxxx (rating)
Total representative product mass	290
Representative product dimensions	800/600/1400mm
Accessories	
Date of information release	April 15th 2020



Additional information

Is the product in the scope of WEEE Directive (2012/19/EU)	Yes
Legal information	This product family is in the scope of European Union directive 2012/19/EU on Waste Electrical and Electronic Equipment (WEEE). The product family must be disposed according to the legislation of the country. This document is intended for use by end of life recyclers or treatment facilities. It provides the basic information to assure an appropriate end of life treatment for the components and materials of the product.
In case of special transportation: transportation method	
Recyclability potential	50% Based on "ECO'DEEE recyclability and recoverability calculation method" (version V1, 20 Sep. 2008 presented to the French Agency for Environment and Energy

Schneider Electric Industries SAS

Country Customer Care Center
<http://www.schneider-electric.com/contact>

35 rue Joseph Mounier
 CS30323

F-92506 Rueil Malmaison Cedex

RCS Nanterre 954 504 439
 Capital social 896 313 776€

www.schneider-electric.com

Published by Schneider Electric

© 2019 - Schneider Electric – All rights reserved