

Product data

Product code	Product name	$I_{n\ Al}$	$I_{n\ Cu}$	U_n	$I_{max\ Al}$	$I_{max\ Cu}$	U_{max}
VG03-0007	OJL-connector 400 C	380 A	425 A	1000 V	-	-	-

Installation

Type	DIN-rail and screw mounting
------	-----------------------------

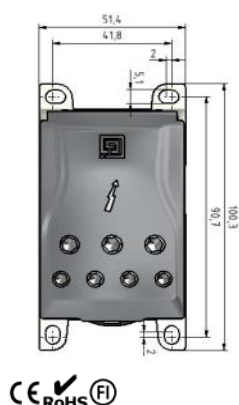

Mounting with screw.
Max. Ø 5

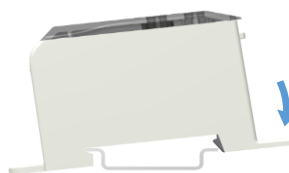

DIN-rail mounting

Set the connector on a DIN-rail.
See picture.
Push until "click"

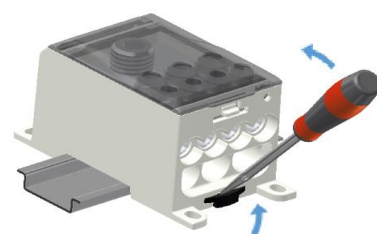

Removing from DIN-rail

Release the slider part with a screwdriver. Lift the connector.

Connection

Screw size		Screw 1	M16	Tightening torque M	95-240 mm ²	25 Nm	Stripping length (input) L ₁	30 mm
		SW ₁	8	(M _s / M _{H1} / M _{H2})	6-50 mm ²	10 Nm	(output) L ₂	16 mm
		Screw 2	M10		2,5-35 mm ²	6 Nm		
		SW ₂	5		-	-		
		Screw 3	M8	Max. Input cable		240 mm ²		
		SW ₃	4	Max. Output cable		50 mm ²		



Connect the **input** conductor when the cover is open. Both the copper- or aluminium conductors can be used in the input. Note! When using the aluminium conductor, it is only allowed to use one conductor/one space.

With the Al-conductors, it's recommended to use anti-corrosion paste. (i.e. Penetrox)
We recommend a ferrule when using a fine-stranded conductor.

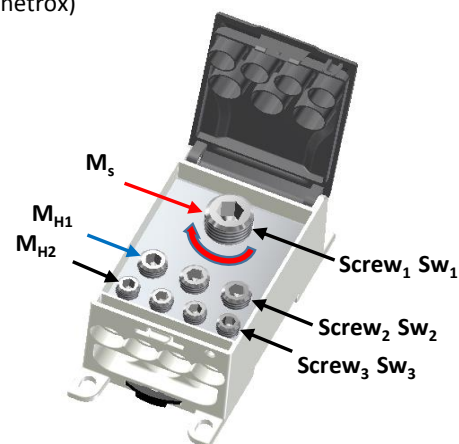
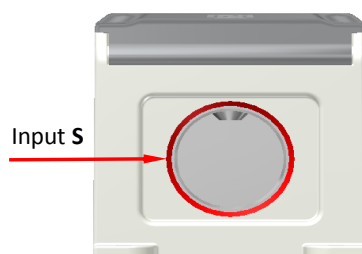
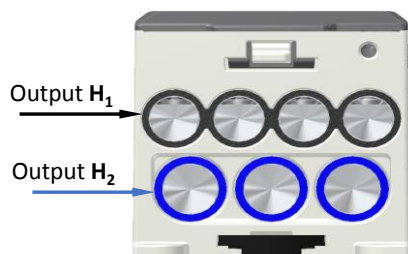

The branching conductors **H1** and **H2** can be connected also when the cover is closed. Note! It's only allowed to use Cu-conductors for branching.

Cross-section of conductors and max. number of conductors/ space (for Cu-conductors). (S / H1 / H2)

1,5 mm2	2,5 mm2	6 mm2	10 mm2	16 mm2	25 mm2	35 mm2	50 mm2	Note! The specified amount of conductors refers only to industrially installed terminals.		
-	0/3/0	0/3/3	0/3/3	0/2/3	0/1/2	0/1/1	0/0/1			
			70 mm2	95 mm2	120 mm2	150 mm2	185 mm2	240 mm2	300 mm2	400 mm2
			-	2/0/0	2/0/0	1/0/0	1/0/0	1/0/0	-	-