

Ex LED Rotat. Beacon WM 24VDC RD



Part No.: 729.120.55



MECHANICAL DATA

Length	142 mm
Height	214 mm
Diameter	139 mm
Materials	Aluminium Glass
Dome colour	Red
Housing colour	Black
Protection category	IP66
Connection	Spring-type terminal
cross-sectional area maximum	2,50mm² / 14AWG
Cable entry	Screwed cable gland
Cable entry minimum	d = 7 mm
Cable entry maximum	d = 13 mm
Tension relief	Cable gland (EN62444)
Type of fixing	Base mounting Wall mounting
Working temperature minimum	-40°C
Working temperature maximum	+50°C
Weight with packaging	3500 g
Product weight	3280 g

ELECTRICAL DATA

Operating voltage	24V
Operating voltage type	DC
Operating voltage tolerance	+/- 10%
Rated operational voltage	24 VDC
Rated operational current	170 mA
Rated inrush current	500 mA
Protection class	Protection class 1
Pollution degree	3

OPTICAL DATA

Light source	LED
Light colour	Red
Optical signal image	Revolving
Service life optical	50,000 h maximum
Rotation speed (rpm)	180 U/min

APPROVAL DATA

Conforms with CE	yes
------------------	-----



For additional installation and mounting information, refer to the appropriate user guide at www.werma.com. This printed copy is for information only and is subject to alteration.

Ex LED Rotat. Beacon WM 24VDC RD

WEEE	yes
Conform with ATEX-directive	yes
ATEX-guidance	2014/34/EU
Ex approval number	BVS 11 ATEX E107
Ex label for gas	II2G Ex db eb IIC T6 Gb
Ex label for dust	II2D Ex tb IIIC T80°C Db
Ex-standard	03 04 05 09
Conforms with IECEx	yes
IECEx Approval number	IECEx BVS 11.0082
Conforms with CCC	no
Conforms with FCC	no
Conforms with IC	No
Conforms with AS-I	no
ICAO Certification	No
Conforms with GL	no
Conforms with RoHS CN	no
Conforms with VdS	no



For additional installation and mounting information, refer to the appropriate user guide at www.werma.com. This printed copy is for information only and is subject to alteration.

DRAWING

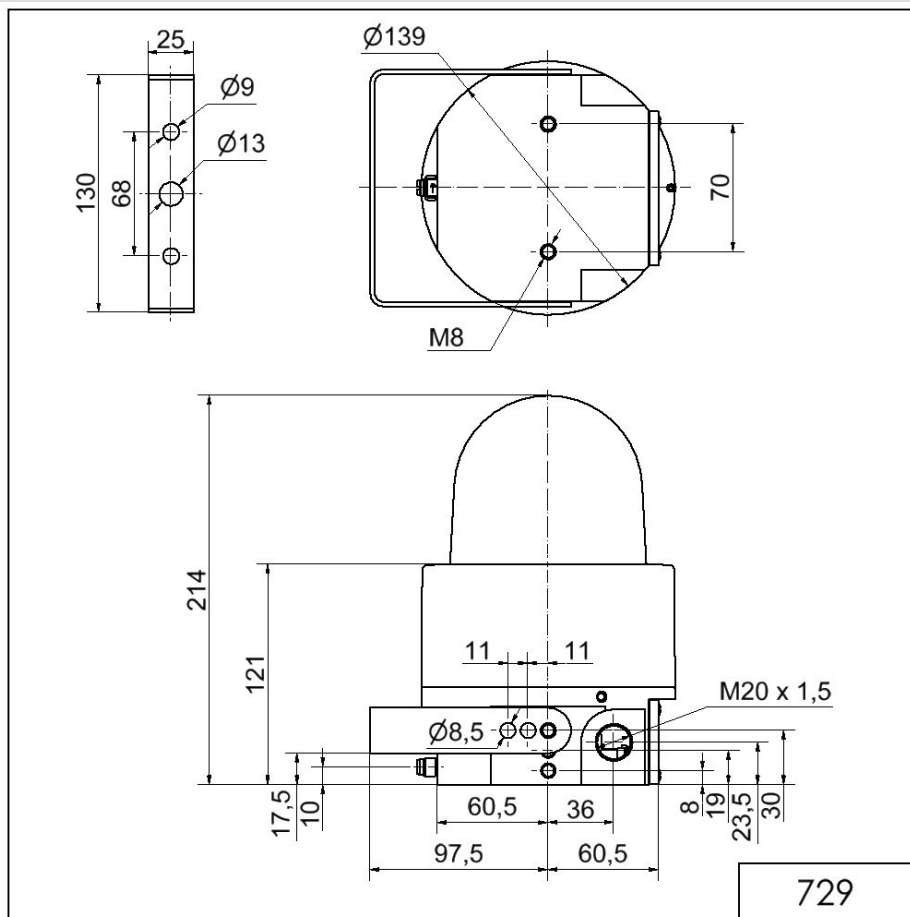

For additional installation and mounting information, refer to the appropriate user guide at www.werma.com. This printed copy is for information only and is subject to alteration.