

Ex-LED rotating beacon WM 115-230VAC RD



Part No.: 729.120.68

**MECHANICAL DATA**

Length	142 mm
Height	214 mm
Diameter	139 mm
Materials	Aluminium Glass
Dome colour	Red
Housing colour	Black
Protection category	IP66
Connection	Spring-type terminal
cross-sectional area maximum	2,50mm ² / 14AWG
Cable entry	Screwed cable gland
Cable entry minimum	d = 7 mm
Cable entry maximum	d = 13 mm
Tension relief	Cable gland (EN62444)
Type of fixing	Base mounting Wall mounting
Working temperature minimum	-40°C
Working temperature maximum	+50°C
Weight with packaging	3480 g
Product weight	3260 g

ELECTRICAL DATA

Operating voltage	115-230V
Operating voltage type	AC
Operating voltage frequency	50Hz at 230V 60Hz at 115V
Operating voltage tolerance	+/- 10%
Rated operational voltage	230 VAC
Rated operational current	150 mA
Protection class	Protection class 1
Pollution degree	3
Overvoltage category	II
Isolation voltage	Ui = 250V; Uimp = 2.500V

OPTICAL DATA

Light source	LED
Light colour	Red
Optical signal image	Revolving
Service life optical	50,000 h maximum



For additional installation and mounting information, refer to the appropriate user guide at www.werma.com. This printed copy is for information only and is subject to alteration.

Ex-LED rotating beacon WM 115-230VAC RD

Rotation speed (rpm)	180 U/min
APPROVAL DATA	
Conforms with CE	yes
WEEE	yes
Conform with ATEX-directive	yes
ATEX-guidance	2014/34/EU
Ex approval number	BVS 11 ATEX E107
Ex label for gas	II2G Ex db eb IIC T5 Gb
Ex label for dust	II2D Ex tb IIIC T95°C Db
Ex-standard	03 04 05 09
Conforms with IECEx	yes
IECEx Approval number	IECEx BVS 11.0082
Conforms with CCC	no
Conforms with FCC	no
Conforms with IC	No
Conforms with AS-I	no
ICAO Certification	No
Conforms with GL	no
Conforms with RoHS CN	no
Conforms with VdS	no



For additional installation and mounting information, refer to the appropriate user guide at www.werma.com. This printed copy is for information only and is subject to alteration.

Ex-LED rotating beacon WM 115-230VAC RD

DRAWING

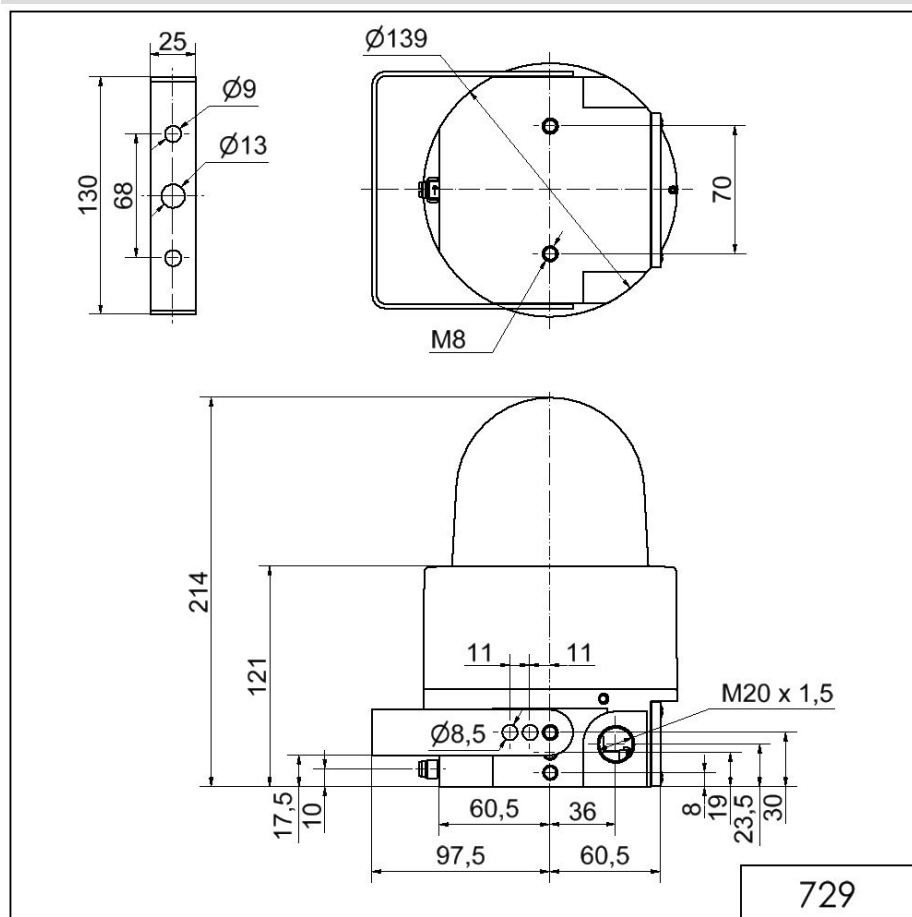

For additional installation and mounting information, refer to the appropriate user guide at www.werma.com. This printed copy is for information only and is subject to alteration.