

# Product End of Life Instructions

## HeatTag Sensor Cable Overheating Zigbee





## Potential disassembly risks

The information provided in this document assumes that the product is completely de-energized and uninstalled (refer to the instructions provided in the appropriate product manuals).

Dismantling/disassembling the product may entail hazards caused by, for example, sharp edges, chemical aggression or ejected parts.

### ⚠ WARNING

#### HAZARD DUE TO INSUFFICIENT PROTECTION

- Implement all safety measures required by the applicable regulations and by the processes used to dismantle/disassemble and dispose of the product.
- Use all necessary personal protective equipment such as gloves and goggles.

**Failure to follow these instructions can result in death or serious injury.**



## End of Life Instructions

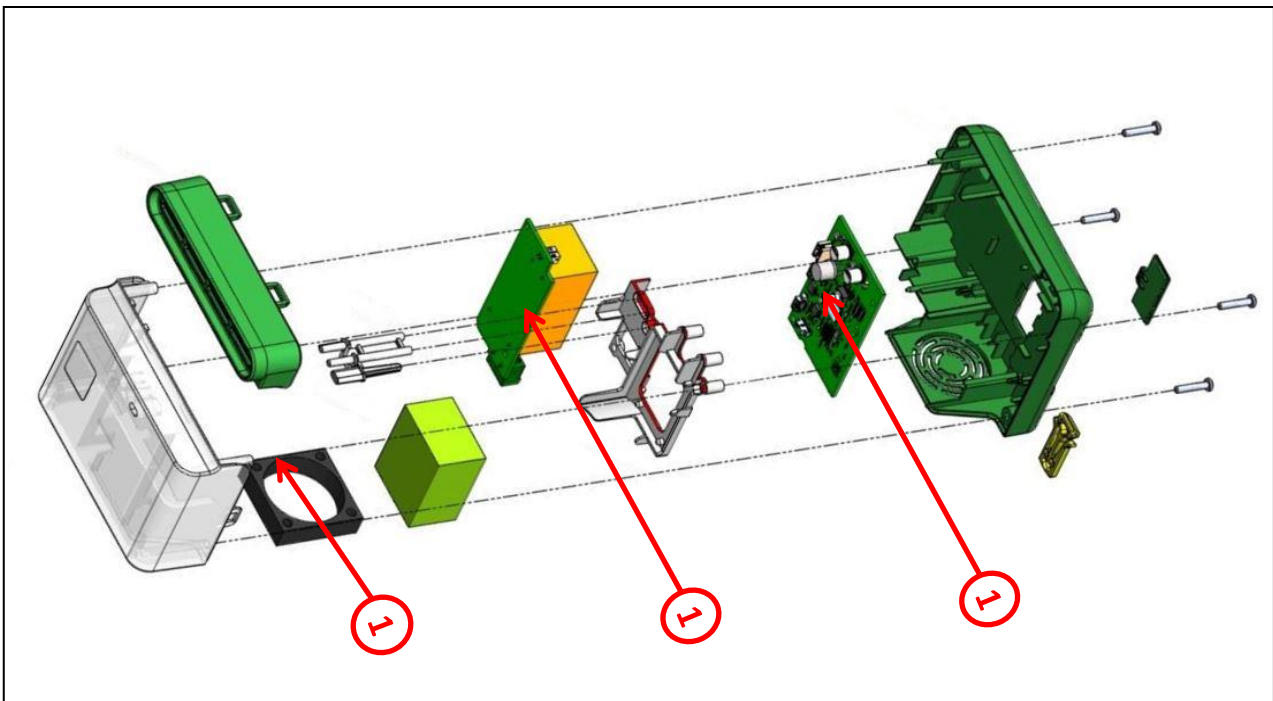

Recommendation	Number on drawing	Component / Material	Weight (in g)	Comment
To be depolluted	1	Printed Circuit Board Assembly	110.496	



## Product description

<b>Manufacturer identification</b>	Schneider Electric Industries SAS
<b>Brand name</b>	Schneider Electric
<b>Product function</b>	HeatTag is a smart sensor for early detection of overheating wire connections or overheating cables. Sends three levels of alert depending on the severity of the situation it detects To prevent electrical switchboards from being damaged, by analyzing gas and particles in the air and sending alerts before any smoke or insulator browning.
<b>Product reference</b>	SMT10020
<b>Total representative product mass</b>	256 g
<b>Representative product dimensions</b>	107mm x 108mm x 55mm
<b>Accessories</b>	No
<b>Date of information release</b>	02/2021

## Additional information

<b>Legal information</b>	This product family is in the scope of European Union directive 2012/19/EU on Waste Electrical and Electronic Equipment (WEEE). The product family must be disposed according to the legislation of the country. This document is intended for use by end of life recyclers or treatment facilities. It provides the basic information to assure an appropriate end of life treatment for the components and materials of the product.	
<b>In case of special transportation: transportation method</b>	No	
<b>Recyclability potential</b>	<b>7%</b>	Based on "ECO'DEEE recyclability and recoverability calculation method" (version V1, 20 Sep. 2008 presented to the French Agency for Environment and Energy Management: ADEME).

Schneider Electric Industries SAS

Country Customer Care Center  
<http://www.schneider-electric.com/contact>

35, rue Joseph Monier

CS 30323

F- 92506 Rueil Malmaison Cedex

RCS Nanterre 954 503 439

Capital social 896 313 776 €

[www.schneider-electric.com](http://www.schneider-electric.com)

ENVEOLI2101005\_V1

Published by Schneider Electric

© 2019 - Schneider Electric – All rights reserved

02/2021