

# Vent-Axia®

## 150mm Conversion Kit – Stock Ref:- 408680

- 1) MARK OUT HOLES USING THE METAL PLATE AS A TEMPLATE: MARK OUT THE FOUR OUTER HOLES THAT WILL BE USED TO SCREW THE PLATE TO THE WALL, AND MARK THE INNER FOUR HOLES TO ALLOW CLEARANCE FOR THE FAN TO SCREW TO THE METAL PLATE.
- 2) DRILL HOLES SUITABLE FOR THE FIXINGS TO BE USED. (PLEASE NOTE THAT THE INNER FOUR HOLES ARE ONLY FOR CLEARANCE AND MAY BE PART OF THE 150MM CORE FOR THE SPIGOT AND THEREFORE DO NOT REQUIRE DRILLING).
- 3) SCREW THE METAL PLATE TO THE WALL USING SUITABLE FIXINGS.
- 4) SANDWICH THE PLASTIC 150MM CONVERSION SURROUND (& FOAM GASKET IF REQUIRED) BETWEEN THE METAL PLATE AND FAN (REMOVE FAN GRILLE TO ACCESS SCREW HOLES).
- 5) USE THE SUPPLIED METAL CUTTING SCREWS TO SCREW THE FAN TO THE METAL PLATE. ENSURE THE SCREWS ARE NOT OVER TIGHTENED CAUSING THE PLASTIC SURROUND OR FAN TO DISTORT.
- 6) REPLACE FAN GRILLE.

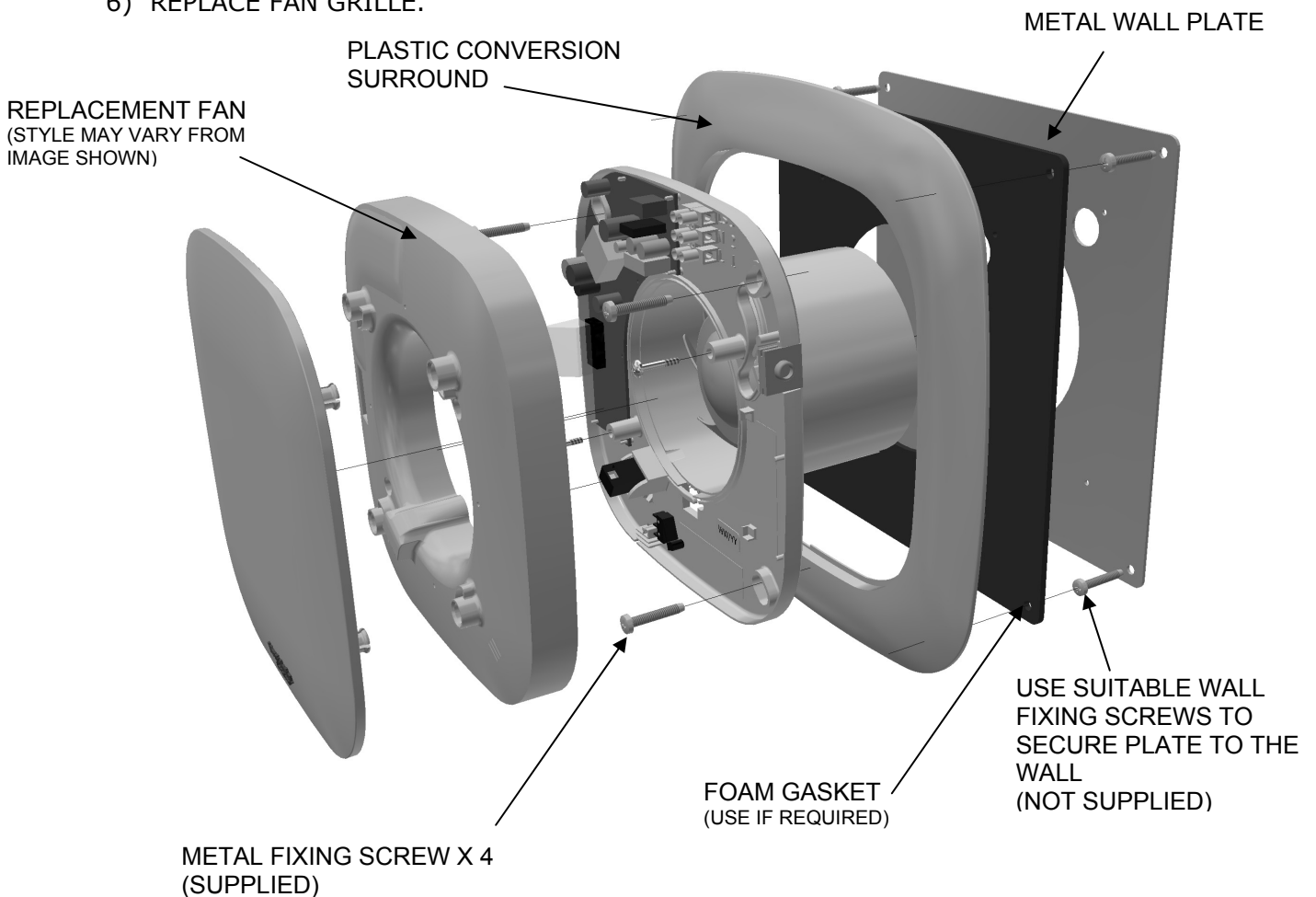

## Vent-Axia®

Head Office: Fleming Way, Crawley, West Sussex, RH10 9YX. Tel: 01293 526062 Fax: 01293 551188

**UK NATIONAL CALL CENTRE**, Newton Road, Crawley, West Sussex, RH10 9JA

SALES ENQUIRIES:  
TECHNICAL SUPPORT:  
Web:-[www.vent-axia.com](http://www.vent-axia.com)

Tel: 0844 8560590 Fax: 01293 565169  
Tel: 0844 8560594 Fax: 01293 539209  
Email:- [info@vent-axia.com](mailto:info@vent-axia.com)

As part of the policy of continuous product improvement Vent-Axia reserves the right to alter specifications without notice.