



## Highbay EcoMax G3

- Rendabele highbay-oplossing
- Elegant, slank ontwerp
- Reflectoren, beugel en IP68 connector verkrijgbaar als accessoires



## Specificaties

Artikelcode	Artikelomschrijving	Equivalent (W)	Vermogen (W)	Lumen	Efficiëntie (lm/W)	CCT (K)	Bundelhoek	Gewicht (kg/st)
<b>Statisch</b>								
545001071600	LEDHighbay-E3 70W-840-W	HID 250W	70	10850	155	4000	90	1.74
545001071800	LEDHighbay-E3 70W-857-W	HID 250W	70	10850	155	5700	90	1.74
545001072000	LEDHighbay-E3 110W-840-W	HID 400W	110	17050	155	4000	90	2.41
545001072200	LEDHighbay-E3 110W-857-W	HID 400W	110	17050	155	5700	90	2.41
545001072400	LEDHighbay-E3 140W-840-W	HID 400W	140	21700	155	4000	90	2.41
545001072600	LEDHighbay-E3 140W-857-W	HID 400W	140	21700	155	5700	90	2.41
545001072700	LEDHighbay-E3 180W-840-N	HID 400W HO	180	27900	155	4000	65	3.34
545001072800	LEDHighbay-E3 180W-840-W	HID 400W HO	180	27900	155	4000	90	3.34
545001073000	LEDHighbay-E3 180W-857-W	HID 400W HO	180	27900	155	5700	90	3.34
545001073100	LEDHighbay-E3 220W-840-N	HID 600W	220	34100	155	4000	65	3.34
545001073200	LEDHighbay-E3 220W-840-W	HID 600W	220	34100	155	4000	90	3.34
545001073400	LEDHighbay-E3 220W-857-W	HID 600W	220	34100	155	5700	90	3.34

## Accessoires



545098006100  
LEDHighbay-E2 Reflector-  
Rd407



545098006200  
LEDHighbay-E2 Reflector-  
Rd507



545098006300  
LEDHighbay-E2 Reflector-  
Rd602



545098006000  
LEDHighbay-E2 Bracket-L249



543098021900  
LEDFixture-IP68-Connector-  
Kit-3

**5 JAAR GARANTIE**



Technische specificaties	
Levensduur (L70)	70.000 u
Levensduur (L80)	50.000 u
Aan-/Uit-cycli	100.000
Kleurconsistentie (SDCM)	4
Dimbaarheid	On-Off
Afwerking	Grijs Pantone 417U
CRI	> 80
Beschermingsgraad (IP)	IP65
Slagvastheid	IK08
Beschermingsklasse	I
Risicogroep (EN 62471)	RG1
Voorschakelapparaat inbegrepen	Ja
Gloeidraadtest	850°C
Vermogensfactor	≥ 0,9
Piekspanning beveiliging	4 kV

Elektrische aansluiting	
Frequentie	50/60 Hz
Nom. spanning	220-240 V
DC ingangsspanning	Nee
230V Kabellengte	1 m

Materiaal eigenschappen	
Materiaal behuizing	Aluminium
Materiaal optiek	Polycarbonaat
Cover materiaal	Polycarbonaat

Toepassingscondities	
Bedrijfstemperatuur	-30-+50°C
Gebruikstemperatuur	+25°C
Opslagtemperatuur	-30-+50°C

## Maatschets (mm)

LEDHighbay-E2 70W

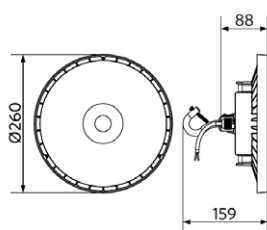

LEDHighbay-E2  
110W & 140W

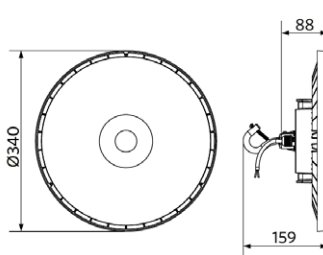

LEDHighbay-E2  
180W & 220W

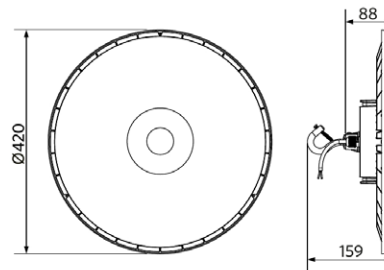

LEDHighbay-E2  
Reflector-Rd407

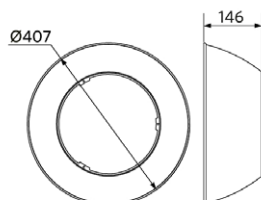

LEDHighbay-E2  
Reflector-Rd507

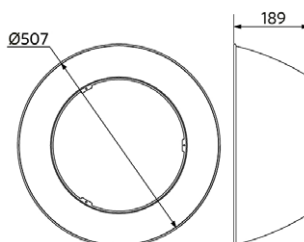

LEDHighbay-E2  
Reflector-Rd602

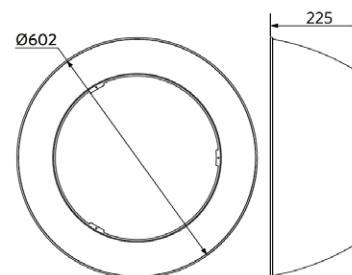

LEDHighbay-E2  
Bracket

