



Suspended Halo

- Stylish, slim round luminaire for suspended and surface mounted applications
- Three refined sizes: 400 mm, 600 mm, and 800 mm diameter



Specifications

Item Code	Item Description	Equivalent to (W)	Power (W)	Lumen (lm)	Efficacy (lm/W)	Efficacy (lm/W)	CCT (K)	Sensor	Net Weight (kg/pc)
DALI2									
520036049200	LEDHalo-P Rd400-DALI-20W-830/840-D/I-U19	TL 1x35W	20	2300		115	3K/4K	False	4

Accessories



520098005300
LEDHalo-P-Canopy



520098005400
LEDHalo-P-Surface-Mounted-Kit-S

Packaging information

Item			Box			
Item Code	Item Description	EU HS Code	Dimensions (mm) (LxWxH)	Gross Weight (kg/pc)	EAN	pc/box
520036049200	LEDHalo-P Rd400-DALI-20W-830/840-D/I-U19	94051190	440x440x120	4.25	6937209634467	1
542098001000	LEDTrunking DALI Power Supply	85044083	198x54x39	0.24	6945730496614	1
520098005300	LEDHalo-P-Canopy	94059900	240x240x60	0.88	6937209634603	1
520098005400	LEDHalo-P-Surface-Mounted-Kit-S	94059900	427x427x51	0.33	6937209634610	1

Technical Specifications

Lifetime (L70)	100,000 h
Lifetime (L80)	70,000 h
On-/Off-cycles	100,000
Colour consistency (SDCM)	4
Dimmability	DALI2
Sensor type	No sensor
Sensor technology	-
Beam angle	120° up / 90° down
Finishing	White RAL9003
Colour rendering index (CRI)	> 80
UGR	19
Ingress protection front side (IP)	IP20
Impact strength (IK)	IK03
Protection class	I
Risk group (EN 62471)	RG0
With control gear	True
Glow wire test	650 °C
Driver failure rate (at 5,000 hrs)	≤ 1 %
Power factor	≥ 0.9

Electrical Supply

Frequency	50 - 60 Hz
Nominal voltage	180 - 280 V
DC input voltage	See catalogue appendix Connection Specifications

Mechanical Properties

Housing material	Aluminium
Cover material	PMMA

Ambient Conditions

Operating temperature	-10 ~ 45 °C
Application temperature	25 °C
Storage environment	-25 ~ 50 °C



Dimensional Drawing (mm)

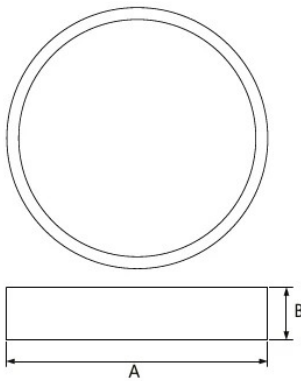

Type	A	B
Rd400	400	80
Rd600	600	80
Rd800	800	80

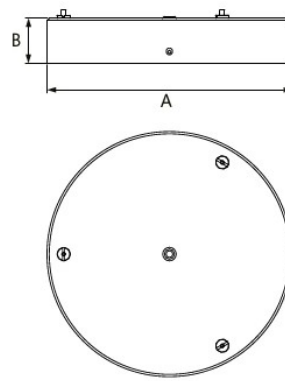

Type	A	B
Canopy 220	220	40