

A hand holding a smartphone with a blue overlay. The phone screen shows a grid of icons, likely an app drawer or home screen. The background is dark, and the overall color scheme is monochromatic blue.

Opple Light Master (IV) *User Manual*

10/2024

1. Download the Opple Smart app in the Appstore/Playstore

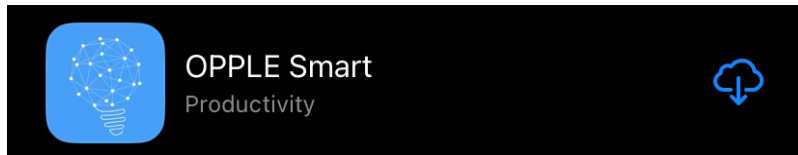

2. Create an account and login

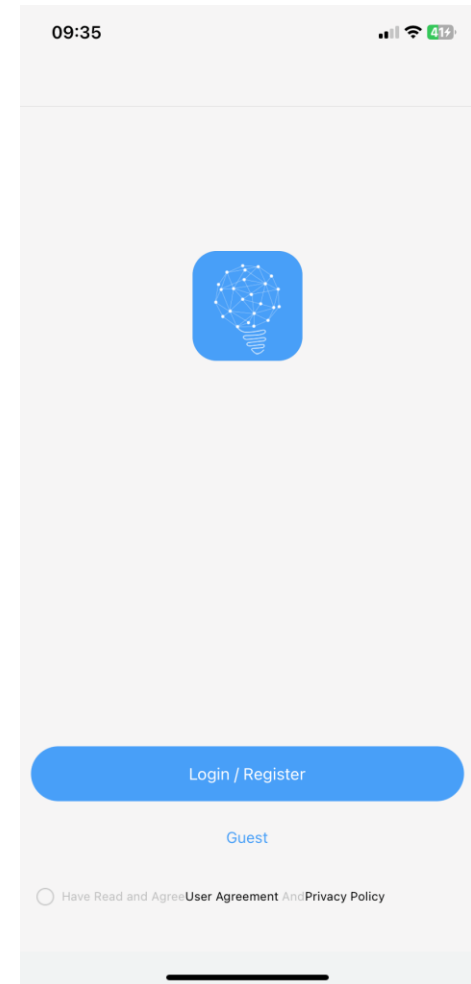

STEPS WITHOUT A SMART PROJECT

3. Open the toolbox icon

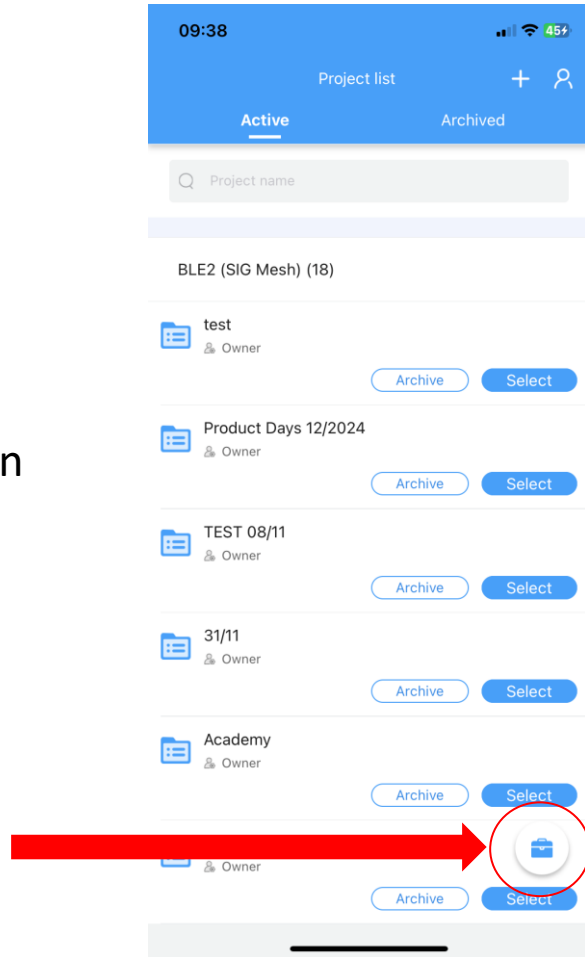

4. Select Light Master

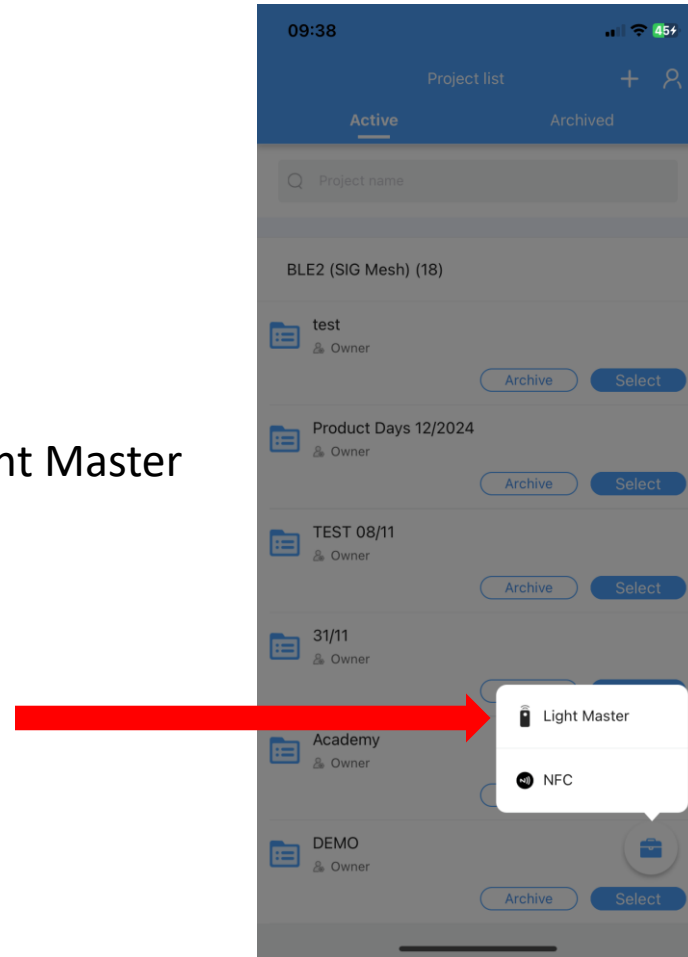

STEPS WHILE ALREADY IN A SMART PROJECT

1. Go to “more” and select “Light Master”

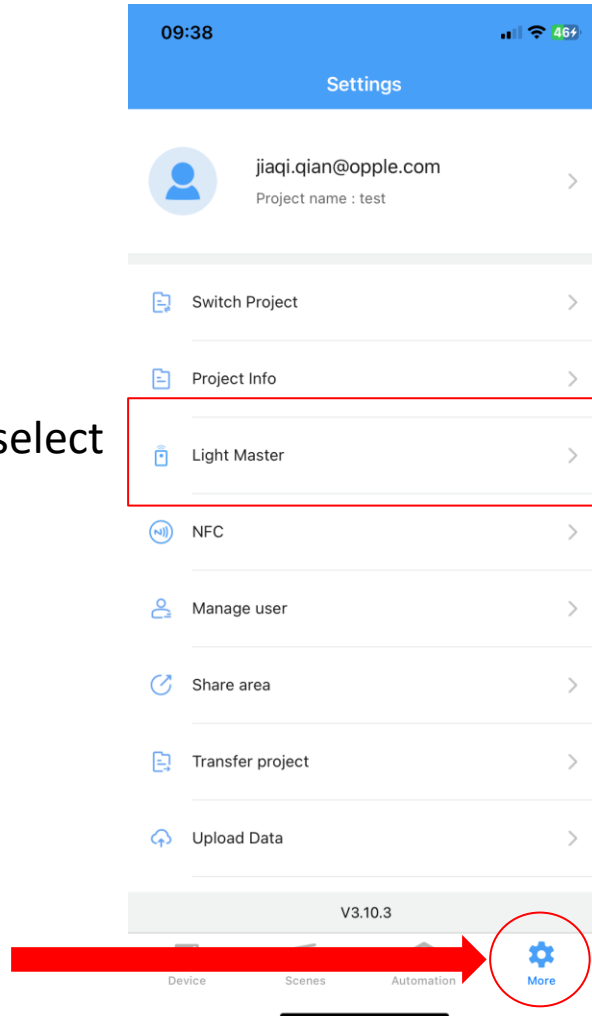

2. Go to the add button and make sure the Bluetooth is on

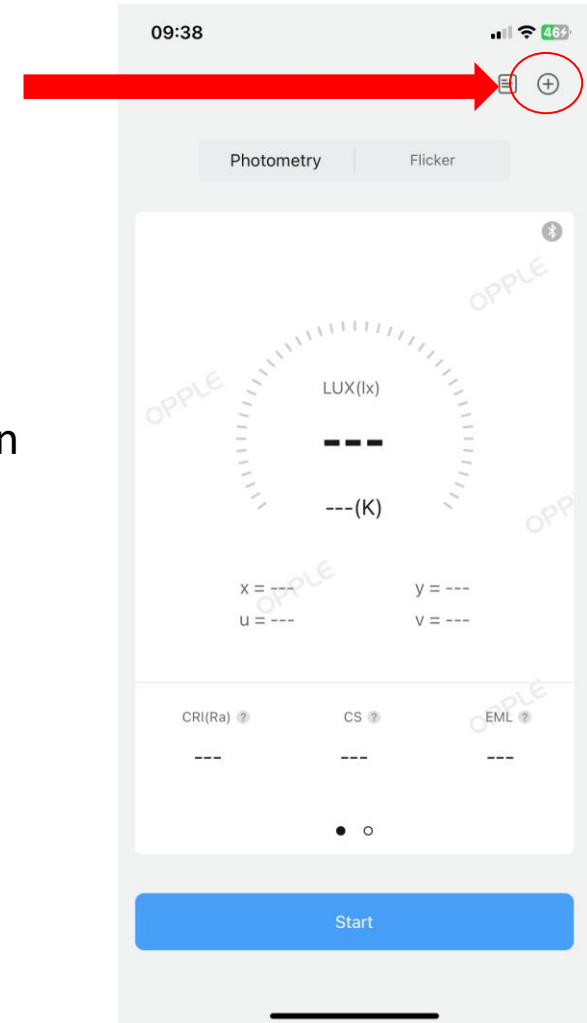

3. Make sure to enable location permission

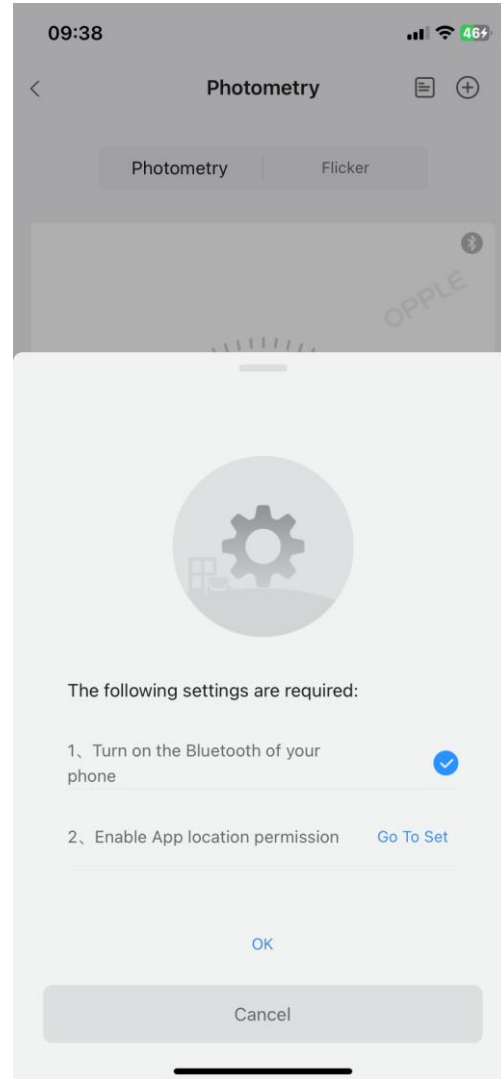

4. Follow the on-screen instruction

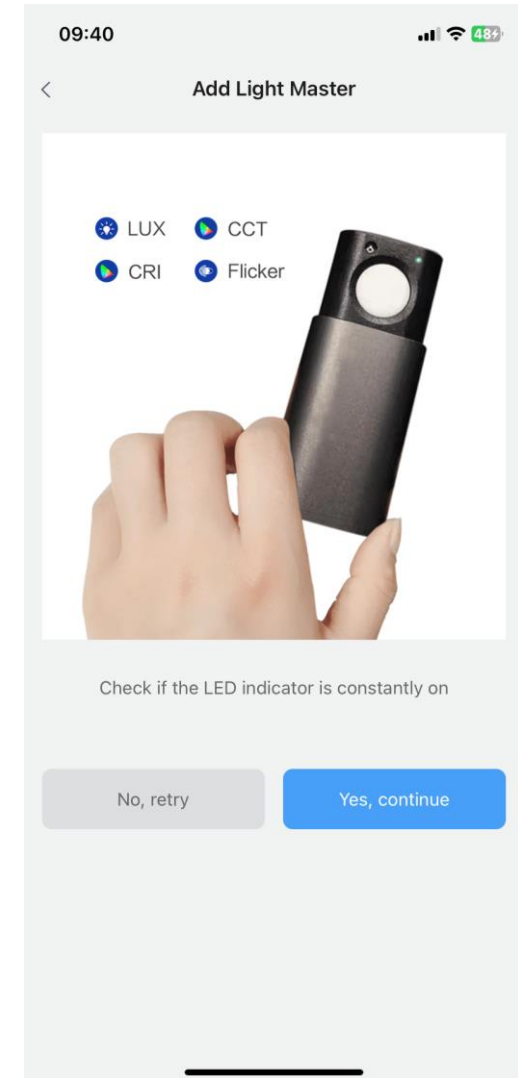

STEPS WHILE ALREADY IN A SMART PROJECT

5. Start measuring with the Light Master

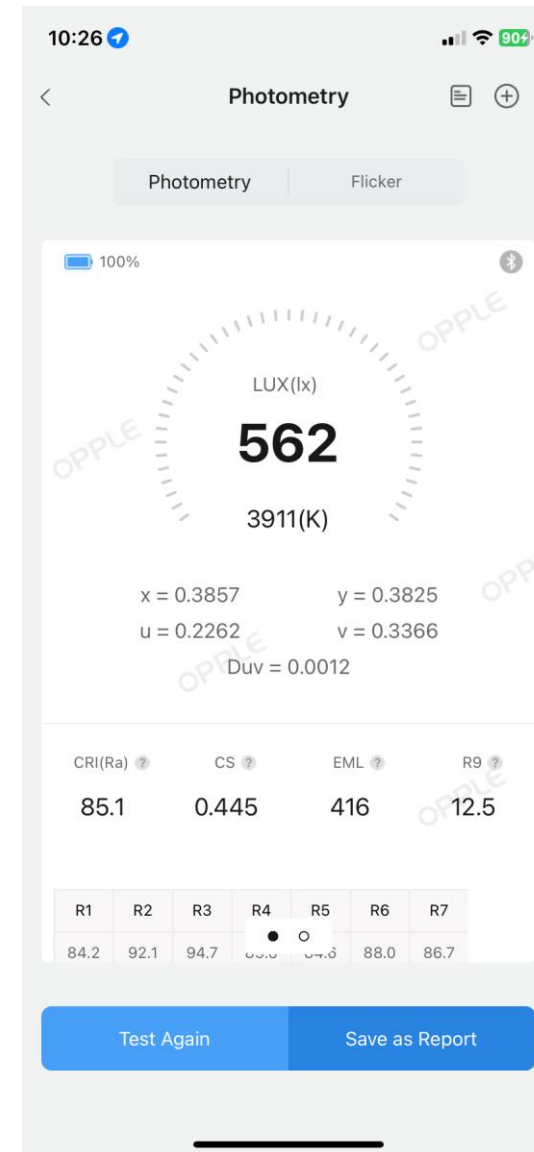
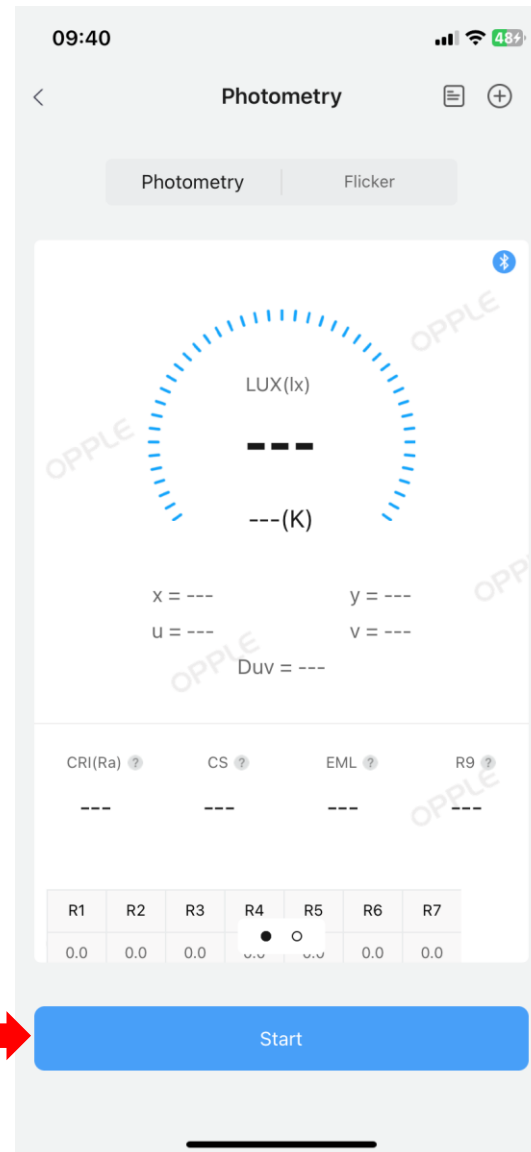

OPPLE
LIGHTING.



OPPLE Lighting Europe | T: +31 (0)88 056 7888 | E: service@opple.com | Meerenakkerweg 1-07, 5652 AR Eindhoven, The Netherlands | OPPLE.COM