



Suspended Halo

- Stylish, slim round luminaire for suspended and surface mounted applications
- Three refined sizes: 400 mm, 600 mm, and 800 mm diameter



Specifications

Item Code	Item Description	Equivalent to (W)	Power (W)	Lumen (lm)	Efficacy (lm/W)	Efficacy (lm/W)	CCT (K)	Sensor	Net Weight (kg/pc)
Tunable White/Smart									
520036050200	LEDHalo-P Rd600-BLE2-40W-TW-D/I-U19	TL 1x80W	40	5000		125	2.7K-6.5K	False	5.8

Accessories



520098005300
LEDHalo-P-Canopy

Packaging information

Item			Box			
Item Code	Item Description	EU HS Code	Dimensions (mm) (LxWxH)	Gross Weight (kg/pc)	EAN	pc/box
520036050200	LEDHalo-P Rd600-BLE2-40W-TW-D/I-U19	94051190	640x640x120	6.05	6937209634566	1
821006001800	LEDSmart-BLE2-Rc-MW-Sensor	85365005	100x100x130	0.19	6941497778277	1
821006002000	LEDSmart-BLE2-Rc-PIR-Sensor	85365005	100x100x70	0.19	6941497778260	1
821009000200	LEDSmart-BLE2-Switch	85365005	89x101x21	0.10	6941497778253	1
821017003000	LEDSmart-BLE2-10V-Converter	94059200	90x42x30	0.09	6931783007624	1
821017003200	LEDSmart-BLE2-DALI-Converter	94059200	90x42x30	0.08	6931783007617	1
821017003400	LEDSmart-BLE2-Multi-Switch-Module	94059200	46x46x50	0.07	6931783007600	1
821017003600	LEDSmart-BLE2-Relay-250W-DIM	94059200	90x42x30	0.09	6931783007594	1
821017003800	LEDSmart-BLE2-Relay-1000W	85364900	110x57x37	0.10	6941497778284	1
822008000200	LEDSmart-BLE2-Light-Wizard	85365005	143x113x55	0.26	6941491779782	1
822008000800	LEDSmart-BLE2-DALI-Connect-Box G2	85176200	112x112x34	0.30	6941491794044	1
520098005300	LEDHalo-P-Canopy	94059900	240x240x60	0.88	6937209634603	1
520098005500	LEDHalo-P-Surface-Mounted-Kit-M	94059900	627x627x51	0.44	6937209634627	1

Technical Specifications

Lifetime (L70)	100,000 h
Lifetime (L80)	70,000 h
On-/Off-cycles	100,000
Colour consistency (SDCM)	4
Dimmability	BLE2
Sensor type	No sensor
Sensor technology	-
Beam angle	120° up / 90° down
Finishing	White RAL9003
Colour rendering index (CRI)	> 80
UGR	19
Ingress protection front side (IP)	IP20
Impact strength (IK)	IK03
Protection class	I
Risk group (EN 62471)	RG0
With control gear	True
Glow wire test	650 °C
Driver failure rate (at 5,000 hrs)	≤ 1 %
Power factor	≥ 0.9

Electrical Supply

Frequency	50 - 60 Hz
Nominal voltage	180 - 280 V
DC input voltage	See catalogue appendix Connection Specifications

Mechanical Properties

Housing material	Aluminium
Cover material	PMMA

Ambient Conditions

Operating temperature	-10 - 45 °C
Application temperature	25 °C
Storage environment	-25 - 50 °C



Dimensional Drawing (mm)

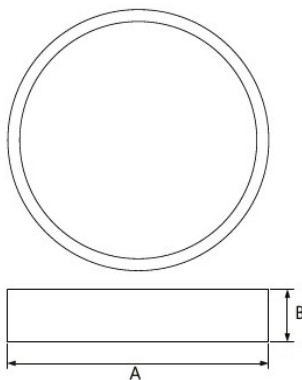

Type	A	B
Rd400	400	80
Rd600	600	80
Rd800	800	80

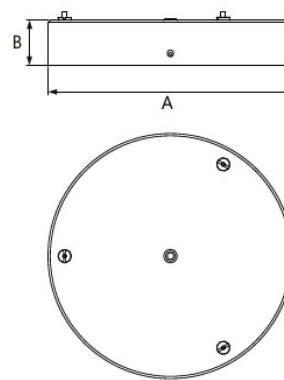

Type	A	B
Canopy 220	220	40