

Vent-Axia®

Econiq Floor Mounting kit

Original instruction, Installation

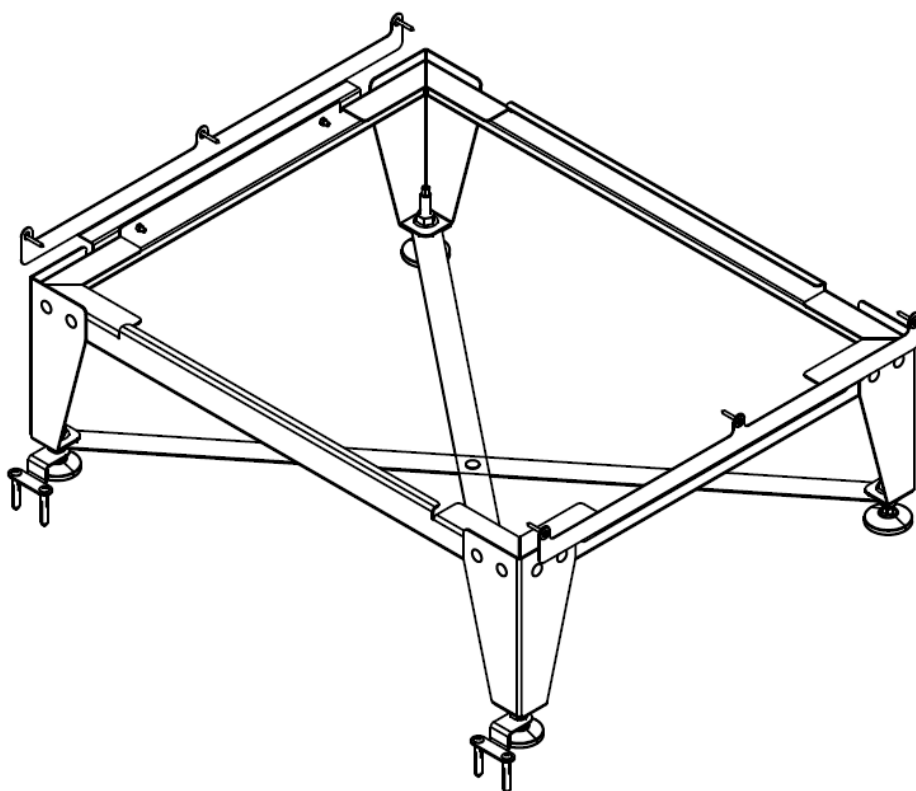

Stock Ref. N°

414122 - Floor Mount Kit



**PLEASE READ THESE INSTRUCTIONS CAREFULLY
BEFORE COMMENCING INSTALLATION.**

**PLEASE REFER TO ACCOMPANYING DOCUMENTATION
FOR INFORMATION SPECIFIC TO YOUR UNIT.
PLEASE RETAIN THESE INSTRUCTIONS WITH THE
PRODUCT.**

**UK
CA
CE**

Kit Contents

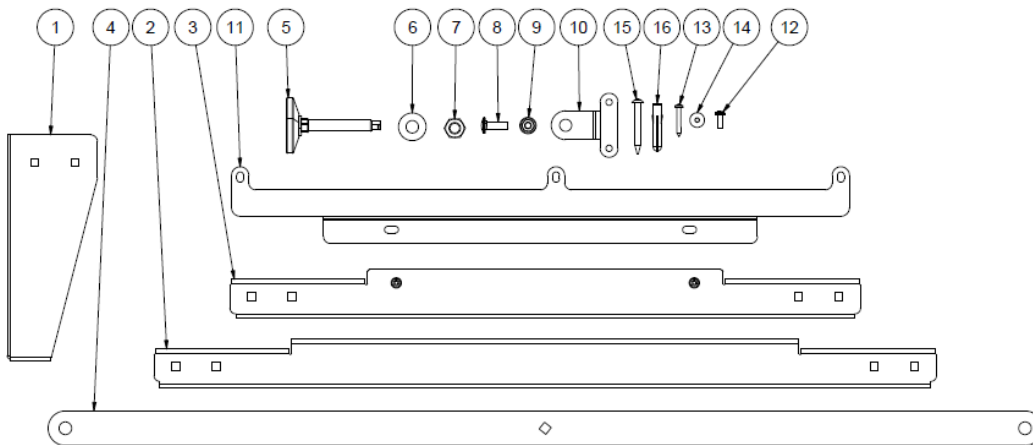

Floor Stand Parts List		
Item	Description	Qty
1	LEG	4
2	LONG RAIL	2
3	SHORT RAIL	2
4	TIE BAR	2
5	FOOT	4
6	WASHER LARGE	8
7	NUT M10	8
8	COACH BOLT M6	17
9	NUT M6	17
10	FOOT CLAMP	2
11	SIDE BRACKET	2
12	SCREW M4	4
13	SCREW SELF TAP SMALL	6
14	WASHER SMALL	6
15	SCREW SELF TAP LARGE	4
16	WALLPLUG	4

Bracket Set Assembled

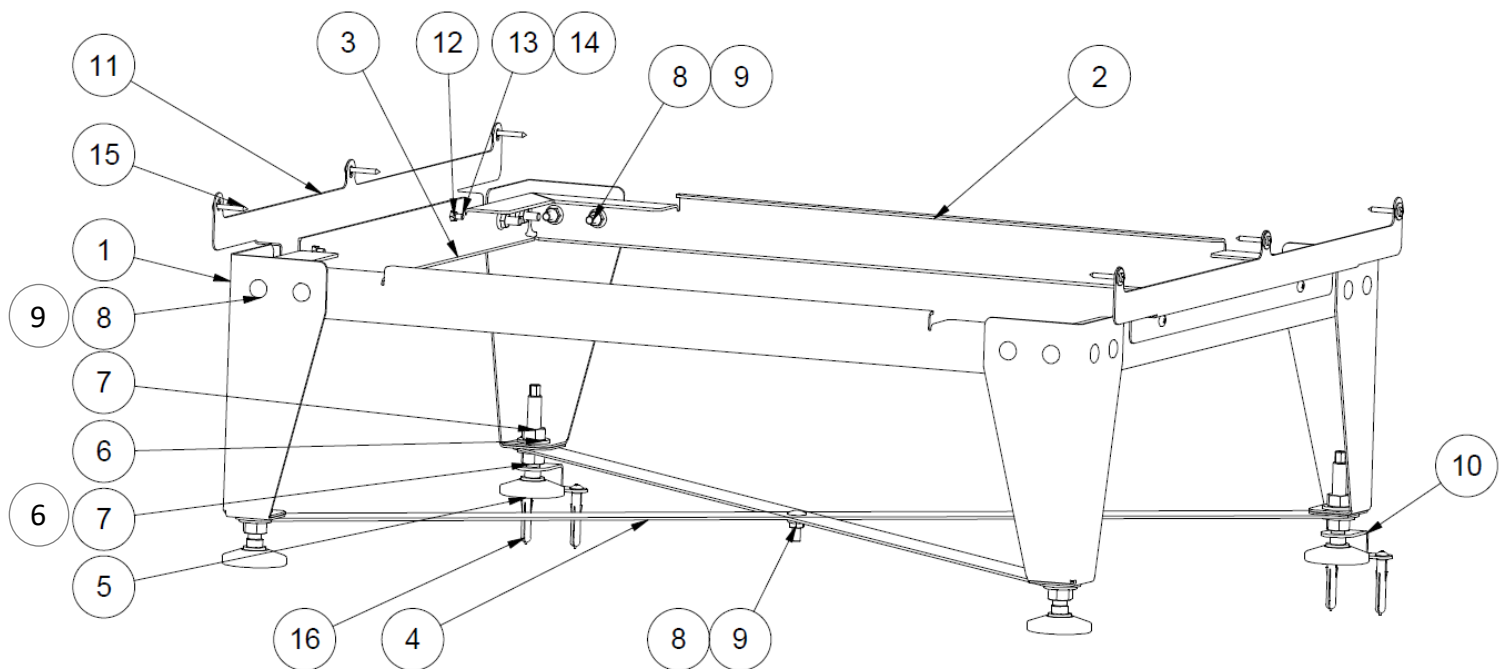

When installing the Econiq MVHR base unit on the floor stand, refer to the Econiq instruction leaflet for details on unit weights.

Ensure the floor structure is capable of supporting the weight before installation.

Typical Installation

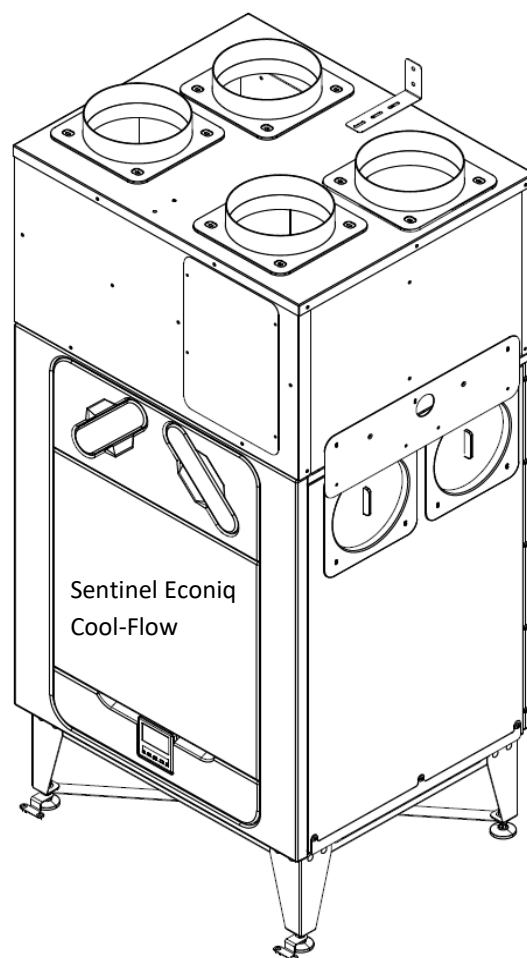
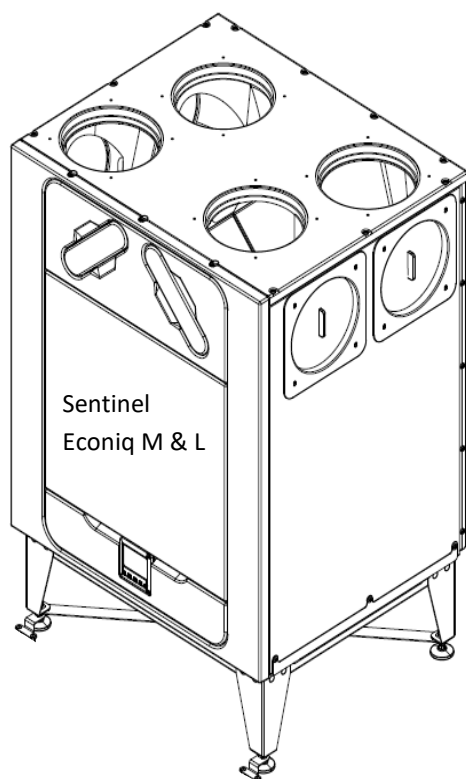

1

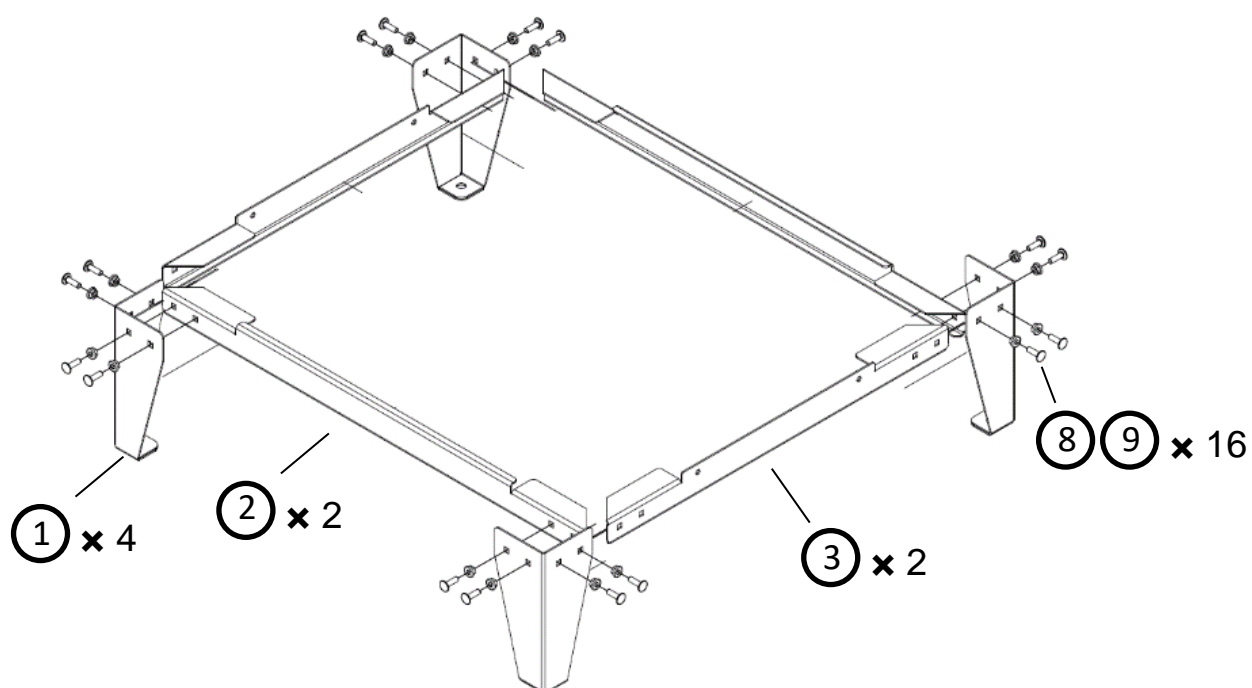

Connect the legs (Item 1), long rails (Item 2) and short rails (Item 3) with the coach bolts M6 (Item 8), nuts M6 (Item 9) as indicated.

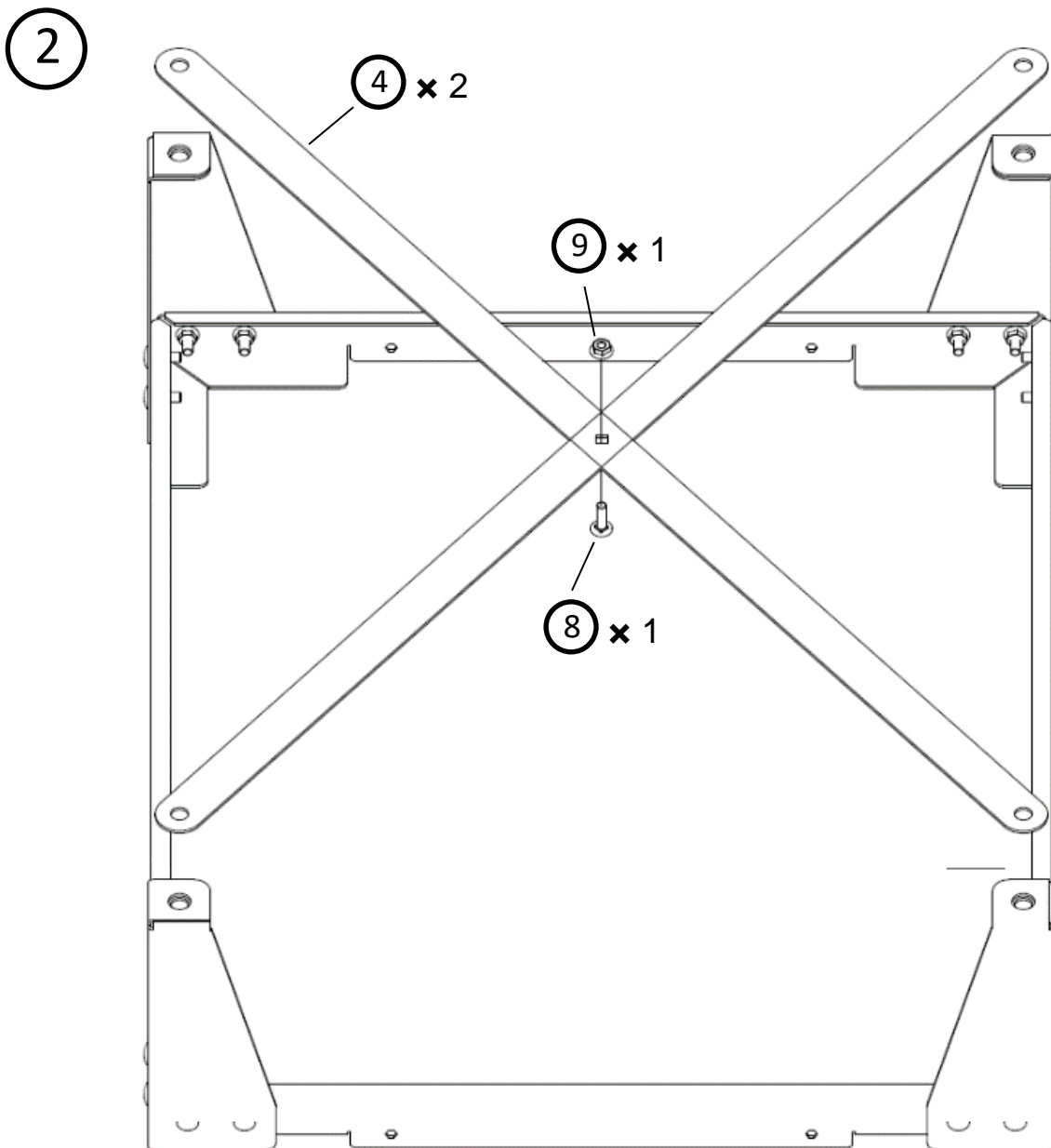

Turn the part assembled kit over and align tie bars (Item 4) with each foot bolt hole as indicated and secure the centre of the tie bars (Item 4) the coach bolts M6 (Item 8), nuts M6 (Item 9) as indicated.

3

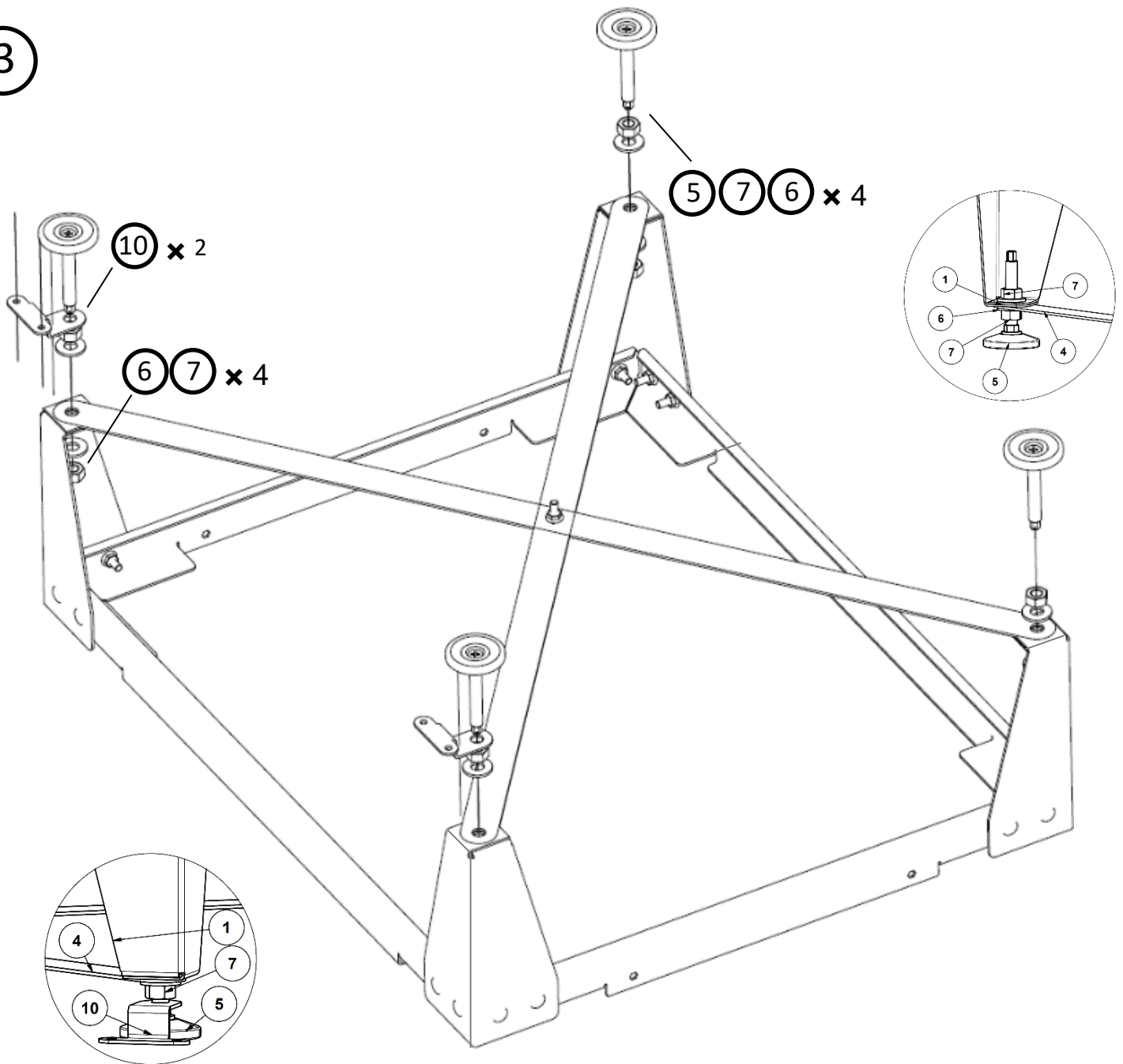

Thread each foot (Item 5) through the nuts M10 (Item 7), washers large (Item 6), tie bars (Item 4) and Legs (Item 1) then again washers large (Item 6) and nuts M10 (Item 7) as shown in the image.

Note : On the front legs insert foot clamps (Item 10) before the first M10 Nut (Item 7) is fitted as shown.

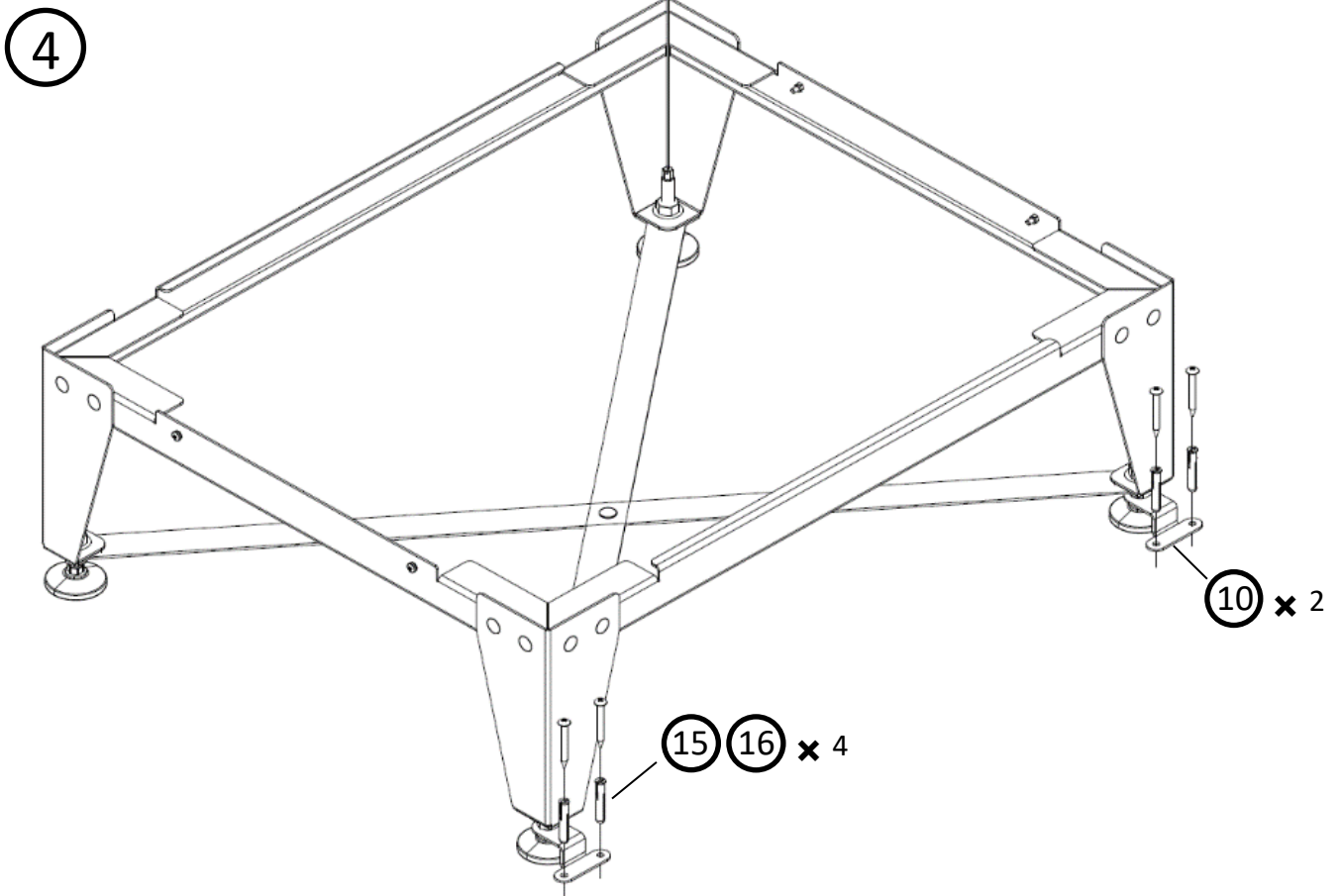

Secure the assembled Floor Mounting Kit on the ground with the foot clamps (Item 10), self tapping screws (Item 15) & wall plugs (Item 16). Use nut positions on each foot to level the floor mount assembly.

5

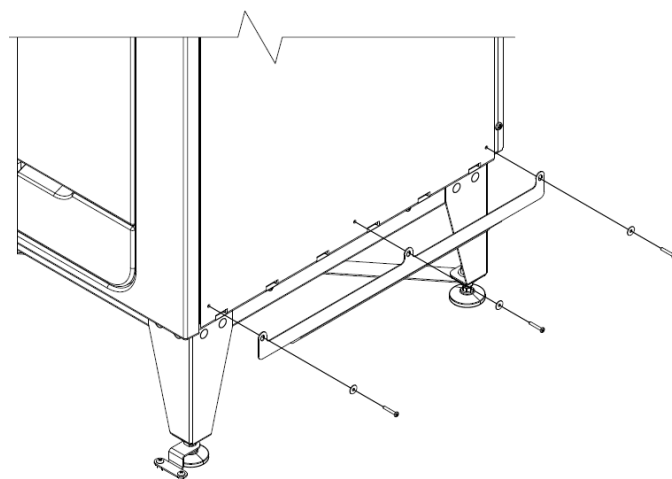
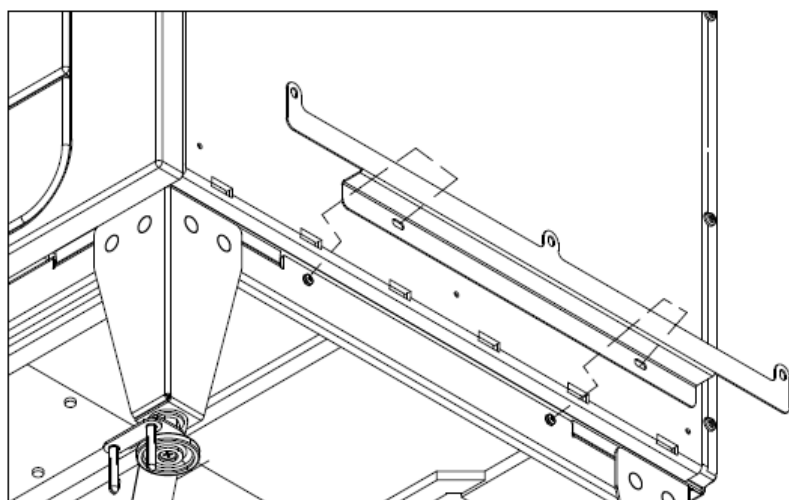
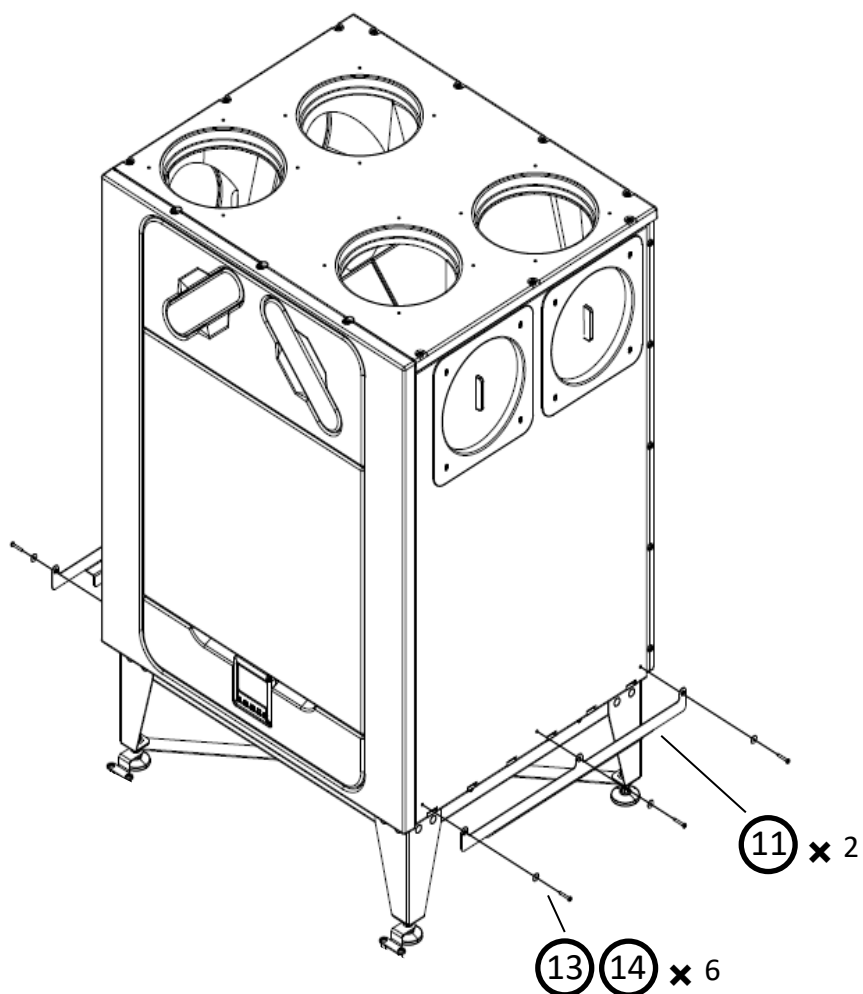

Attach the side brackets to the stand by first unscrewing the pre-fitted Screws M4 (Item 12) on the Short rails (Item 3) as shown.

Then, reattach these Screws M4 (Item 12) through the side brackets (Item 11) as shown.

Once done, secure to the unit using Self Tapping Screws Small (Item 13) along with Washers (Item 14).

Vent-Axia.

UK Head Office:

Vent-Axia, Fleming Way, Crawley, West Sussex, RH10 9YX

EU Authorised Representative: Vent-Axia Sigarenmaker 5 - 5521DJ Eersel Nederland authorisedrep@vent-axia.nl

CALL CENTRE: -

Sales Enquiries:	Tel: 0344 8560590	Email: sales@vent-axia.com
Technical Support:	Tel: 0344 8560594	Email: tech@vent-axia.com

415225 A

1024